

CERTIFICATE OF SURVEY.

STATE OF WISCONSIN,
ADAMS COUNTY.

ss. M. G. Smith

Surveyor, in and for the County and State of Wisconsin

hereby certify that I have surveyed and subdivided Section 18 Township 17 North of Range 7 East of Principal Meridian, as represented by the courses and distances on the following plat, and annexed field-notes of survey:

Established all quarter-quarter corners upon the section boundary at proportional distances between known section and quarter corners, according to the original field-notes of the Government survey.

Established all lost corners at proportionate distances between known corners, according to original field-notes of the Government survey.

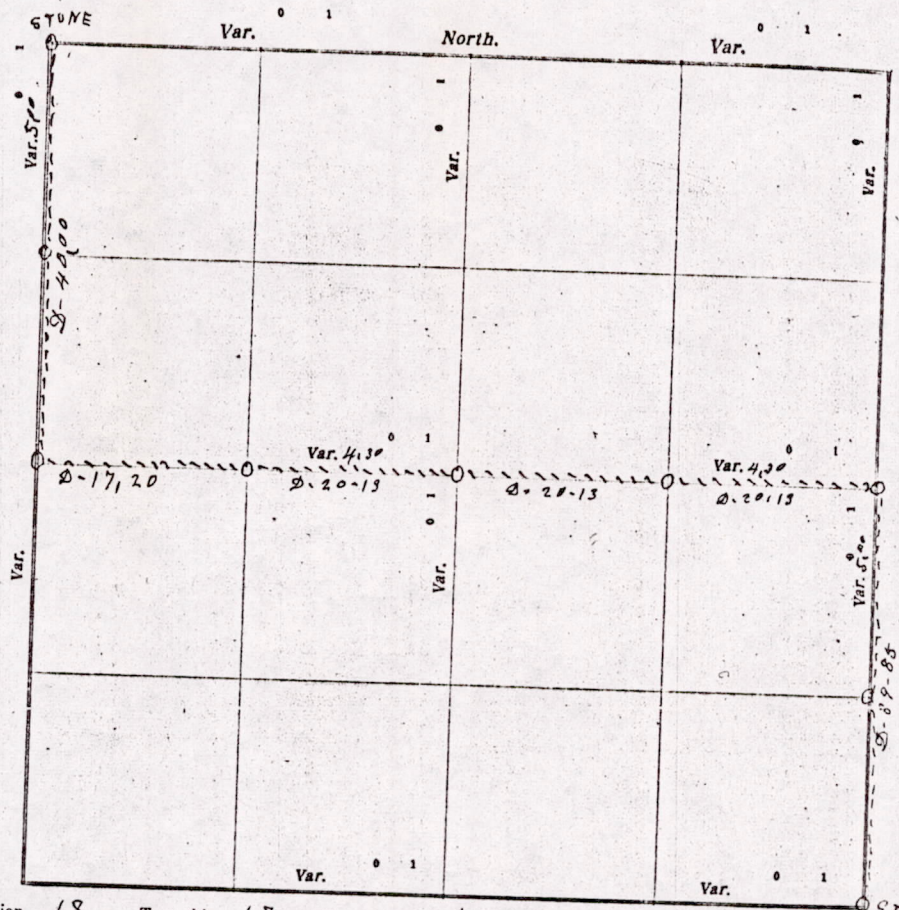

Plat of Section 18, Township 17 North, Range 7 East of 4th Principal Meridian. Scale, 80 chains to 1 inch. The figures in red ink are the lengths of the lines as stated in the field-notes of the Government survey.

Declination of the Magnetic Meridian from the True Meridian _____ East.

Surveyed and subdivided Oct 27

A. D. 1906, in accordance with the State Laws and Instructions of

the Commissioner of the General Land Office, and recorded on pages _____ of Register in the County Surveyor's office.

WITNESS my hand this 27th day of October A. D. 1906.

M. G. Smith County Surveyor.

The above work was done at the request of John Jarosh

DESCRIPTION of Section, Quarter Section and Quarter-quarter Section Corners of Section
 Township _____ North, Range _____ East of _____ Principal Meridian.

N. B. — The variation of needle adopted in establishing corners is _____

County and State aforesaid, do
 East of _____
 Section and quarter section
 of the Government survey:



Government Corners		Bearing Trees	In. dis.	Courses they bear	Links Distant	Bearing Trees	In. dis.	Courses they bear	Links Distant
No.									
1	N. W. Sec. cor. Identified								
2	N. E. Sec. cor. Identified								
3	S. E. Sec. cor. Identified								
4	S. W. Sec. cor. Identified								
5	N. $\frac{1}{4}$ Sec. cor. Identified								
6	E. $\frac{1}{4}$ Sec. cor. Identified								
7	S. $\frac{1}{4}$ Sec. cor. Identified								
8	W. $\frac{1}{4}$ Sec. cor. Identified								
SUBDIVISION CORNERS.									
1	Center $\frac{1}{4}$ Sec. cor.								
2	North $\frac{1}{4}$ - $\frac{1}{4}$ s N. W. qr.								
3	East $\frac{1}{4}$ - $\frac{1}{4}$ s N. W. qr.								
4	South $\frac{1}{4}$ - $\frac{1}{4}$ s N. W. qr.								
5	West $\frac{1}{4}$ - $\frac{1}{4}$ s N. W. qr.								
6	Center $\frac{1}{4}$ - $\frac{1}{4}$ s N. W. qr.								
7	North $\frac{1}{4}$ - $\frac{1}{4}$ s N. E. qr.								
8	East $\frac{1}{4}$ - $\frac{1}{4}$ s N. E. qr.								
9	South $\frac{1}{4}$ - $\frac{1}{4}$ s N. E. qr.								
10	Center $\frac{1}{4}$ - $\frac{1}{4}$ s N. E. qr.								
11	East $\frac{1}{4}$ - $\frac{1}{4}$ s S. E. qr.								
12	South $\frac{1}{4}$ - $\frac{1}{4}$ s S. E. qr.								
13	West $\frac{1}{4}$ - $\frac{1}{4}$ s S. E. qr.								
14	Center $\frac{1}{4}$ - $\frac{1}{4}$ s S. E. qr.								
15	South $\frac{1}{4}$ - $\frac{1}{4}$ s S. W. qr.								
16	West $\frac{1}{4}$ - $\frac{1}{4}$ s S. W. qr.								
17	Center $\frac{1}{4}$ - $\frac{1}{4}$ s S. W. qr.								

NAMES OF SWORN ASSISTANTS.

CHAINMEN	FLAGMEN	AXMEN
B. J. Garosh John Mahan		

MINUTES.

Commencing at the Identified Northwest corner of section 18-2-17-R-7-C
 and ran south at a variation of 6-D-V, 40 chains to the quarter Post on the
 west side of the section. Then east at 4,30 D-V 17 chains & 20 links and set
 Post of the fractional forty. Then east on said quarter line, 60 chains & 39
 links to the quarter Post on the east side of the section, said quarter Post was
 proven by running from store at the southeast corner of the section
 the distance of each of the three parties on this quarter line is 40 chains
 and 18 links as shown on Plat.

W. C. Smith's county surveyor

M1518170700013

the Laws and Instructions of
 Surveyor's office.
 Surveyor.
 B. J. Garosh