

ADAMS COUNTY

Survey Monument Record

TYPE OF MONUMENT: Standard Harrison

STATE PLANE COORDINATES: N \_\_\_\_\_  
E \_\_\_\_\_

ELEVATION — M.S.L. DATUM: \_\_\_\_\_

THETA ANGLE: \_\_\_\_\_

FIELD BOOK: \_\_\_\_\_ PAGE \_\_\_\_\_

CORNER NO. \_\_\_\_\_

SECTION 22

TOWN 17

RANGE 7

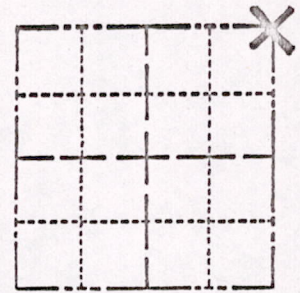

LOCATION  
(Indicated by 'X')

SEAL:

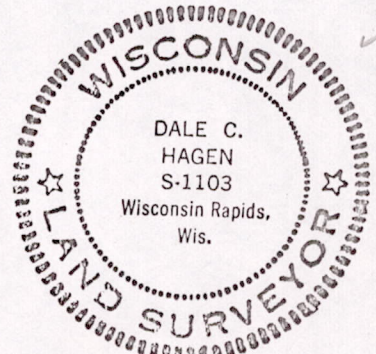

BASIS FOR MONUMENT LOCATION

(Use reverse side if necessary)

Show info such as: History of corner, with reference to Vol. and pg, dates, surveyor; exact description of monument replaced; if location computed, by taped or EDM traverse; landowner remarks, etc.

Ran EDM/transit traverse around Sections 22, 23 and 24 to determine search areas.

Excavation with backhoe by A.B. Kiedrowski, County Surveyor, yielded no evidence of the original corner or any remonumentation.

Set corner in center of Dover Avenue opposite fenceline to the North. Location fits original note and interior section subdivision of Section 23 well.

3-15-77  
GR-SS  
OK

CERTIFIED CORRECT:

*Dale C. Hagen*  
Registered Land Surveyor  
DATE: August 2, 1975

TIE SKETCH

(Show at least four ties)

NOTE: Ties in trees to nail in disc.

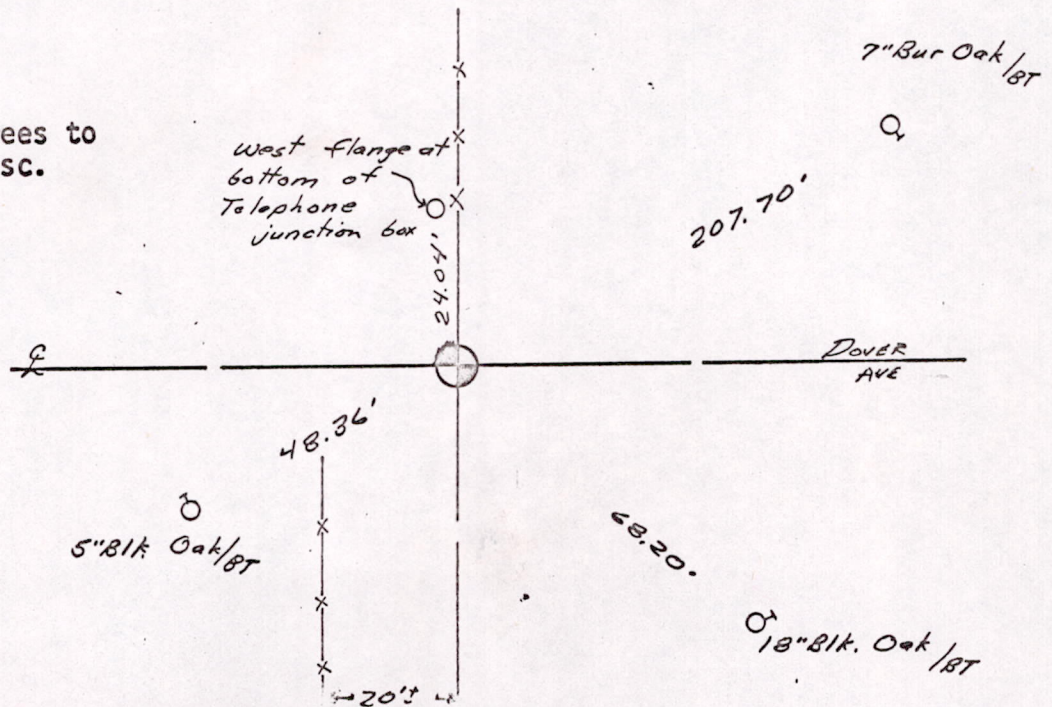

M152270700002