

ADAMS COUNTY

Survey Monument Record

TYPE OF MONUMENT: HARRISON

STATE PLANE COORDINATES: N _____

E _____

ELEVATION — M.S.L. DATUM: _____

THETA ANGLE: _____

FIELD BOOK: _____ PAGE _____

CORNER NO. 781
SECTION 23
TOWN 17
RANGE 7

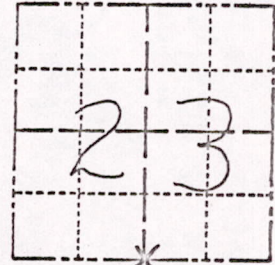

LOCATION
(Indicated by 'X')

90

SEAL:

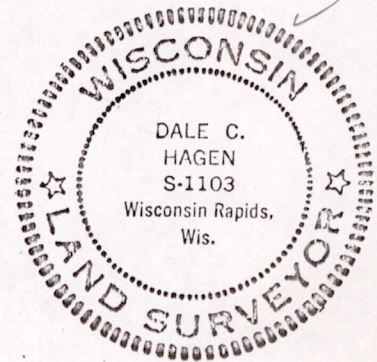

BASIS FOR MONUMENT LOCATION

(Use reverse side if necessary)

Show info such as: History of corner, with reference to Vol. and pg. dates, surveyor; exact description of monument replaced; if location computed, by taped or EDM traverse; landowner remarks, etc.

Ran EDM/transit traverse around Sections 22, 23 and 24, and tied into traverse around Section 27.

Excavation with backhoe revealed no evidence of the original corner or any remonumentation.

Could find no evidence of any witness monuments.

Set corner equidistant and on line between adjacent section corners.

3-28-77
GRASS
OK

CERTIFIED CORRECT:

Dale C. Hagen
Registered Land Surveyor

DATE: August 7, 1975

TIE SKETCH

(Show at least four ties)

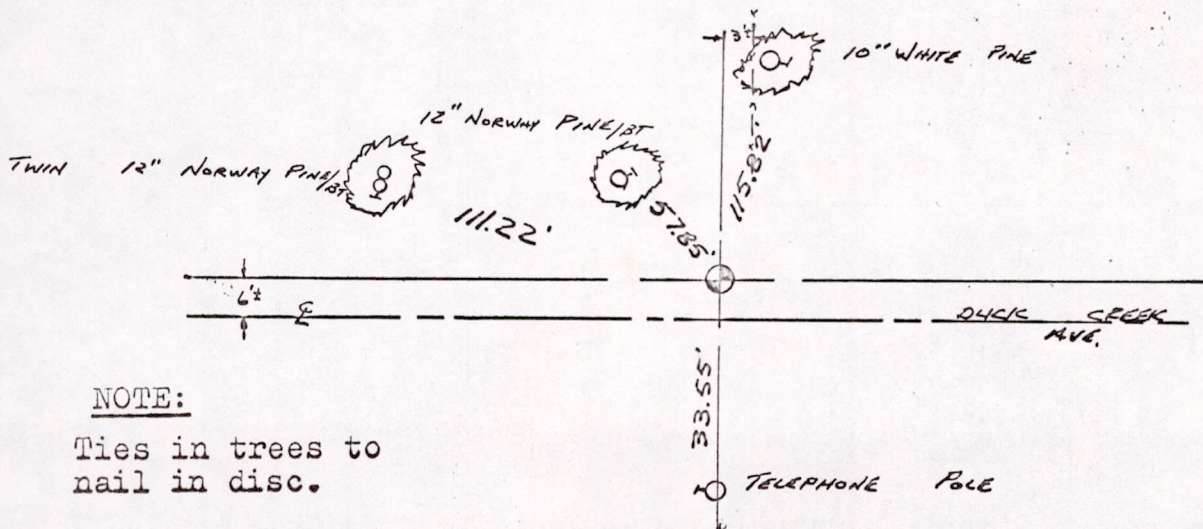

NOTE:

Ties in trees to nail in disc.

M1523170700005