

ADAMS COUNTY

Survey Monument Record

TYPE OF MONUMENT: Standard Harrison

STATE PLANE COORDINATES: N _____

E _____

ELEVATION — M.S.L. DATUM: _____

THETA ANGLE: _____

FIELD BOOK: _____ PAGE _____

CORNER NO. 727

SECTION 24

TOWN 17

RANGE 7

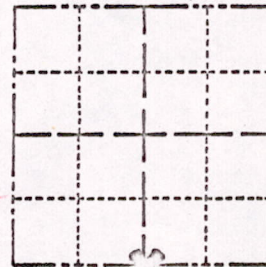

LOCATION
(Indicated by 'X')

SEAL:

BASIS FOR MONUMENT LOCATION

(Use reverse side if necessary)

Show info such as: History of corner, with reference to Vol. and pg, dates, surveyor; exact description of monument replaced; if location computed, by taped or EDM traverse; landowner remarks, etc.

Ran EDM/transit traverse around Sections 22, 23, 24 and portions on the adjoining sections to determine the search areas for investigation.

Excavation with backhoe yielded no evidence of the original corner or any remonumentation.

Set corner equidistant and on line between adjacent Section corners.

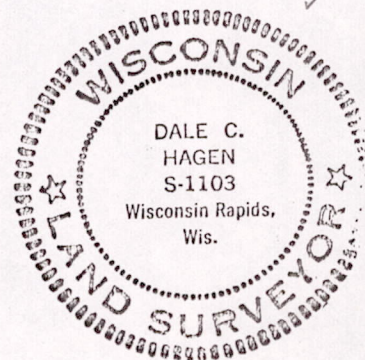

3-28-77
GR-SS
OK

CERTIFIED CORRECT:

Dale C. Hagen

Registered Land Surveyor

DATE: January 17, 1976

TIE SKETCH

(Show at least four ties)

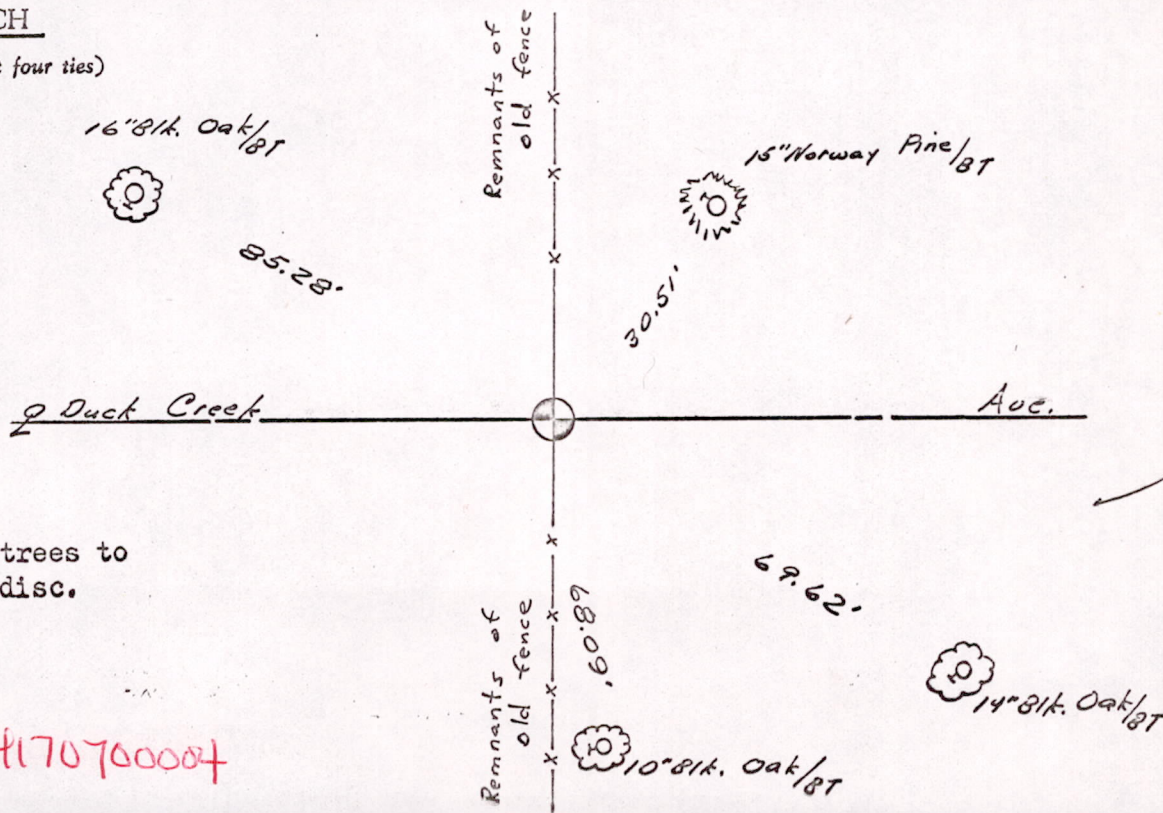

NOTE:

Ties in trees to nail in disc.

MIS 2417070004