

MORTGAGE INSPECTION

NOTE: THIS INSPECTION IS NOT INTENDED TO BE A SURVEY OF THE PREMISES. THIS INSPECTION IS FOR THE CLIENT'S INFORMATION AND IS NOT TO BE USED FOR NEW CONSTRUCTION OR OTHER PURPOSES. ALL LOT LINE DISTANCES SHOWN ARE TAKEN FROM THE DEED FURNISHED BY THE CLIENT.

CLIENT: COLUMBIA CO. TITLE COMPANY OWNER: DOUGLAS BUSH
 LENDER: ASSOCIATED BANK BUYER: N/A
 LOCATION: LOT 1, C.S.M. # 3993 MENE
 SECTION 25 T. 12 N R. 7 E, TOWN OF LINCOLN
 CITY OF _____ COUNTY ADAMS
 VILLAGE OF _____

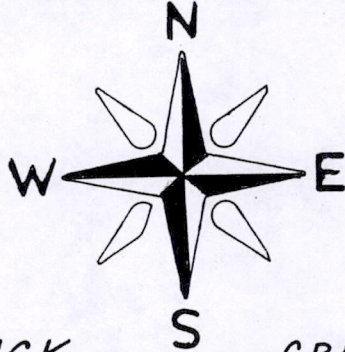

SCALE: 1" = 200'

DUCK CREEK AVENUE

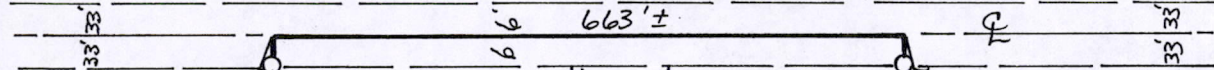

3/4" ROD FND.

3/4" ROD FND.

GRAVEL DRIVE

352'±

250'±

FOUNDATION

DETAIL: NO SCALE

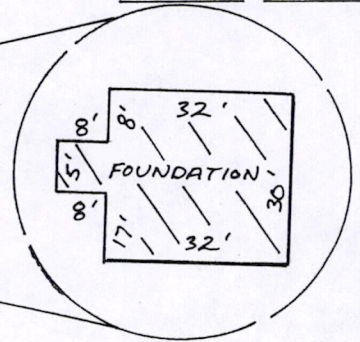

LANDS BY OTHERS

1323'±

LOT 1
C.S.M. # 3993

1322'±

LANDS BY OTHERS

664'±

LANDS BY OTHERS

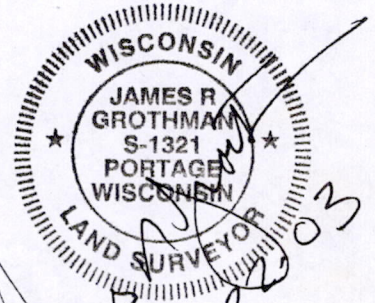

LEGEND

- O - IRON STAKE FOUND
- ◆ - MONUMENT FOUND
- ⊥ - NO MATERIAL EVIDENCE FOUND

POS 25170711001

as prepared by
Copy THIMAN & ASSOCIATES, S.C.
 LAND SURVEYORS

P.O. BOX 378
 PORTAGE, WI 53901

REF. NO. AC-8244
 SHEET 1 OF 2 FILE NO. 103-29
 C.A.E.

DESCRIPTION

Lot 1, of Adams County Certified Survey Map, No. 3993 as recorded March 30, 2000 at 9:05 AM in Volume 18 of Surveys on pages 188 - 189 as Document No. 392925. All being in the Town of Lincoln, County of Adams, State of Wisconsin.

SURVEYOR'S CERTIFICATE

I, **JAMES R. GROTHMAN**, Registered Land Surveyor in the State of Wisconsin, **DO HEREBY CERTIFY** that I have inspected the above described property and that I have mapped the property according to the official records and that I have mapped the locations of all visible structures, the dimensions of all principal buildings, roadways, apparent easements and visible encroachments, if any. This mortgage inspection has been prepared in accordance with the requirements of **COLUMBIA COUNTY TITLE COMPANY** and under the agreement between **GROTHMAN & ASSOCIATES, S.C.** and **COLUMBIA COUNTY TITLE COMPANY** which excludes this mortgage inspection from all of the requirements of Section AE 7.01 Wisconsin Administrative Code. Therefore all of the requirements of Section AE 7.01 have not been complied with. The mortgage inspection is made for the exclusive use of **COLUMBIA COUNTY TITLE COMPANY** and its insurees and for the period of one year from date hereof and as to them I certify the accuracy of said mortgage inspection as shown.

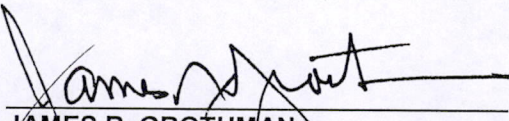

JAMES R. GROTHMAN
Registered Land Surveyor No. 1321
Dated: January 22, 2003

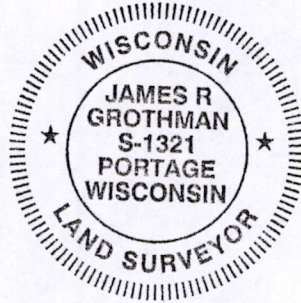

Copy

Pos 25170711001