

NORTH QUARTER CORNER SECTION 36-17-7E

PART OF THE SOUTHEAST QUARTER OF THE NORTHEAST QUARTER, AND PART OF THE NORTHEAST QUARTER OF THE SOUTHEAST QUARTER, PART OF THE NORTHWEST QUARTER OF THE SOUTHEAST QUARTER INCLUDING LOT 1 OF ADAMS COUNTY CERTIFIED SURVEY MAP NO. 2721 AND PART OF LOT 2 OF ADAMS COUNTY CERTIFIED SURVEY MAP NO. 1069 ALL IN SECTION 36, TOWNSHIP 17 NORTH, RANGE 7 EAST, TOWN OF LINCOLN, ADAMS COUNTY, WISCONSIN

N 00°44'42" W 2620.73'

FOUND SPIKE MATCHING CSM 1069 AND REPLACED WITH ROD. CENTER QUARTER CORNER SECTION 36-17-7E

1329.58'

N 89°30'43" E 1717.15'

LOT 2, ADAMS COUNTY CSM NO. 1069  
ADAMS COUNTY DOC. NO. 271310

N 00°27'38" W 29.00'

N 89°30'43" E 942.00'

27318 sq. ft  
0.63 Acres  
LESS 1ST AVE R/W 26361 sq. ft  
0.61 Acres

PART OF THE SE 1/4, NE 1/4 AND PART OF LOT 2, ADAMS COUNTY CSM NO. 1069 LANDS DESCRIBED IN ADAMS COUNTY DOC. NO. 373541

N 00°27'38" E 2609.81'

N 00°27'38" E 2638.81'

NORTHEAST CORNER SECTION 36-17-7E

LANDS DESCRIBED IN ADAMS COUNTY DOC. NO. 299563

872270 sq. ft  
20.02 Acres

N 1/2, NW 1/4, SE 1/4

387.58'

N 00°38'38" W 657.50'

N 1/2, NE 1/4, SE 1/4  
875349 sq. ft  
20.10 Acres  
LESS 1ST AVE R/W 853576 sq. ft  
19.60 Acres

HOUSE

GARAGE

SHED

33.00'

33.00'

29.00'

S 00°27'38" E 29.00'

EAST QUARTER CORNER SECTION 36-17-7E

6' 6"

6' 6"

659.82'

S 00°32'37" E 989.73'

MARQUETTE CO. - LANDS

UNPLATTED LANDS

655.18'

N 00°44'42" W 982.77'

1327.86'

N 1/2, S 1/2, NW 1/4, SE 1/4  
435842 sq. ft  
10.01 Acres

N 89°36'43" E 1328.44'

1327.86'

S 89°39'44" W 2655.72'

UNPLATTED LANDS

1295.43'

N 89°36'43" E 1328.43'

1294.86'

N 1/2, S 1/2, NE 1/4, SE 1/4  
437389 sq. ft  
10.04 Acres  
LESS 1ST AVE R/W 426504 sq. ft  
9.79 Acres

PROPOSED DRIVEWAY

33.00'

33.00'

329.91'

1649.54'

SOUTHQUARTER CORNER SECTION 36-17-7E

THE EAST LINE OF THE SE 1/4 OF SECTION 36-17-7E WAS ASSIGNED A BEARING OF S00°32'37"E AS THE BASIS OF BEARINGS ON THIS MAP.

GRAPHIC SCALE  
1 INCH = 200 FEET

LEGEND

- HARRISON MONUMENT, FD.
- 3/4" IRON ROD, FOUND
- 1 1/4" X 18" IRON ROD, 4.17#/FT., PLACED
- 3/4" X 18" IRON ROD, 1.5 #/FT., PLACED
- △ BERNTSEN SURVEY NAIL, PLACED

UNPLATTED LANDS

327.58'

S 00°44'42" W 1638.01'

SOUTH QUARTER CORNER SECTION 36-17-7E LOCATION DETERMINED FROM WITNESSES - MONUMENT UNDER WATER

I have fully complied with the provisions of Section AE 7 of the Wisconsin Administrative Code, in surveying, dividing, and mapping the same, to the best of my knowledge and belief.

9/3/2013

DATE

MSA PROFESSIONAL SERVICES  
GREGORY P. RHINEHART, REGISTERED LAND SURVEYOR, S-1478

NOTE: IF THE SURVEYOR'S SEAL AT LEFT IS NOT RED IN COLOR, THE SURVEY IS A COPY AND SHOULD BE ASSUMED TO CONTAIN UNAUTHORIZED ALTERATIONS. THE CERTIFICATION CONTAINED ON THIS DOCUMENT SHALL NOT APPLY TO COPIES.

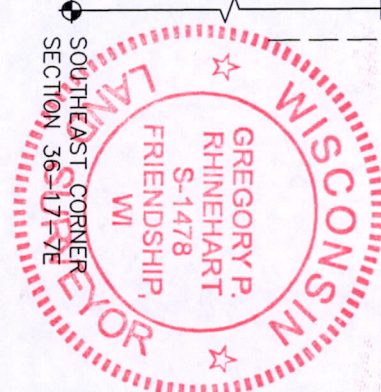

**MSA**  
PROFESSIONAL SERVICES

TRANSPORTATION • MUNICIPAL DEVELOPMENT • ENVIRONMENTAL

514 Main Street, P.O. Box 349 Friendship, WI 53934-0349  
608-339-3808 Fax: 608-339-8078  
© MSA Professional Services, Inc.

Cadd File: P:\15000s\15010s\15013\15013000\cadd\15013000.dwg		:PREPARED FOR:	
Field Book: FILE	Drawn by: GPR	Date: 1, MAY, 2013	JIM MARTIN
Page No.: FILE	Checked by: MAL	Scale: 1" = 200'	3701 CHIMNEY ROCK DRIVE FLOWER MOUND, TX 75022
Project No. R15013000	Sheet 1 of 1		

P0536170711001