

E. Lowrey

*Wm. Lowrey*  
SURVEYOR  
*No DATE*

TOWN OF LINCOLN, SEC. 36, T. 17 N., R. 17 E.

11  
N 01-09-53W 2603.83  
N 01-09-53W 2603.83

52  
N 00-50-06E 2602.24  
N 00-50-06E 2602.24

Comp

S 89-59-36E 2672.16 EAST 2672.26

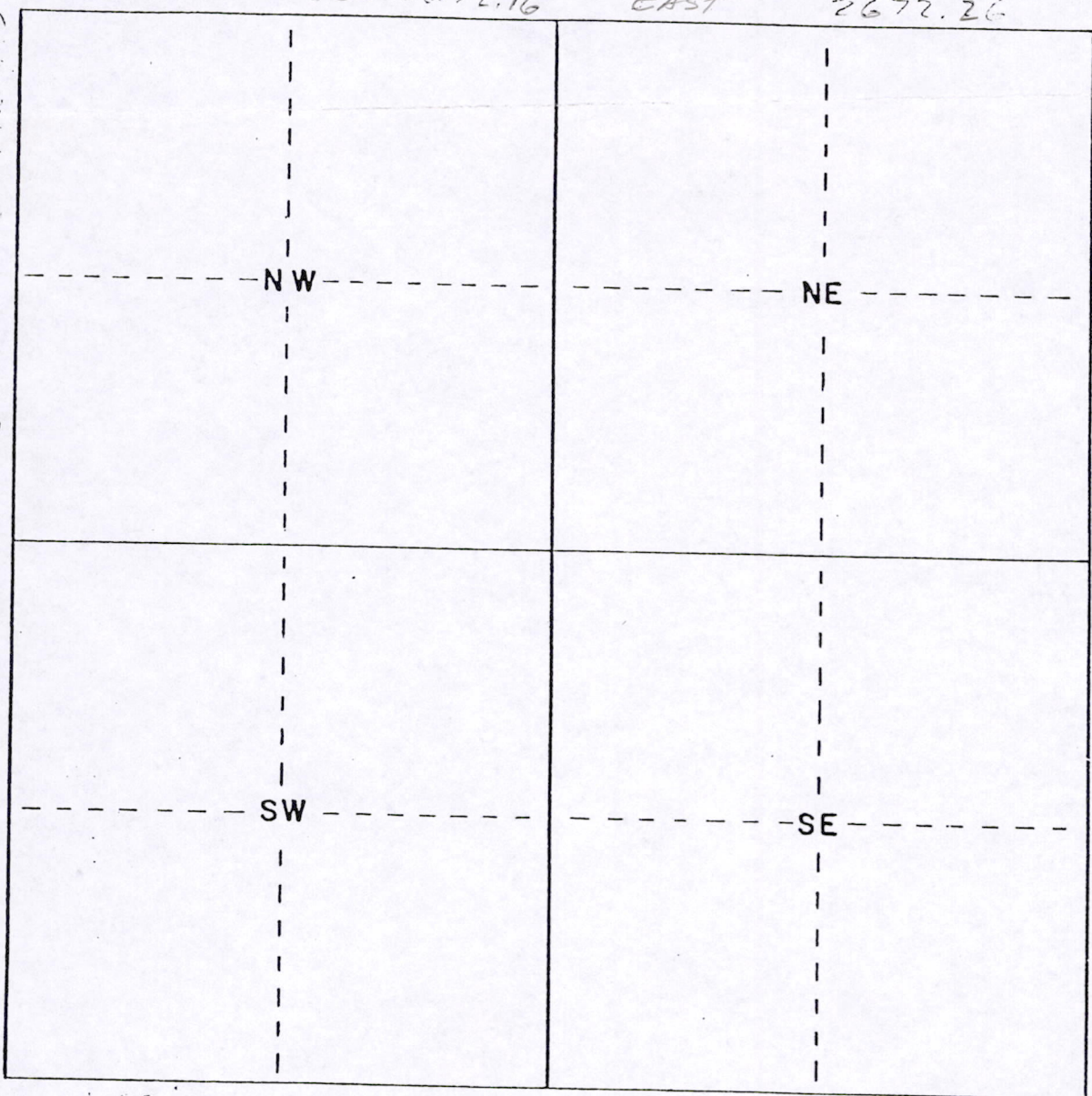

7  
S 00-24-40W 2638.75  
S 00-24-40W 2638.75  
S 00-24-40W 2639.34  
S 00-24-40W 2639.34  
S 00-24-40W 2639.34  
S 00-24-40W 2639.34

N 89-12-20 W 2647.93  
N 89-12-20 W 2647.93 31  
N 89-12-20 W 2647.93  
N 89-12-20 W 2647.93

ADAMS COUNTY, WISCONSIN

Sec 36 1707 00001