

Government Land Corner Certificate

ADAMS (R.R. 20th) County

TYPE OF MONUMENT: 1" Iron Pipe to be replaced with Harrison in
 STATE PLANE COORDINATES: N _____ Spring '79
 E _____

ELEVATION — M.S.L. DATUM: _____

THETA ANGLE: _____

FIELD BOOK: Springville A.P. PAGE _____

DRAWN BY: S. SORENSEN

CORNER NO. _____
 SECTION 12
 TOWN 18
 RANGE 5

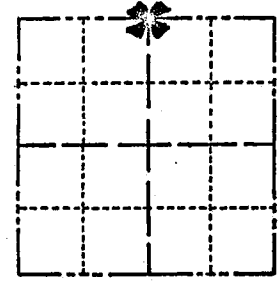

LOCATION
(Indicated by 'X')

BASIS FOR MONUMENT LOCATION

Show info such as: History of corner, with reference to Vol. and pg., dates, surveyor; exact description of monument replaced; if location computed, by taped or EDM traverse; landowner remarks, etc. (Use reverse side if necessary)

Excavated with backhoe and found bottom 15" of a pointed wood post. Accepted post as corner.

SEAL:

DATA SHOWN HERE ON
CERTIFIED CORRECT:

Registered Land Surveyor

DATE: _____

SAVE

TIE SKETCH

Show at least four ties, also fence lines, roads, topo, size and type of witness trees' and if off road - best way to arrive at corner.

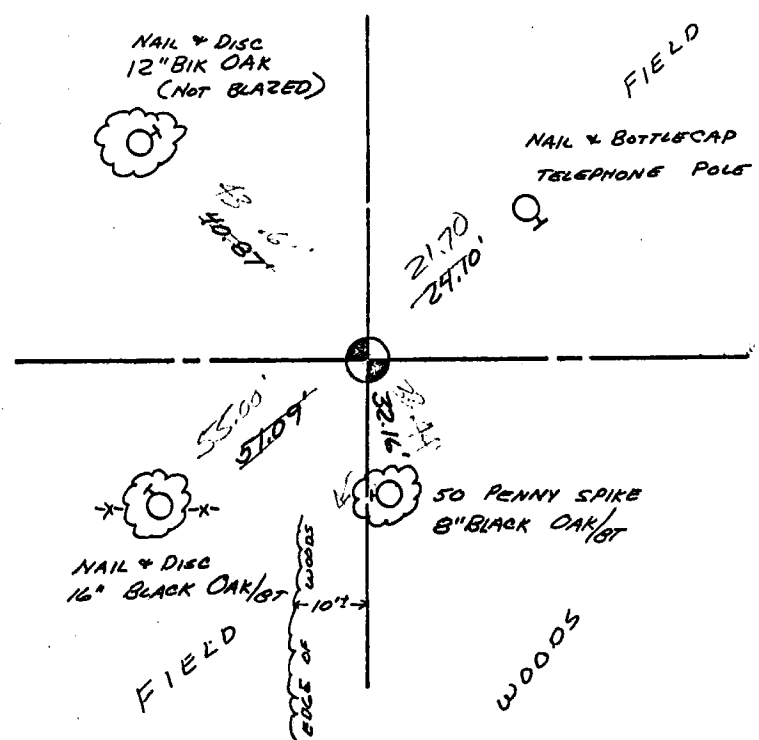

MAINTENANCE RECORD

| Date | Init. | Remarks |
|------|-------|---------|
| | | |
| | | |
| | | |
| | | |
| | | |
| | | |
| | | |
| | | |
| | | |
| | | |

NO. 1000000000