

CERTIFICATE OF SURVEY.

STATE OF WISCONSIN,
ADAMS COUNTY.

Wm. L. Smith

Surveyor, in and for the County and State aforesaid, do

hereby certify that I have surveyed and subdivided Section 26 Township 18 North of Range 5 East of 4 Principal Meridian, as represented by the courses and distances on the following plat, and annexed field-notes of survey:

Established the center of the section at the point of intersection of straight-quarter lines.

Established all quarter-quarter corners upon the section boundary at proportional distances between known section and quarter section corners, according to the original field-notes of the Government survey.

Established all lost corners at proportionate distances between known corners, according to original field-notes of the Government survey:

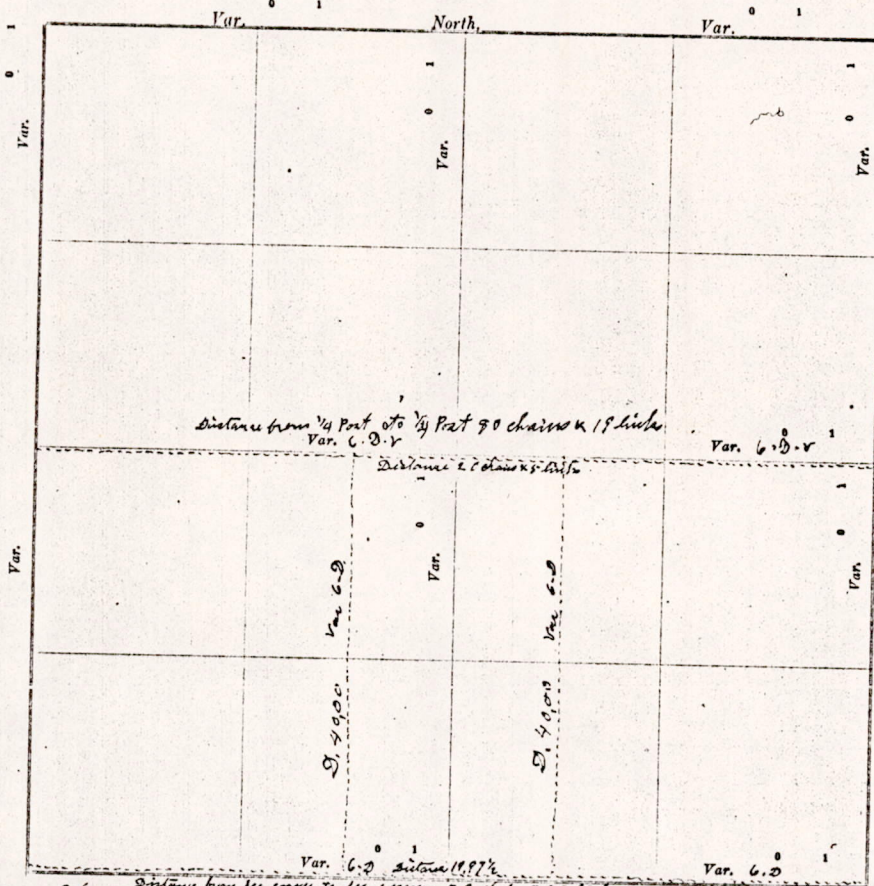

Plat of Section 26 Township 18 North, Range 5 East of 4 Principal Meridian. Scale, 80 chains to 6 inches. The figures in red ink are the lengths of the lines as stated in the field-notes of the Government survey.

Declination of the Magnetic Meridian from the True Meridian _____ East.

Surveyed and subdivided the 23rd day of May A. D. 1907, in accordance with the State Laws and Instructions of the Commissioner of the General Land Office, and recorded on pages _____ of Register in the County Surveyor's office.

WITNESS my hand this 23rd day of May A. D. 1907.

Wm. L. Smith County Surveyor.

The above work was done for Ben Sullivan & Nile R. Holm

No.	DESCRIPTION
1	N. W. 1/4
2	N. E. 1/4
3	S. E. 1/4
4	S. W. 1/4
5	N. 1/4
6	E. 1/4
7	S. 1/4
8	W. 1/4
No.	SUBDIVISION
1	Center 1/4
2	North 1/4
3	East 1/4
4	South 1/4
5	West 1/4
6	Center 1/4
7	North 1/4
8	East 1/4
9	South 1/4
10	Center 1/4
11	East 1/4
12	South 1/4
13	West 1/4
14	Center 1/4
15	South 1/4
16	West 1/4
17	Center 1/4

*Ben Sullivan
Nile R. Holm*

*Beginning at
new Bearing. and
new Bearing. Due
East corner of a
quarter Post, then
then set Post
26, and ran Post
running East & was
and ran East at
Distance 80 chain
2 1/2 miles East &
and 40 chains
set at the corner*

DESCRIPTION of Section, Quarter Section and Quarter quarter Section Corners of Section
 Township _____ North, Range _____ East of _____ Principal Meridian.

N. II. - The variation of needle adopted in establishing corners is _____

foresaid, do
 ter section
 survey:

No.	Government Corners.	Bearing Trees.	In. dia.	Courses they bear.	Links Distant.	Bearing Trees.	In. dia.	Courses they bear.	Links Distant.
1	N. W. Sec. cor. Identified								
2	N. E. Sec. cor. Identified				94				
3	S. E. Sec. cor. Identified	New	Bum oak	14 N-45-W	94				
4	S. W. Sec. cor. Identified	New	Blk Pine	10 N-41-W	85				
5	N. 1/4 Sec. cor. Identified								
6	E. 1/4 Sec. cor. Identified								
7	S. 1/4 Sec. cor. Identified	New	Blk Pine	12 S-35-E	32				
8	W. 1/4 Sec. cor. Identified								
No. SUBDIVISION CORNERS.									
1	Center 1/4 Sec. cor.								
2	North 1/4-1/4s N. W. qr.								
3	East 1/4-1/4s N. W. qr.								
4	South 1/4-1/4s N. W. qr.								
5	West 1/4-1/4s N. W. qr.								
6	Center 1/4-1/4s N. W. qr.								
7	North 1/4-1/4s N. E. qr.								
8	East 1/4-1/4s N. E. qr.								
9	South 1/4-1/4s N. E. qr.								
10	Center 1/4-1/4s N. E. qr.								
11	East 1/4-1/4s S. E. qr.								
12	South 1/4-1/4s S. E. qr.								
13	West 1/4-1/4s S. E. qr.								
14	Center 1/4-1/4s S. E. qr.								
15	South 1/4-1/4s S. W. qr.								
16	West 1/4-1/4s S. W. qr.								
17	Center 1/4-1/4s S. W. qr.								

NAMES OF SWORN ASSISTANTS.

CHAINMEN.	FLAGMEN.	AXMEN.
Gen Sullivan Mike R. Holm		

chains to 6

MINUTES.

Beginning at the southwest corner of section 26, corner identified, made one new bearing, and ran East at 6-D-V. to the quarter Post, corner identified, made one new bearing. Distance 39 chains & 83 links. Then East same Var. to the Post at the south East corner of section 26, which corner was established by running from the Proven quarter Post East & North. Made one new bearing. Distance 40 chains & 6 links. Then set Post 9 chains & 99 links East & west of the quarter Post on south side of section 26, and ran North at 6-D-V. on the west side of Sullivan's land, 40 chains to the quarter line running East & west. Then started at the quarter Post on the west side of 26 corner identified and ran East at 6-D-V. to the quarter Post on East side of 26 corner Post identified. Distance 80 chains & 18 links. set Post at center of section, and set Posts 10 chains 2 1/2 links East & west of center Post, and ran south of 6-D-V. on East side of Sullivan's land, 40 chains to the section line on south side of the section and at the Post set at the south East corner of Sullivan's land.

Instructions of

Surveyor.

rise

111 So. Smith county Surveyor

MIS26180500001