

DESCRIPTION of Section, Quarter Section and Quarter quarter Section Corners of Section  
 Township \_\_\_\_\_ North, Range \_\_\_\_\_ East of \_\_\_\_\_ Principal Meridian.

N. B. - The variation of needle adopted in establishing corners is \_\_\_\_\_

County and State aforesaid, do  
 East of \_\_\_\_\_

Section and quarter section  
 the Government survey:



No.	Government Corners.	Bearing Trees.	In. dia.	Courses they bear.	Links Distant.	Bearing Trees.	In. dia.	Courses they bear.	Links Distant.
1	N. W. Sec. cor. Identified								
2	N. E. Sec. cor. Identified								
3	S. E. Sec. cor. Identified								
4	S. W. Sec. cor. Identified								
5	N. 1/4 Sec. cor. Identified								
6	E. 1/4 Sec. cor. Identified								
7	S. 1/4 Sec. cor. Identified								
8	W. 1/4 Sec. cor. Identified								
No.	SUBDIVISION CORNERS.								
1	Center 1/4 Sec. cor.								
2	North 1/4-1/4s N. W. qr.								
3	East 1/4-1/4s N. W. qr.								
4	South 1/4-1/4s N. W. qr.								
5	West 1/4-1/4s N. W. qr.								
6	Center 1/4-1/4s N. W. qr.								
7	North 1/4-1/4s N. E. qr.								
8	East 1/4-1/4s N. E. qr.								
9	South 1/4-1/4s N. E. qr.								
10	Center 1/4-1/4s N. E. qr.								
11	East 1/4-1/4s S. E. qr.								
12	South 1/4-1/4s S. E. qr.								
13	West 1/4-1/4s S. E. qr.								
14	Center 1/4-1/4s S. E. qr.								
15	South 1/4-1/4s S. W. qr.								
16	West 1/4-1/4s S. W. qr.								
17	Center 1/4-1/4s S. W. qr.								

NAMES OF SWORN ASSISTANTS.

CHAINMEN.	FLAGMEN.	AXMEN.
<p>Ole Gunner            John Eblin</p>		

Scale, 80 chains to 6

Laws and Instructions of  
 Surveyor's office.

Surveyor.

Chris Sperry

MINUTES.

Commencing at the Identified 1/4 Post on the East side of section 32-D-18 R-6-E and ran north at S-D-V 40 chains to the Post at the NE corner of said section. Thence ran west at S-D-V 80 chains & 92 links to the Identified Post at the N.W. corner of said section. Then Established the 1/4 Post on the North side of said section at 40 chains & 46 links. Thence South at S-D-V on the N & S quarter line 20 chains & set Post, then south 20 chains & set Post at center of the section. Then went to the 1/4 Post on the East side of the section & ran west on the E & W quarter line 40 chains & 15 links & set Post at center of section. Then started at the Post 20 chains south from the Established 1/4 Post on the North side of the section and ran East on the S & E line 20 chains & 18 links & set Post. Then went to the corrected 80 Rod Post on the North side of said section & ran north at S-D-V 20 chains to Post at the south East corner of the NW 1/4 of the NE 1/4 of section.

W. G. Smith County Surveyor

MIS32180500001

# CERTIFICATE OF SURVEY.

STATE  
A  
herby c  
Principa  
E  
E  
corners,  
E

STATE OF WISCONSIN, } ss. I, M. L. Smith Surveyor, in and for the County and State aforesaid, do  
ADAMS COUNTY. }  
herby certify that I have surveyed and subdivided Section 32 Township 18 North of Range 5 East of 4th  
Principal Meridian, as represented by the courses and distances on the following plat, and annexed field-notes of survey:  
Established the center of the section at the point of intersection of straight quarter lines.  
Established all quarter-quarter corners upon the section boundary at proportional distances between known section and quarter section  
corners, according to the original field-notes of the Government survey.  
Established all lost corners at proportionate distances between known corners, according to original field-notes of the Government survey:

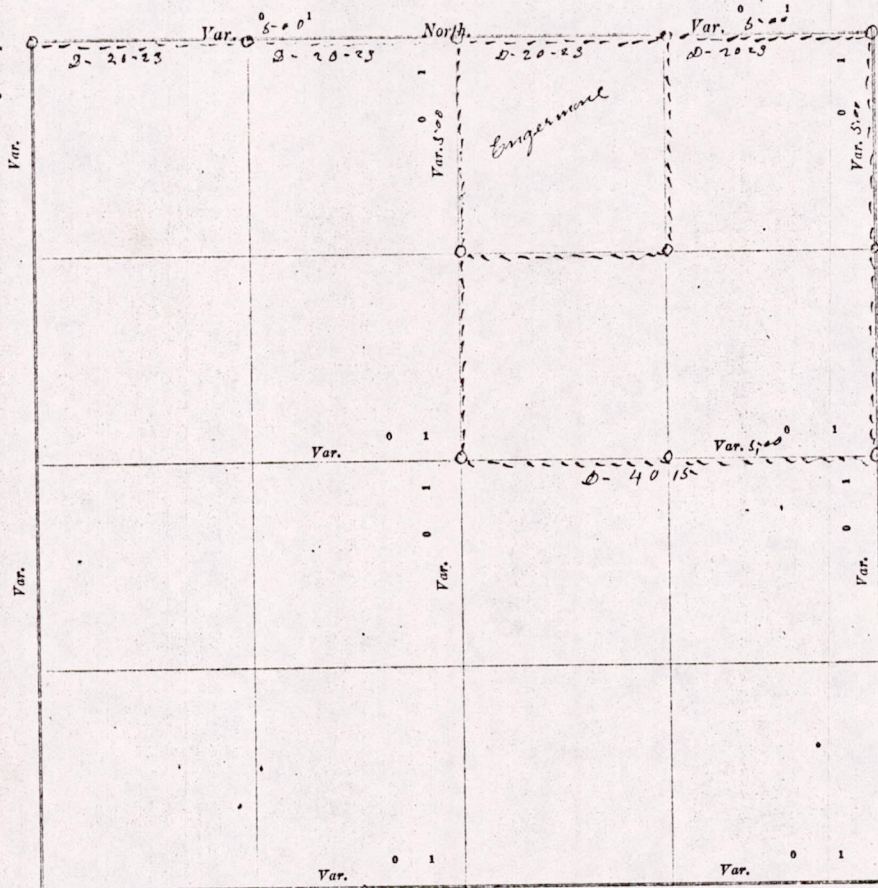

Plat of Section 32, Township 18 North, Range 5 East of 4th Principal Meridian. Scale, 80 chains to 6 inches. The figures in red ink are the lengths of the lines as stated in the field-notes of the Government survey.

Declination of the Magnetic Meridian from the True Meridian \_\_\_\_\_ East.

Surveyed and subdivided this 8th day of April A. D. 1914, in accordance with the State Laws and Instructions of

the Commissioner of the General Land Office, and recorded on pages \_\_\_\_\_ of Register in the County Surveyor's office.

WITNESS my hand this 8th day of April A. D. 1914.

M. L. Smith county Surveyor.

*The above work was done at the request of John Engermond & Chris Sparks*

MIS 32180500001

*C. L. J. Inc*  
*Comm. R. L. Smith*  
*advised*  
*the 1st*  
*section*  
*of*  
*range*  
*5*  
*East*  
*of*  
*4th*  
*Prin*  
*Meridian*  
*is*  
*the*  
*same*  
*as*  
*the*  
*one*  
*in*  
*the*  
*plat*  
*of*  
*the*  
*1st*  
*of*  
*1914*