

PLAT OF SURVEY

PREPARED FOR: WILLIAM AND MARY LEHNER

BEING THE E1/2 OF THE SE1/4 NW1/4, SECTION 34, TOWNSHIP 18 NORTH, RANGE 5 EAST,
TOWN OF STRONGS PRAIRIE, ADAMS COUNTY, WISCONSIN

NW CORNER
SEC 34 T18N R5E
RR SPIKE

N1/4 CORNER
SEC 34 T18N R5E
RR SPIKE

N 89°56'57" E 2617.31'

1321.77'

UNPLATTED LANDS OWNED BY OTHERS.

N 89°51'37" E 1975.43'

N 89°59'42" E 656.85'

S 00°18'43" W 1319.05'

NORTH LINE SE1/4 NW1/4 AS MONUMENTED

BEARINGS REFERENCED TO THE
NORTH LINE NW1/4 SAID SECTION 34
ASSUMED TO BEAR N 89°56'57" E



LOT 1
19.92 ACRES OR
867697 SQ.FT.

1656 CZECH DRIVE

N 00°57'36" E 2643.54'

1321.77'

PARCEL 2 CSM 2294
OWNED BY OTHERS.

N 00°23'02" E 1318.49'

1285.46'

EAST LINE SE1/4 NW1/4

1263.35'

S 00°18'43" W 1319.05'

S 00°18'43" W 2638.10'

UNPLATTED LANDS OWNED BY OTHERS.

LINE	BEARING	DISTANCE
L1	S 89°40'03" W	32.92'
L2	S 89°47'07" W	32.84'
L3	S 89°44'39" W	208.93'
L4	N 89°38'50" W	313.91'
L5	S 89°51'36" W	69.92'



W1/4 CORNER
SEC 34 T18N R5E
HARRISON MON.

E1/4 CORNER
SEC 34 T18N R5E
HARRISON MON.

N 89°44'43" E 1325.78'

N 89°49'24" E 662.97'

33.03'

66'

55.70'

N 89°42'44" E 2621.29'

LOT 1 CSM 5049

LOT 1 CSM 2827

LOT 2 CSM 704

LOT 1 CSM 704

CENTER
SEC 34 T18N R5E
3/4in. REBAR

LEGEND

- ⊕ = GOVERNMENT CORNER LOCATION
- = 3/4in. X 18in. REBAR 1.50lbs/ft. SET
- = 1in. IRON PIPE FOUND
- ⊙ = 3/4in. REBAR FOUND

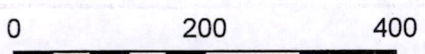

SCALE 1" = 200'

CENTRAL STAKING INC.

2523 POST ROAD
STEVENS POINT WI 54481
OFFICE: 715-345-6904 FAX:715-345-7728

POS 34180521001

PLAT OF SURVEY

PREPARED FOR: WILLIAM AND MARY LEHNER

BEING THE E1/2 OF THE SE1/4 NW1/4, SECTION 34, TOWNSHIP 18 NORTH, RANGE 5 EAST,
TOWN OF STRONGS PRAIRIE, ADAMS COUNTY, WISCONSIN

SURVEYOR'S CERTIFICATE

I DARREN KRZANOWSKI, REGISTERED LAND SURVEYOR, HEREBY CERTIFY: THAT UNDER THE DIRECTION OF WILLIAM AND MARY LEHNER, I HAVE SURVEYED, DIVIDED AND MAPPED PART OF THE SOUTHEAST QUARTER OF THE NORTHWEST QUARTER, SECTION 34, TOWNSHIP 18 NORTH, RANGE 5 EAST, TOWN OF STRONGS PRAIRIE, ADAMS COUNTY, WISCONSIN.

DESCRIBED AS FOLLOWS:

COMMENCING AT THE NORTH QUARTER CORNER OF SAID SECTION 34; THENCE S 00°18'43" W 1319.05 FEET TO THE POINT OF BEGINNING; THENCE CONTINUING S 00°18'43" W 1319.05 FEET; THENCE S 89°40'03" W 32.92 FEET; THENCE S 89°47'07" W 32.84 FEET; THENCE S 89°44'39" W 208.93 FEET; THENCE N 89°38'50" W 313.91 FEET; THENCE S 89°51'36" W 69.92 FEET; THENCE N 00°23'02" E 1318.49 FEET; THENCE N 89°59'42" E 656.85 FEET TO THE POINT OF BEGINNING.

THAT SAID MAP IS A TRUE AND CORRECT REPRESENTATION OF THE EXTERIOR BOUNDARIES OF THE LANDS SURVEYED AND THE DIVISION THERE OF MADE.

THAT I HAVE FULLY COMPLIED WITH THE PROVISIONS OF CHAPTER A-E 7 OF THE WISCONSIN ADMINISTRATIVE CODE. ALL TO THE BEST OF MY KNOWLEDGE AND BELIEF IN SURVEYING AND MAPPING THE SAME

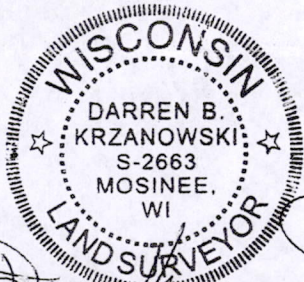

Darren B. Krzanowski
DARREN KRZANOWSKI R.L.S. 2663
DATED THIS 5TH DAY OF NOVEMBER, 2014

CENTRAL STAKING INC.

2523 POST ROAD
STEVENS POINT WI 54481
OFFICE: 715-345-6904 FAX:715-345-7728

POS34180521001