

# CERTIFICATE OF SURVEY.

STATE OF WISCONSIN, }  
ADAMS COUNTY. }

I, Wm. La Smith Surveyor, in and for the County and State aforesaid, do

hereby certify that I have surveyed and subdivided Section 2 Township 18 North of Range 6 East of 4th Principal Meridian, as represented by the courses and distances on the following plat, and annexed field-notes of survey:

- Established the center of the section at the point of intersection of straight quarter lines.
- Established all quarter-quarter corners upon the section boundary at proportional distances between known section and quarter section corners, according to the original field-notes of the Government survey.
- Established all lost corners at proportionate distances between known corners, according to original field-notes of the Government survey:

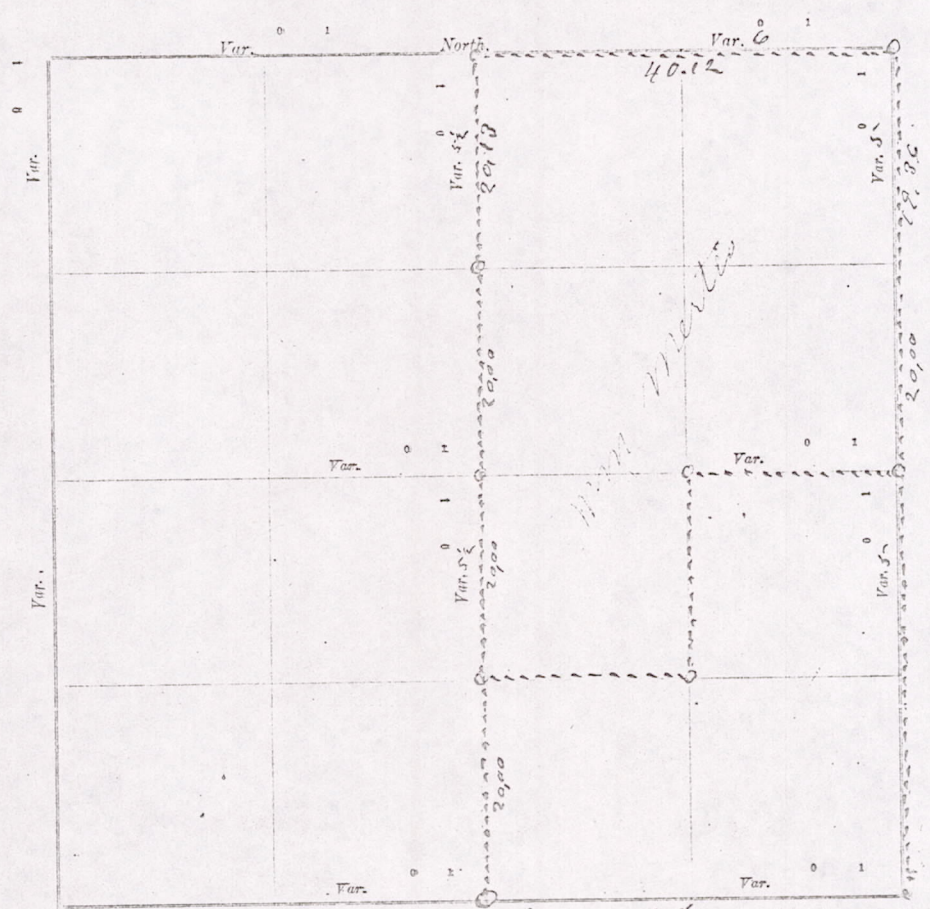

Plat of Section 2, Township 18 North, Range 6 East of 4th Principal Meridian. Scale, 80 chains to 6 inches. The figures in red ink are the lengths of the lines as stated in the field-notes of the Government survey.

Declination of the Magnetic Meridian from the True Meridian \_\_\_\_\_ East.

Surveyed and subdivided Sept 15 A. D. 1909, in accordance with the State Laws and Instructions of the Commissioner of the General Land Office, and recorded on pages \_\_\_\_\_ of Register in the County Surveyor's office.

WITNESS my hand this 15 day of Sept A. D. 1909.

Wm. La Smith Surveyor.

MIS 02180600002

DESCRIPTION of Section, Quarter Section and Quarter quarter Section Corners of Section

Township \_\_\_\_\_ North, Range \_\_\_\_\_ East of \_\_\_\_\_ Principal Meridian.

N. B. - The variation of needle adopted in establishing corners is \_\_\_\_\_

the aforesaid, do  
of 4/26/23

quarter section  
ment survey:

20,000

le. 80 chains to 0

and Instructions of  
Office.

Surveyor.

No.	Government Corners.	Bearing Trees.	In. dia.	Courses they bear.	Links Distant.	Bearing Trees.	In. dia.	Courses they bear.	Links Distant.
1	N. W. Sec. cor. Identified								
2	N. E. Sec. cor. Identified								
3	S. E. Sec. cor. Identified								
4	S. W. Sec. cor. Identified								
5	N. 1/4 Sec. cor. Identified								
6	E. 1/4 Sec. cor. Identified								
7	S. 1/4 Sec. cor. Identified								
8	W. 1/4 Sec. cor. Identified								
<p><i>also Block 10 A-40-C 98 1/2</i></p>									
No.	SUBDIVISION CORNERS.								
1	Center 1/4 Sec. cor.								
2	North 1/4-1/4s N. W. qr.								
3	East 1/4-1/4s N. W. qr.								
4	South 1/4-1/4s N. W. qr.								
5	West 1/4-1/4s N. W. qr.								
6	Center 1/4-1/4s N. W. qr.								
7	North 1/4-1/4s N. E. qr.								
8	East 1/4-1/4s N. E. qr.								
9	South 1/4-1/4s N. E. qr.								
10	Center 1/4-1/4s N. E. qr.								
11	East 1/4-1/4s S. E. qr.								
12	South 1/4-1/4s S. E. qr.								
13	West 1/4-1/4s S. E. qr.								
14	Center 1/4-1/4s S. E. qr.								
15	South 1/4-1/4s S. W. qr.								
16	West 1/4-1/4s S. W. qr.								
17	Center 1/4-1/4s S. W. qr.								

NAMES OF SWORN ASSISTANTS.

CHAINMEN.	FLAGMEN.	AXMEN.
<i>Paul Ole</i> <i>Wm Mertis</i>		

MINUTES.

Starting at the Identified N E corner of section 2 Town 18-R-6-E and Run South at 5-D-V 19 chains & 36 links & set Post. Then 20 chains South & set Post for Quarter Post, old Bearings or Post not found. Then 40 chains South to S E corner of section West found no Bearings or Post. Then started at same N E corner of section & Run west on town line at 6-D-V 40 chains and 12 links found one Bearing & set Post. Then from said Quarter Post on north side of section, South at 5-D-V to the Identified Quarter Post on south side of section, distance shown on Plat. Then from 8th Post on the N x S Quarter line, north from south side of section, and run East 20 chains & set Post. Then North 20 chains & set Post. Then East 20 chains to Quarter Post on East side of section

M. C. Smith County Surveyor

MISO2180600002