

CERTIFICATE OF SURVEY.

STATE OF WISCONSIN,)
ADAMS COUNTY.)

M. L. Smith Surveyor, in and for the County and State of Wisconsin,

hereby certify that I have surveyed and subdivided Section 29 Township 18 North of Range 6 East of 4th Principal Meridian, as represented by the courses and distances on the following plat, and annexed field-notes of survey:

Established the center of the section at the point of intersection of straight quarter lines.

Established all quarter-quarter corners upon the section boundary at proportional distances between known section and quarter corners, according to the original field-notes of the Government survey.

Established all lost corners at proportionate distances between known corners, according to original field-notes of the Government survey.

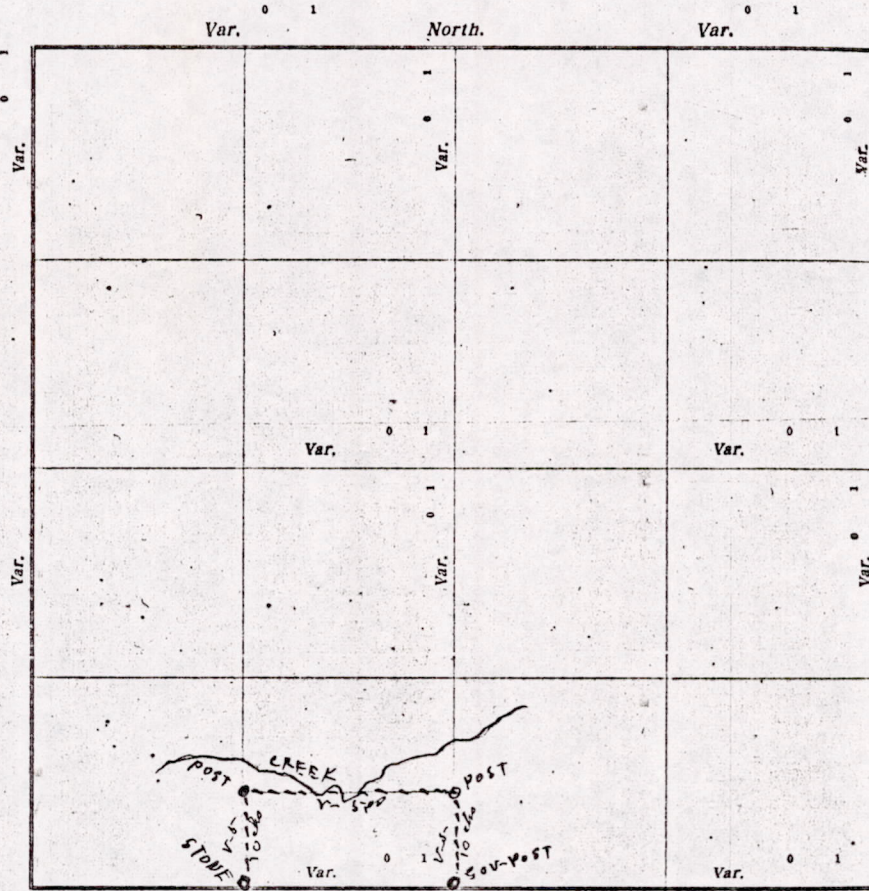

Plat of Section 29, Township 18 North, Range 6 East of 4th Principal Meridian. Scale, 80 chains to 4 inches. The figures in red ink are the lengths of the lines as stated in the field-notes of the Government survey.

Declination of the Magnetic Meridian from the True Meridian _____ East.

Surveyed and subdivided this 20th day of July A. D. 1920, in accordance with the State Laws and Instructions of the Commissioner of the General Land Office, and recorded on pages _____ of Register in the County Surveyor's office.

WITNESS my hand this 20th day of July A. D. 1920.

M. L. Smith County Surveyor

The above work was done at the request of G. W. Bingham

MIS 291806 00002

DESCRIPTION of Section, Quarter Section and Quarter-quarter Section Corners of Section
 Township North, Range East of Principal Meridian. 78

N. B.—The variation of needle adopted in establishing corners is _____

ty and State aforesaid, do
 East of 4 1/2
 tion and quarter section,
 Government survey:

No.	Government Corners	Bearing Trees	In. dia.	Courses they bear	Links Distant	Bearing Trees	In. dia.	Courses they bear	Links Distant
1	N. W. Sec. cor. Identified								
2	N. E. Sec. cor. Identified								
3	S. E. Sec. cor. Identified								
4	S. W. Sec. cor. Identified								
5	N. 1/4 Sec. cor. Identified								
6	E. 1/4 Sec. cor. Identified								
7	S. 1/4 Sec. cor. Identified								
8	W. 1/4 Sec. cor. Identified								
<p style="text-align: center;">SUBDIVISION CORNERS</p>									
1	Center 1/4 Sec. cor.								
2	North 1/4-1/4s N. W. qr.								
3	East 1/4-1/4s N. W. qr.								
4	South 1/4-1/4s N. W. qr.								
5	West 1/4-1/4s N. W. qr.								
6	Center 1/4-1/4s N. W. qr.								
7	North 1/4-1/4s N. E. qr.								
8	East 1/4-1/4s N. E. qr.								
9	South 1/4-1/4s N. E. qr.								
10	Center 1/4-1/4s N. E. qr.								
11	East 1/4-1/4s S. E. qr.								
12	South 1/4-1/4s S. E. qr.								
13	West 1/4-1/4s S. E. qr.								
14	Center 1/4-1/4s S. E. qr.								
15	South 1/4-1/4s S. W. qr.								
16	West 1/4-1/4s S. W. qr.								
17	Center 1/4-1/4s S. W. qr.								

Bearing of the 1st corner of the
 1/4 Sec. of the S.W. 1/4 of the 29
 T. 18 N. R. 6 E.

Blk oak 16 ^N 8-54 ^E W 42

NAMES OF SWORN ASSISTANTS.

CHAINMEN	FLAGMEN	AXMEN
<p><i>E. W. Bingham</i> <i>Loyle Hbard</i></p>		

MINUTES.

Commencing at the Identified quarter Post on the south side
 of section 29-T-18-R-6-E and ran North at 8-54-10 chains & set Post
 thence west to the center of the N & S 8th Line Highway, thence
 south 10 chains of said Highway to stone at SW corner of said forty

M. C. Smith County Surveyor

MIS 29180600002

Var. 1/2
 Var. 1/2

lian. Scale, 80 chains to 6.

the Laws and Instructions of
 Surveyor's office.

W. B. Bingham Surveyor.

Bingham