

# CERTIFICATE OF SURVEY.

STATE OF WISCONSIN, }  
ADAMS COUNTY. }

ss. I. M. C. Smith

Surveyor, in and for the County and State aforesaid, do

herely certify that I have surveyed and subdivided Section 31 Township 18 North of Range 6 East of 4th Principal Meridian, as represented by the courses and distances on the following plat, and annexed field-notes of survey:

Established the center of the section at the point of intersection of straight quarter lines.

Established all quarter-quarter corners upon the section boundary at proportionate distances between known section and quarter section corners, according to the original field-notes of the Government survey.

Established all lost corners at proportionate distances between known corners, according to original field-notes of the Government survey:

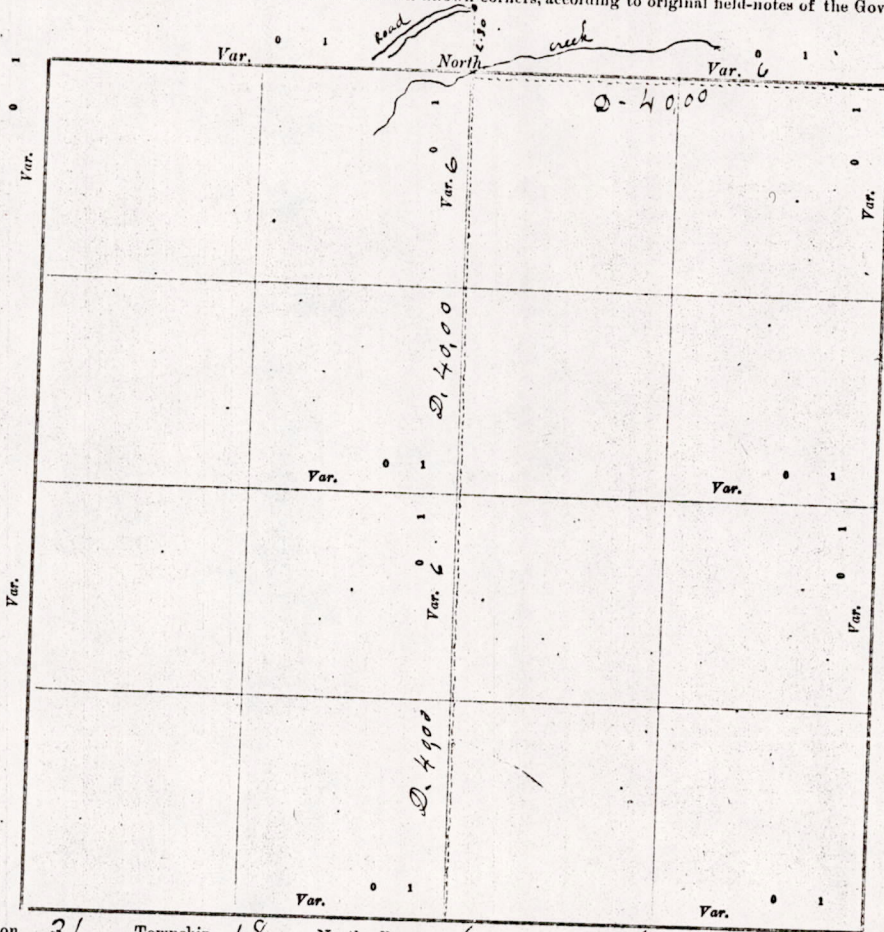

Plat of Section 31, Township 18 North, Range 6 East of 4th Principal Meridian. Scale, 80 chains to 6 inches. The figures in red ink are the lengths of the lines as stated in the field-notes of the Government survey.

Declination of the Magnetic Meridian from the True Meridian \_\_\_\_\_ East.

Surveyed and subdivided July 2nd A. D. 1907, in accordance with the State Laws and Instructions of

the Commissioner of the General Land Office, and recorded on pages \_\_\_\_\_ of Register in the County Surveyor's office.

WITNESS my hand this 2nd day of July A. D. 1907.

M. C. Smith county Surveyor.

*The above work was done for Steven Splitter road work*

DESCRIP

Township

N. B. The following

- No. 1 N. W. Sec. 31
- 2 N. E. Sec. 31
- 3 S. E. Sec. 31
- 4 S. W. Sec. 31
- 5 N. 1/4 Sec. 31
- 6 E. 1/4 Sec. 31
- 7 S. 1/4 Sec. 31
- 8 W. 1/4 Sec. 31
- No. SUBDIVISION
- 1 Center 1/4 Sec. 31
- 2 North 1/4-1/4
- 3 East 1/4-1/4
- 4 South 1/4-1/4
- 5 West 1/4-1/4
- 6 Center 1/4-1/4
- 7 North 1/4-1/4
- 8 East 1/4-1/4
- 9 South 1/4-1/4
- 10 Center 1/4-1/4
- 11 East 1/4-1/4
- 12 South 1/4-1/4
- 13 West 1/4-1/4
- 14 Center 1/4-1/4
- 15 South 1/4-1/4
- 16 West 1/4-1/4
- 17 Center 1/4-1/4

*B. Payne  
Steven Splitter*

*Beginning  
and Run  
the North  
40 chains. To  
Quarter Post  
section 31  
running the*

MIS31180600002

DESCRIPTION of Section, Quarter Section and Quarter quarter Section Corners of Section

Township \_\_\_\_\_ North, Range \_\_\_\_\_ East of \_\_\_\_\_ Principal Meridian.

N. B. - The variation of needle adopted in establishing corners is \_\_\_\_\_

No.	Government Corners.	Bearing Trees.	In. dia.	Courses they bear.	Links Distant.	Bearing Trees.	In. dia.	Courses they bear.	Links Distant.
1	N. W. Sec. cor. Identified								
2	N. E. Sec. cor. Identified								
3	S. E. Sec. cor. Identified								
4	S. W. Sec. cor. Identified								
5	N. 1/4 Sec. cor. Identified	<i>new</i>	<i>12</i>	<i>S-18-E</i>	<i>211</i>	<i>new</i>	<i>20</i>	<i>N-16-W</i>	<i>107</i>
6	E. 1/4 Sec. cor. Identified								
7	S. 1/4 Sec. cor. Identified								
8	W. 1/4 Sec. cor. Identified								
<b>NO. SUBDIVISION CORNERS.</b>									
1	Center 1/4 Sec. cor.								
2	North 1/4-1/4s N. W. qr.								
3	East 1/4-1/4s N. W. qr.								
4	South 1/4-1/4s N. W. qr.								
5	West 1/4-1/4s N. W. qr.								
6	Center 1/4-1/4s N. W. qr.								
7	North 1/4-1/4s N. E. qr.								
8	East 1/4-1/4s N. E. qr.								
9	South 1/4-1/4s N. E. qr.								
10	Center 1/4-1/4s N. E. qr.								
11	East 1/4-1/4s S. E. qr.								
12	South 1/4-1/4s S. E. qr.								
13	West 1/4-1/4s S. E. qr.								
14	Center 1/4-1/4s S. E. qr.								
15	South 1/4-1/4s S. W. qr.								
16	West 1/4-1/4s S. W. qr.								
17	Center 1/4-1/4s S. W. qr.								

*Bearing for Post at start of Road  
New Blk oak 20 S-82-W 135*

NAMES OF SWORN ASSISTANTS.

CHAINMEN.	FLAGMEN.	AXMEN.
<i>B. Payne Steven Splitter</i>		

MINUTES.

Beginning at the quarter Post on the south side of section 31 down 18-R-6-E. and Ran North at G-D-V, 20 chains then went East to the quarter Post on the North side of section 31 corner identified (stone) and ran west at G-D 40 chains. To the Point reached in running from the south Established quarter Post (set stone) and made 2 new Bearings. Then Ran North on section 31 2 chains & 30 links & set Post. which is the start of Road running through Chas Sachs land. Made Bearing also for Post at start of road

*M. C. Smith county Surveyor*

MIS31180600002