

ADAMS COUNTY

Survey Monument Record

TYPE OF MONUMENT: HARRISON STANDARD

STATE PLANE COORDINATES: N \_\_\_\_\_  
E \_\_\_\_\_

ELEVATION — M.S.L. DATUM: \_\_\_\_\_

THETA ANGLE: \_\_\_\_\_

FIELD BOOK: \_\_\_\_\_ PAGE \_\_\_\_\_

CORNER NO. 501  
SECTION 31  
TOWN 18  
RANGE 6

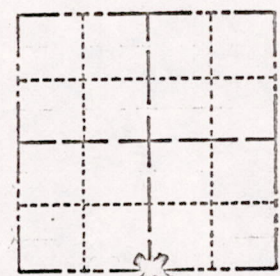

LOCATION  
(Indicated by 'X')

SEAL:

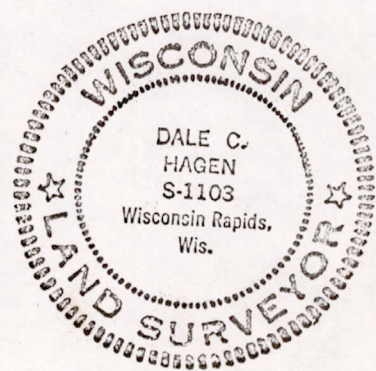

BASIS FOR MONUMENT LOCATION

(Use reverse side if necessary)

Show info such as: History of corner, with reference to Vol. and pg. dates, surveyor; exact description of monument replaced; if location computed, by taped or EDM traverse; landowner remarks, etc.

Retraced plat by R. Klein, certified survey map by H. Sime, and survey by M.C. Smith, found 1"X24" iron bar, over chunk of concrete and surrounded by three bricks on end. Replaced existing monument with a harrison standard. M.C. Smith's notes are from 1911 and are recorded in the county surveyor's office in Adams County.

*Everything O.K. 10-11-75 - 55*

CERTIFIED CORRECT:

*Dale C. Hagen*  
Registered Land Surveyor

DATE: 12.30.74

TIE SKETCH

(Show at least four ties)

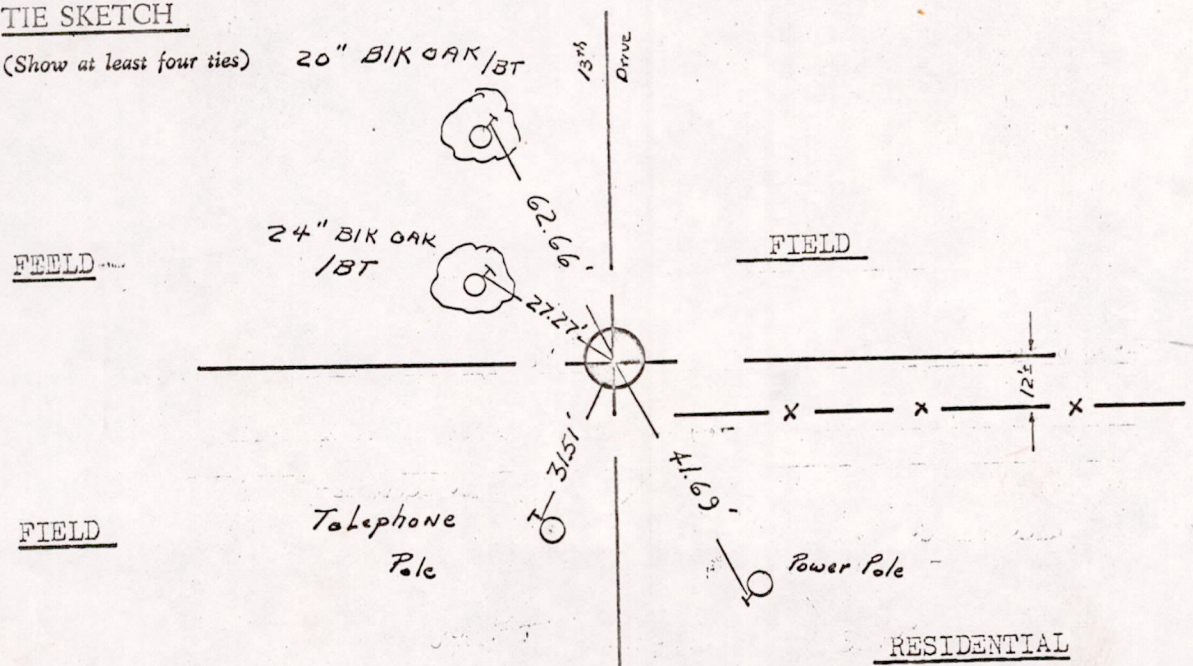

MIS31180600004