

ADAMS COUNTY

Survey Monument Record

TYPE OF MONUMENT: Harrison Std.

STATE PLANE COORDINATES: N _____
E _____

ELEVATION — M.S.L. DATUM: _____

THETA ANGLE: _____

FIELD BOOK: 107 PAGE 107

CORNER NO. 2

SECTION 2

TOWN 18

RANGE 2

29

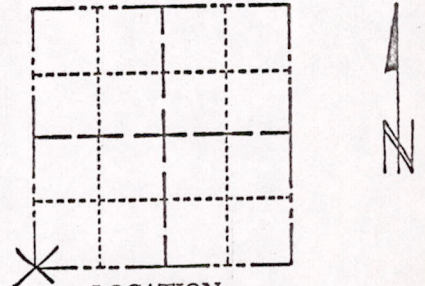

LOCATION
(Indicated by 'X')

BASIS FOR MONUMENT LOCATION

(Use reverse side if necessary)

Show info such as: History of corner, with reference to Vol. and pg. dates, surveyor; exact description of monument replaced; if location computed, by taped or EDM traverse; landowner remarks, etc.

Set on a straight line equidistant between section corners. Did not excavate because no definite place to dig.

Found railroad spike and accepted as corner after a traverse of entire section. Excavated large area with backhoe but found nothing else.

SEAL:

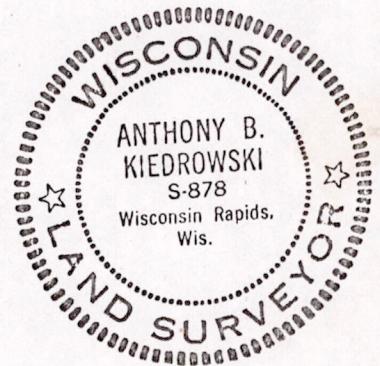

CR-55
7-24-77
OK

CERTIFIED CORRECT:

Anthony B. Kiedrowski
Registered Land Surveyor

DATE: 3/29/73

TIE SKETCH

(Show at least four ties)

Ties are to nail and disc.

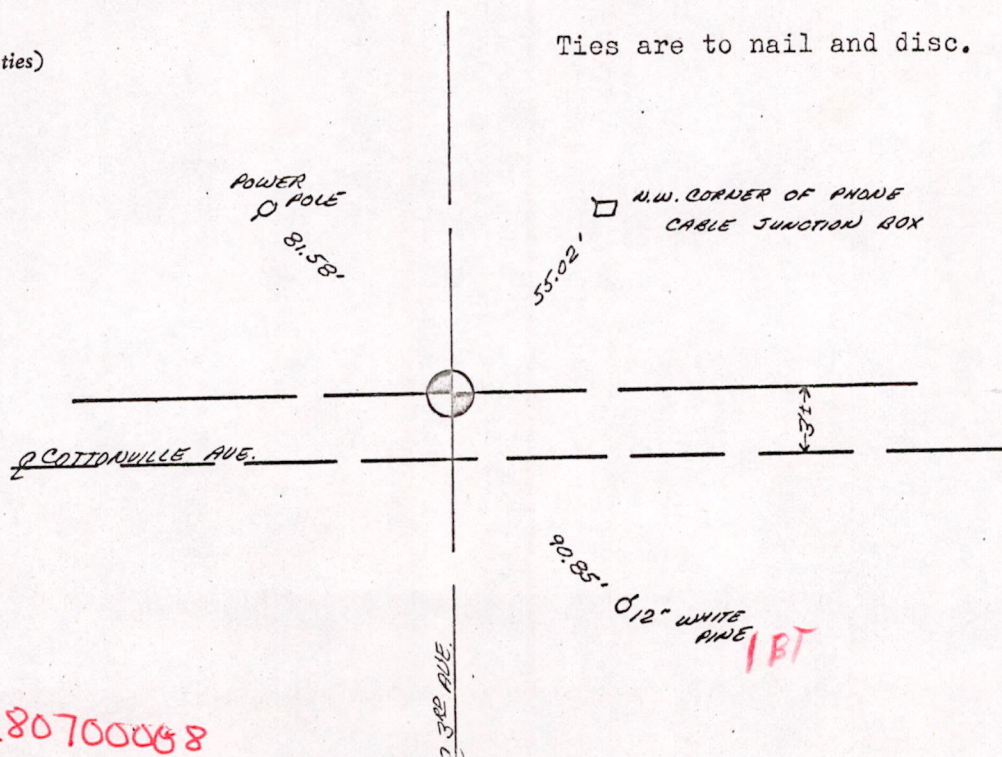

M1502180700088