

ADAMS COUNTY

Survey Monument Record

TYPE OF MONUMENT: Horizontal S.P.R.

STATE PLANE COORDINATES: N \_\_\_\_\_

E \_\_\_\_\_

ELEVATION — M.S.L. DATUM: \_\_\_\_\_

THETA ANGLE: \_\_\_\_\_

FIELD BOOK: 108 PAGE 16+49

CORNER NO. 256

SECTION: 2

TOWN: 18

RANGE: 7

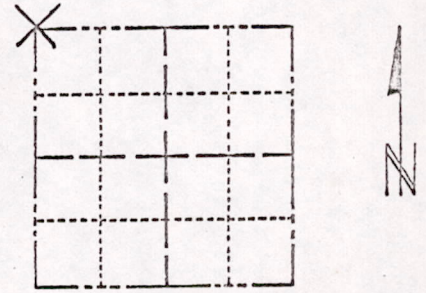

LOCATION  
(Indicated by 'X')

SEAL:

BASIS FOR MONUMENT LOCATION

(Use reverse side if necessary)

Show info such as: History of corner, with reference to Vol. and pg. dates, surveyor; exact description of monument replaced; if location computed, by taped or EDM traverse; landowner remarks, etc.

Excavated area with backhoe. Found a point that appeared to have been marked by a 2"x30" iron pipe, although the pipe was missing. Point verified by a traverse of the entire section.

3-28-77  
GR-99  
OK



CERTIFIED CORRECT:

*Anthony B. Kiedrowski*  
Registered Land Surveyor

DATE: April 73

TIE SKETCH

(Show at least four ties)

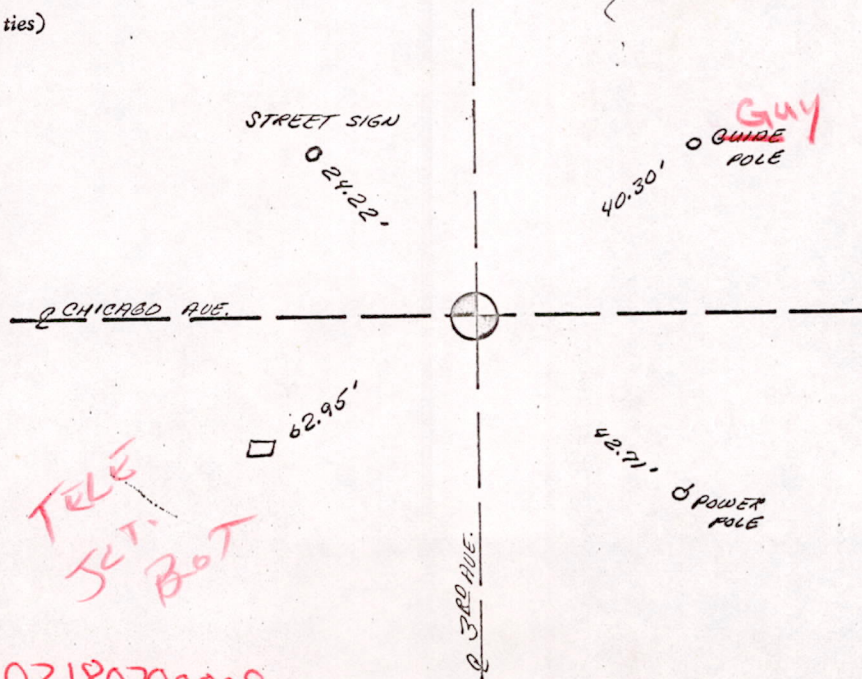

~~ALSO COR 251~~

*Handwritten notes and scribbles*

TELE SET BOT

M1502180700009