

ADAMS COUNTY

Survey Monument Record

TYPE OF MONUMENT: Harrison std.

STATE PLANE COORDINATES: N \_\_\_\_\_

E \_\_\_\_\_

ELEVATION — M.S.L. DATUM: \_\_\_\_\_

THETA ANGLE: \_\_\_\_\_

FIELD BOOK: 108 PAGE 10

CORNER NO. 264

SECTION 13

TOWN 18

RANGE 7

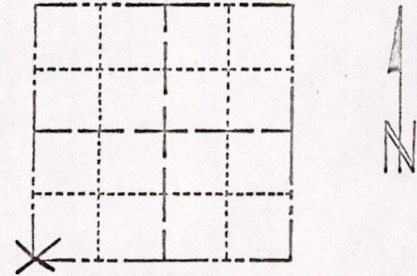

LOCATION (Indicated by 'X')

SEAL:



BASIS FOR MONUMENT LOCATION

(Use reverse side if necessary)

Show info such as: History of corner, with reference to Vol. and pg. dates, surveyor; exact description of monument replaced; if location computed, by taped or EDM traverse; landowner remarks, etc.

As the attached pictures show, we excavated sizable area before finding the stone. We were ready to give up when the oldtimer who lives in the northwest corner of this intersection came out and said he recalled seeing the stone many times, but that it was further north. A traverse of the section indicates that the stone is correct in location.

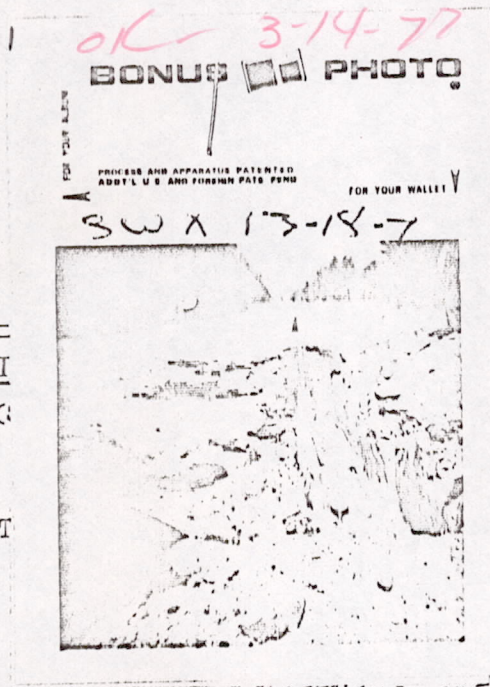

*Aug - Scott*

CERTIFIED CORRECT:

*Anthony B. Kiedrowski*  
Registered Land Surveyor

DATE: April, 73

FIGURE

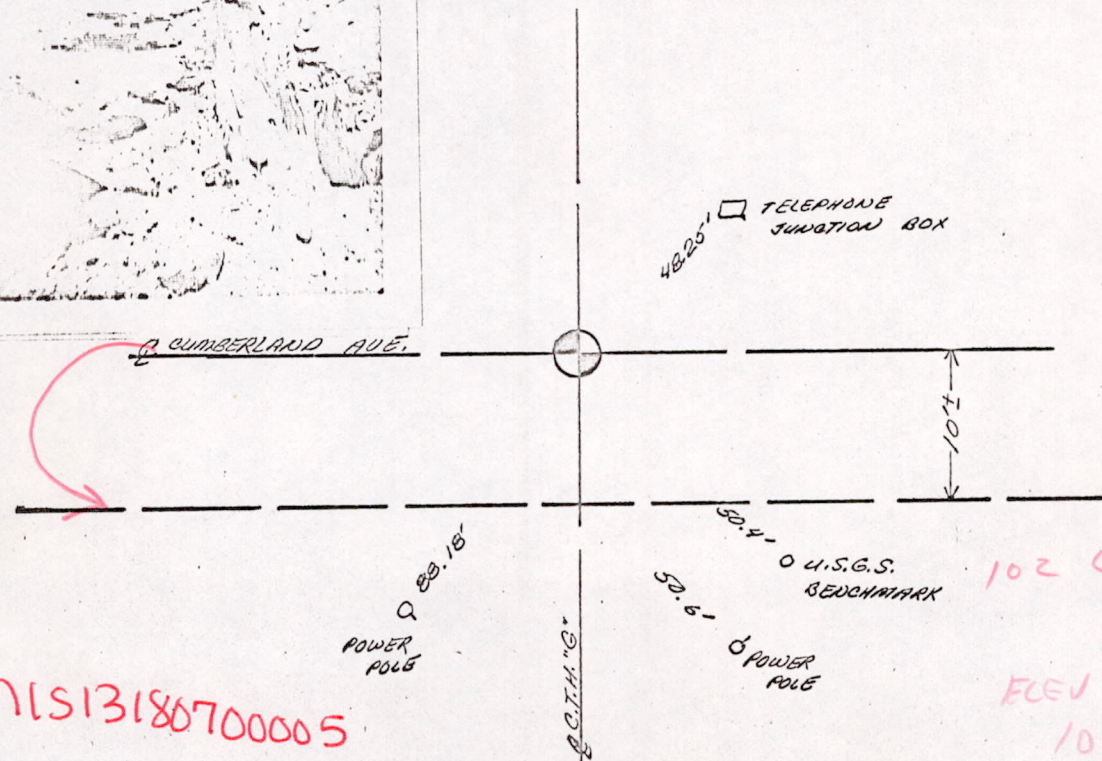

M1513180700005