

WAUSHARA COUNTY  
 CERTIFIED LAND CORNER

I, Gary E. Schindler, do hereby  
 certify that on the 15<sup>th</sup> day  
 of Oct 19 81, I found  
 (evidence) (no evidence) of the W<sup>1/2</sup>  
 corner of Sec 30, T 18 N,  
 R 8 E, Fourth Principal Meridian, and I re-  
 established said corner according to the Wis-  
 consin Statutes as shown and described hereon.

Description of corner evidence found: Road dk's

Witnesses to corner location:

Steven J. Wack

Patrick G. Krier

Dated this 15<sup>th</sup> day of Oct 1981

Gary E. Schindler  
 Waushara County Surveyor

We excavated and found no evidence  
 of previous monumentation. We  
 checked the occupied corner  
 with government distances North  
 and South. The corner fit proportionally  
 well. Monumented same

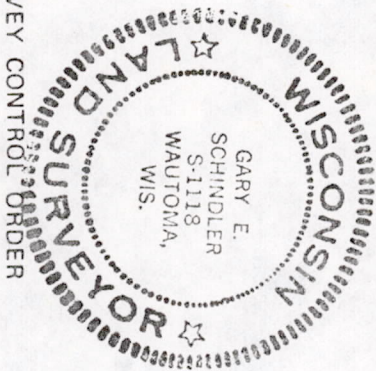

SURVEY CONTROL ORDER

Horizontal		East (X)	North (Y)	Elevation (Z)	Zone
Vertical					
Corner					
Control Sta. Name					

WISCONSIN COORDINATE SYSTEM

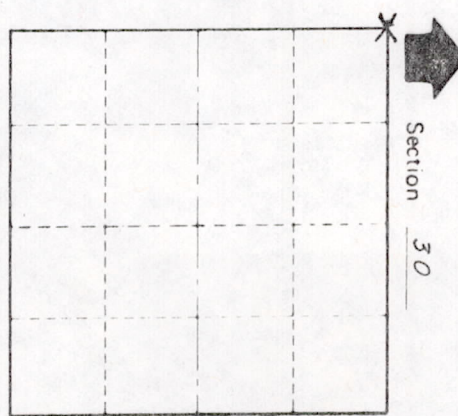
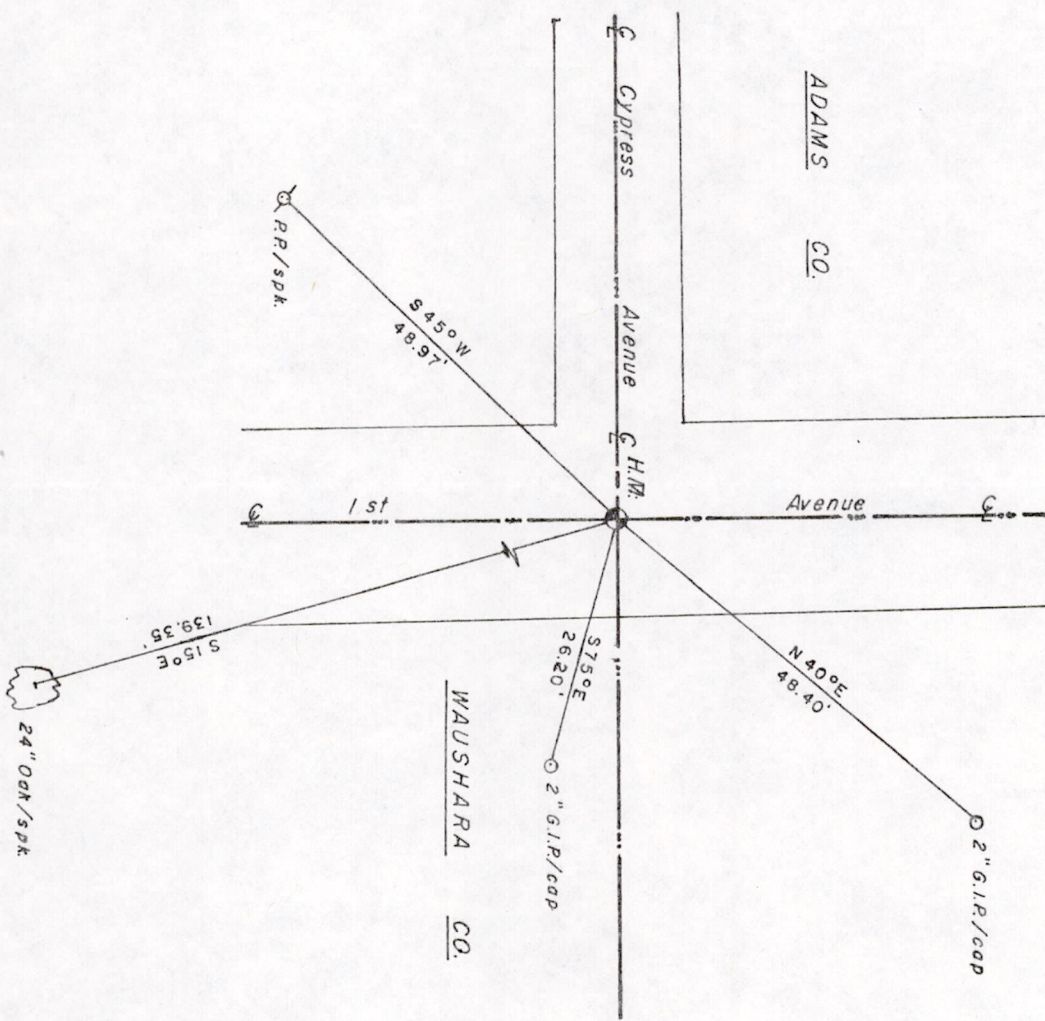

MIS25180700001  
 Approved By: \_\_\_\_\_  
 File: 25-18-7