

CERTIFICATE OF SURVEY.

STA
here
Prin
corn

STATE OF WISCONSIN, } ss. W. L. Smith Surveyor, in and for the County and State aforesaid, do
ADAMS COUNTY. }
hereby certify that I have surveyed and subdivided Section 23 Township 19 North of Range 5 East of 4th
Principal Meridian, as represented by the courses and distances on the following plat, and annexed field-notes of survey:
Established the center of the section at the point of intersection of straight quarter lines.
Established all quarter-quarter corners upon the section boundary at proportionate distances between known section and quarter section
corners, according to the original field-notes of the Government survey.
Established all lost corners at proportionate distances between known corners, according to original field-notes of the Government survey:

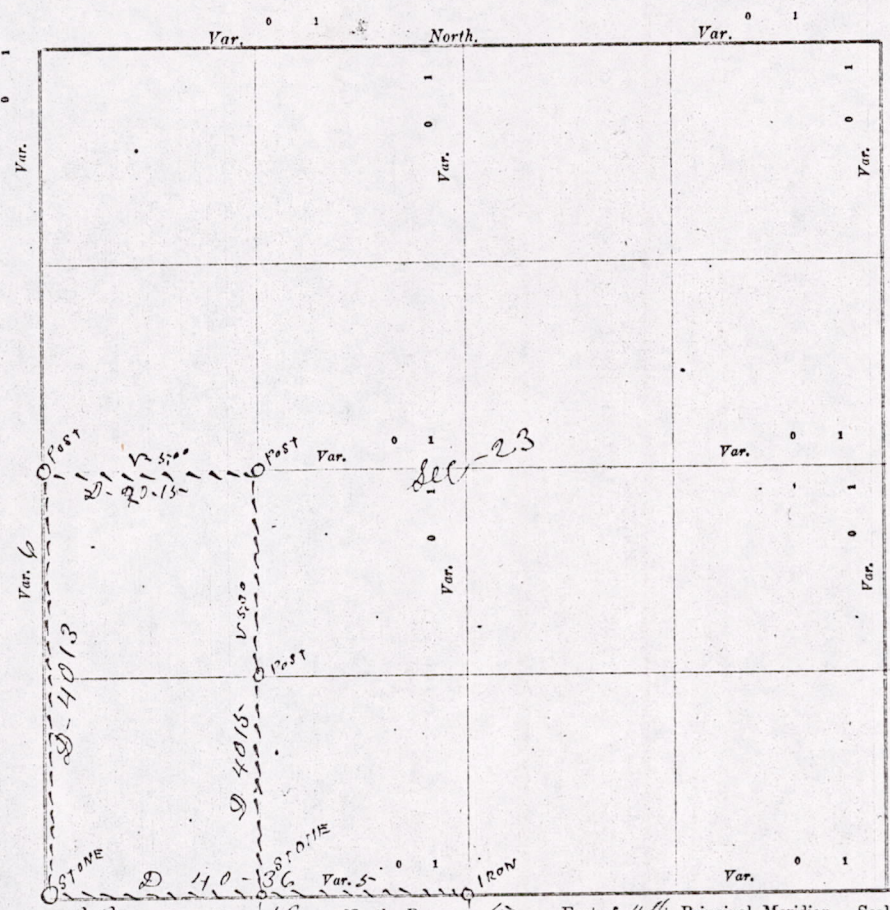

Plat of Section 23, Township 19 North, Range 5 East of 4th Principal Meridian. Scale, 80 chains to 6 inches. The figures in red ink are the lengths of the lines as stated in the field-notes of the Government survey.

Declination of the Magnetic Meridian from the True Meridian 1 1/2 East.
Surveyed and subdivided Aug 26th A. D. 1913, in accordance with the State Laws and Instructions of

the Commissioner of the General Land Office, and recorded on pages 55 of Register in the County Surveyor's office.

WITNESS my hand this 5th day of August A. D. 1913.
W. L. Smith County Surveyor.

The above was done at the request of Mr Sauer

*Offs. H.
Theo. d.*

*Shrub
near to
south
decline
40.15
40.15
20.15
then to
then to*

MIS23190500002

DESCRIPTION of Section, Quarter Section and Quarter quarter Section Corners of Section
Township North, Range East of Principal Meridian.

N. B.—The variation of needle adopted in establishing corners is _____

No.	Government Corners.	Bearing Trees.	In. dia.	Courses they bear.	Links Distant.	Bearing Trees.	In. dia.	Courses they bear.	Links Distant.
1	N. W. Sec. cor. Identified								
2	N. E. Sec. cor. Identified								
3	S. E. Sec. cor. Identified								
4	S. W. Sec. cor. Identified								
5	N. 1/4 Sec. cor. Identified								
6	E. 1/4 Sec. cor. Identified								
7	S. 1/4 Sec. cor. Identified								
8	W. 1/4 Sec. cor. Identified								
No.	SUBDIVISION CORNERS.								
1	Center 1/4 Sec. cor.								
2	North 1/4-1/4s N. W. qr.								
3	East 1/4-1/4s N. W. qr.								
4	South 1/4-1/4s N. W. qr.								
5	West 1/4-1/4s N. W. qr.								
6	Center 1/4-1/4s N. W. qr.								
7	North 1/4-1/4s N. E. qr.								
8	East 1/4-1/4s N. E. qr.								
9	South 1/4-1/4s N. E. qr.								
10	Center 1/4-1/4s N. E. qr.								
11	East 1/4-1/4s S. E. qr.								
12	South 1/4-1/4s S. E. qr.								
13	West 1/4-1/4s S. E. qr.								
14	Center 1/4-1/4s S. E. qr.								
15	South 1/4-1/4s S. W. qr.								
16	West 1/4-1/4s S. W. qr.								
17	Center 1/4-1/4s S. W. qr.								

line 12 8 24-6 113 1/2

Names of Sworn Assistants.

CHAINMEN.	FLAGMEN.	AXMEN.
<p>Otto Reise Theo Schultz</p>		

MINUTES.

Starting at the Identified S W corner of Section 23-7-19 R-5-E and ran East at 5-2-V 40 chains & 36 links to the Identified quarter Post on the south side of the section, then starting again at the S W corner of said section & ran North on the section line at 6-2-V 40 chains & 13 links to the Identified quarter Post on the west side of said section, then East on the quarter line at 5-2-V 20 chains & 15 links to a Post. Then South on the 8th line at 5-30-D-V 40 chains & 15 links to stone in center of Highway. Then South on the 8 line in section 26, 20 chains, then East 20 chains then North 20 chains to the quarter Post on the south side of section 23.

MIS 2319050000

M. L. Smith County Surveyor

section survey:

chains to 6

structions of

Surveyor.