

PLAT OF SURVEY

PART OF THE WEST HALF OF THE SOUTHWEST QUARTER OF SECTION 36,
TOWN 19 NORTH, RANGE 5 EAST, TOWN OF BIG FLATS, ADAMS COUNTY, WISCONSIN

HARRISON
MONUMENT
FOUND

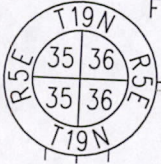

NO
MONUMENT
FOUND



NORTH LINE OF SW 1/4 OF SECTION 36 - S 89° 42' 12" E 2634.64'
1317.32'

1317.32'

24

23

22

21

20

19

18

17

16

15

14

13

12

11

10

9

8

7

6

AN OVERLAP OF 1.42' IN THE DEEDED DESCRIPTIONS OCCURS
AT THE BACK LOT CORNER BETWEEN THE TWO PARCELS.
THE NORTHERLY PARCEL HAS SENIOR RIGHTS AND RETAINS
POSSESSION OF THE OVERLAP.

S 89° 42' 12" E 1317.48'
1284.48'

263505 sq. ft.
6.05 acres

1284.59'
S 89° 42' 12" E 1317.59'

127524 sq. ft.
2.93 acres

1284.64'
S 89° 45' 55" E 1317.64'

FENCE RUNNING NORTH-SOUTH
8' EAST OF PROPERTY LINE

15th AVENUE

WEST LINE OF SW 1/4 OF SECTION 36 - N 00° 03' 45" E 2638.76'
2030.00'

EAST LINE OF WEST 1/2 OF SW 1/4 OF SECTION 36 - S 00° 01' 56" W 2637.34'

EAST LINE OF SW 1/4 OF SECTION 36 - S 00° 00' 07" W 2635.93'

PLEASANT ACRES
(unrecorded subdivision)

SURVEYOR'S CERTIFICATE

I, JAMES C. CLARKE, REGISTERED LAND SURVEYOR IN THE STATE OF WISCONSIN, HEARBY CERTIFY:

THAT I HAVE SURVEYED THE ABOVE PROPERTY DECEIBED AS LOTS 19, 20 AND 21 OF PLEASANT ACRES
AND THE ABOVE MAP IS A TRUE REPRESENTATION THEREOF, AND SHOWS THE SIZE AND LOCATION OF
THE PROPERTY, ITS EXTERIOR BOUNDRIES, THE LOCATION OF VISIBLE STRUCTURES, FENCES AND
ROADWAYS THEREON.

THIS SURVEY IS MADE FOR THE EXCLUSIVE USE OF THE PRESENT OWNERS.

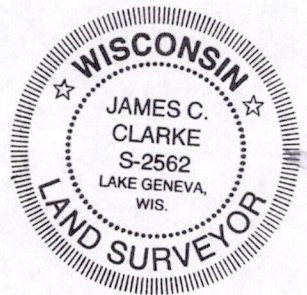

JAMES C. CLARKE
10-15-2003

HARRISON
MONUMENT
FOUND

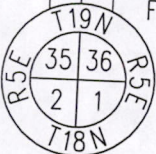

HARRISON
MONUMENT
FOUND

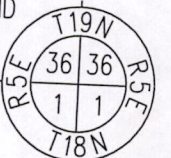

1238.70'
SOUTH LINE OF SW 1/4 OF SECTION 36 - S 89° 45' 55" E 2637.40'

1238.70'

SCALE: 1" = 200'

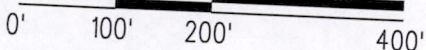

LEGEND

o - 1" x 24" IRON PIPE SET

Pos 36 190531002

