

SAM T. MULLEN  
 LAND SURVEYOR  
 Rt. 2, Friendship, Wis.  
 53934

DONALD E. HANSON  
 1721 N. 36<sup>th</sup> AVE.

STONE PARK, ILL. 60165

DESCRIPTION: PART OF THE SW  $\frac{1}{4}$  SW  $\frac{1}{4}$ , SEC. 11, T19N, R6E, TWN. OF BIG FLATS, ADAMS COUNTY, WIS.; BEING A PARCEL 16 RODS E-W BY 15 RODS N-S IN THE SW COR. OF SAID

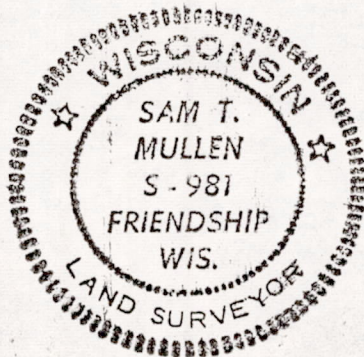
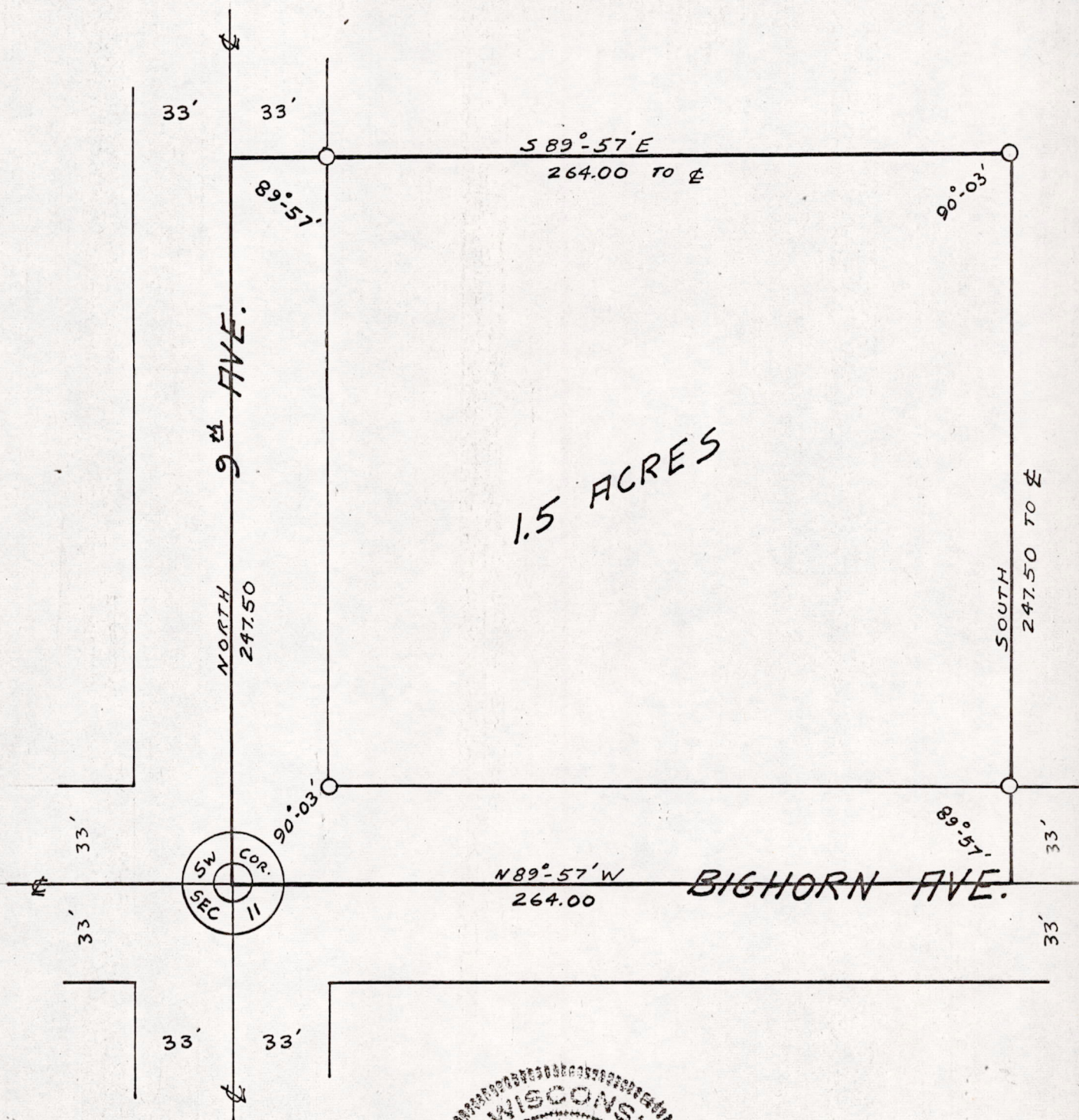

○ - IRON PIPE SET  
 SCALE: 1" = 50 FT.  
 SEPT 10, 1969

*Sam T. Mullen*  
 SAM T. MULLEN S-981

Pos 1190631001