

LEASE PARCEL

Part of the Northwest Quarter (NW1/4) of the Southwest Quarter (SW1/4) of Section Twenty-Eight (28), Township Nineteen (19) North, Range Six (6) East, Town of Big Flats, Adams County, Wisconsin containing 435,600 square feet (10.000 acres) of land and being described by:

Commencing at the West Quarter Corner of said Section 28; thence S00°-42'-36"E 605.29 feet along the West line of the SW1/4 of said Section 28; thence S89°-17'-08"E 33.01 feet to a point on the East line of 11th Avenue and the point of beginning; thence continuing S89°-17'-08"E 660.00 feet; thence S00°-42'-36"E 660.00 feet to a point on the North line of Brown Deer Lane; thence N89°-17'-08"W 660.00 feet along said North line to a point on the East line of 11th Avenue; thence N00°-42'-36"W 660.00 feet along said East line to the point of beginning; being subject to any and all easements and restrictions of record.

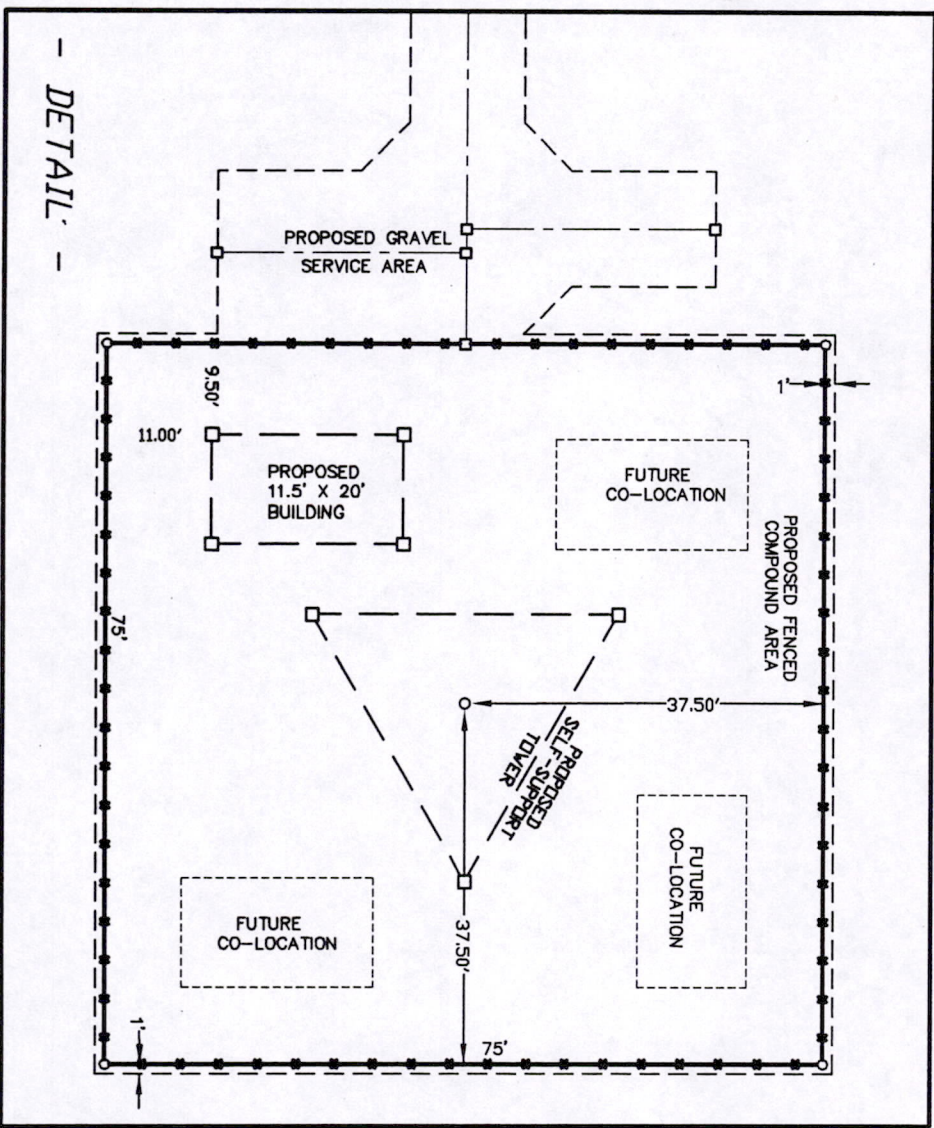
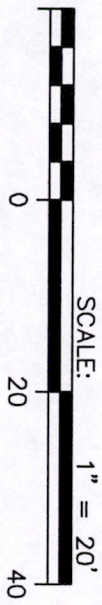

BEARINGS REFERENCED TO THE WISCONSIN STATE PLANE COORDINATE SYSTEM (NAD 83/91) - SOUTH ZONE

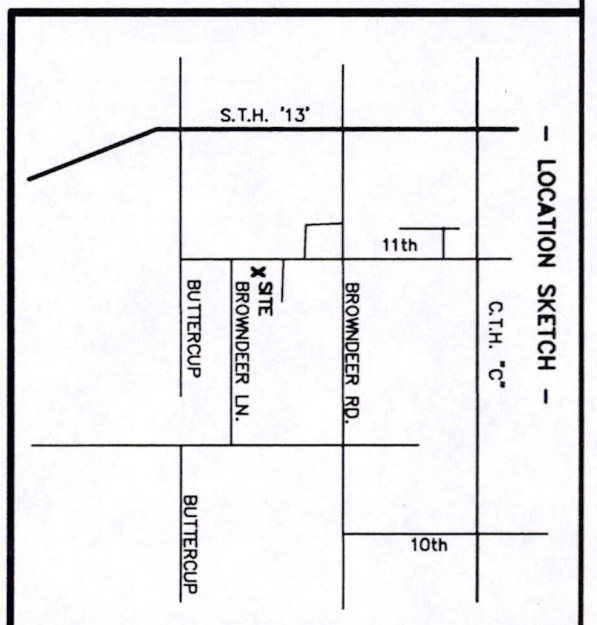

REV. DATE	REVISION DESCRIPTION

DWG. FILE: WI-IB-14	DATE: 7-3-03
PRJT. NO.: 2030625	REVISIONS:
DRAWN BY: T.R.K.	CHECKED BY: C.A.K.
NOTEBOOK: P-275	PAGE(S): 40-43
SHEET 2 OF 2	D-946

- LEGEND —
- o = 1"x24" IRON PIPE SET
 - = 1" IRON PIPE FOUND
 - Δ = 'P.K.' MASONRY NAIL SET
 - = 8" NAIL SET
 - ⊙ = COUNTY MONUMENT FOUND
 - () = RECORDED INFORMATION
 - ☒ = TELEPHONE PEDESTAL
 - ⊗ = ELECTRIC TRANSFORMER PAD
 - E-- = BURIED ELECTRIC
 - P.O.B. = POINT OF BEGINNING

I, Craig A. Keach, hereby certify that none of the property described hereon is within a flood plane or wetlands area as defined by FEMA or Wisconsin DNR.

SURVEYOR'S CERTIFICATE

I, Craig A. Keach, Wisconsin Registered Land Surveyor of Aero-Metric, Inc., certify that I have surveyed the described property and that the map shown is a true and accurate representation thereof to the best of my knowledge and belief.

Dated this 18th day of AUGUST, 2003.



Craig A. Keach
 WISCONSIN REGISTERED LAND SURVEYOR
 Craig A. Keach, S-2333

SITE NAME: FRIENDSHIP
SITE NUMBER: WI-IB-14
SITE ADDRESS: 1154 11th AVE. FRIENDSHIP, WI 53934

SITE SURVEY FOR Alltel
 A PART OF THE NW1/4 OF THE SW1/4, SECTION 28, T.19N., R.6E., TOWN OF BIG FLATS, ADAMS COUNTY, WISCONSIN

AERO-METRIC
 Aero-Metric, Incorporated
 Land Planning & Design Division
 920-849-7708 800-472-5313 FAX (849-7709)
 539 NORTH MADISON STREET CHILTON, WISCONSIN 53014