

78  
No. 310.

# CERTIFICATE OF SURVEY.

STATE OF WISCONSIN, } ss. M. C. Smith Surveyor, in and for the County and State aforesaid, do  
ADAMS COUNTY.

hereby certify that I have surveyed and subdivided Section 9 Township 20 North of Range 5 East of 4th Principal Meridian, as represented by the courses and distances on the following plat, and annexed field-notes of survey:

Established all quarter-quarter corners upon the section boundary at proportional distances between known section and quarter section corners, according to the original field-notes of the Government survey.  
Established all lost corners at proportionate distances between known corners, according to original field-notes of the Government survey:

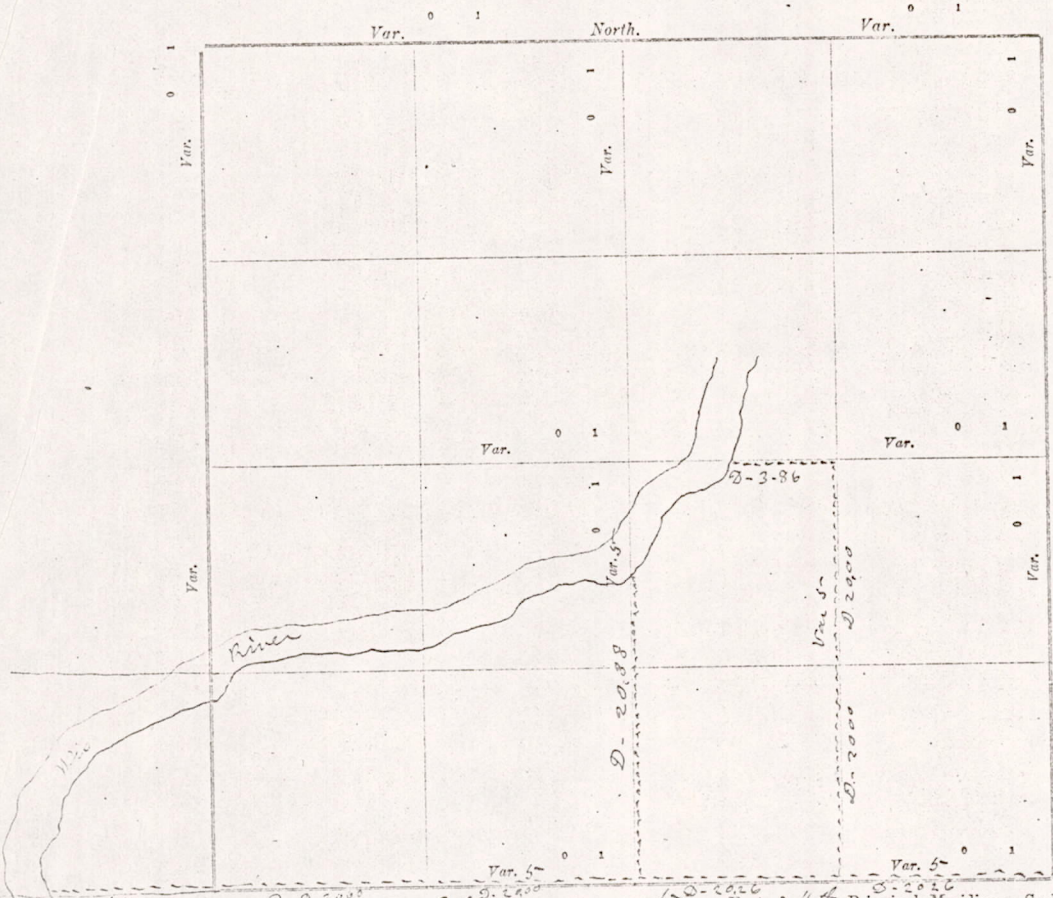

Plat of Section 9 Township 20 North, Range 5 East of 4th Principal Meridian. Scale, 80 chains to 6 inches. The figures in red ink are the lengths of the lines as stated in the field-notes of the Government survey.

Declination of the Magnetic Meridian from the True Meridian \_\_\_\_\_ East.  
Surveyed and subdivided the 27 day of Jan A. D. 1908, in accordance with the State Laws and Instructions of the Commissioner of the General Land Office, and recorded on pages \_\_\_\_\_ of Register in the County Surveyor's office.  
WITNESS my hand this 27 day of Jan A. D. 1908.  
M. C. Smith Surveyor.

*The above work was done for Mr Sweet*

No.	DESCR	Town	N. B. The
1	N. W.		
2	N. E.		
3	S. W.		
4	S. E.		
5	N. W.		
6	N. E.		
7	S. W.		
8	S. E.		
9	N. W.		
10	N. E.		
11	S. W.		
12	S. E.		
13	N. W.		
14	N. E.		
15	S. W.		
16	S. E.		
17	N. W.		

*W. C. Thomas*

*Section 9  
west side of  
south river  
21 chains  
square  
and set  
9 and  
line  
and all*

MIS09200500001

DESCRIPTION of Section, Quarter Section and Quarter quarter Section Corners of Section

Township \_\_\_\_\_ North, Range \_\_\_\_\_ East of \_\_\_\_\_ Principal Meridian.

N. B.—The variation of needle adopted in establishing corners is \_\_\_\_\_

No.	Government Corners.	Bearing Trees.	In. dia.	Courses they bear.	Links Distant.	Bearing Trees.	In. dia.	Courses they bear.	Links Distant.
1	N. W. Sec. cor. Identified								
2	N. E. Sec. cor. Identified								
3	S. E. Sec. cor. Identified								
4	S. W. Sec. cor. Identified								
5	N. $\frac{1}{4}$ Sec. cor. Identified								
6	E. $\frac{1}{4}$ Sec. cor. Identified								
7	S. $\frac{1}{4}$ Sec. cor. Identified								
8	W. $\frac{1}{4}$ Sec. cor. Identified								
SUBDIVISION CORNERS.									
1	Center $\frac{1}{4}$ Sec. cor.								
2	North $\frac{1}{4}$ - $\frac{1}{4}$ s N. W. qr.								
3	East $\frac{1}{4}$ - $\frac{1}{4}$ s N. W. qr.								
4	South $\frac{1}{4}$ - $\frac{1}{4}$ s N. W. qr.								
5	West $\frac{1}{4}$ - $\frac{1}{4}$ s N. W. qr.								
6	Center $\frac{1}{4}$ - $\frac{1}{4}$ s N. W. qr.								
7	North $\frac{1}{4}$ - $\frac{1}{4}$ s N. E. qr.								
8	East $\frac{1}{4}$ - $\frac{1}{4}$ s N. E. qr.								
9	South $\frac{1}{4}$ - $\frac{1}{4}$ s N. E. qr.								
10	Center $\frac{1}{4}$ - $\frac{1}{4}$ s N. E. qr.								
11	East $\frac{1}{4}$ - $\frac{1}{4}$ s S. E. qr.								
12	South $\frac{1}{4}$ - $\frac{1}{4}$ s S. E. qr.								
13	West $\frac{1}{4}$ - $\frac{1}{4}$ s S. E. qr.								
14	Center $\frac{1}{4}$ - $\frac{1}{4}$ s S. E. qr.								
15	South $\frac{1}{4}$ - $\frac{1}{4}$ s S. W. qr.								
16	West $\frac{1}{4}$ - $\frac{1}{4}$ s S. W. qr.								
17	Center $\frac{1}{4}$ - $\frac{1}{4}$ s S. W. qr.								

NAMES OF SWORN ASSISTANTS.

CHAINMEN.	FLAGMEN.	AXMEN.
W. C. Sweet Thomas Peterson		

MINUTES.

Beginning at stone the identified south east corner of section 9 and ran west at 5-D-V 40 chains & 52 links to the identified quarter Post on south side of section 9 - stone, (also see Bearings) Then west 40 chains to the southwest corner of said section (stone) but no trees given in Gov notes. Then 21 chains & 14 links to meander Post N<sup>o</sup> 8, on river bank. Then north from meander Post on south side of section 9 at 5-D-V 20 chains & 38 links to river bank and set Post. Then starting at the 8<sup>th</sup> Post on section line of south side of section 9 and ran North on the 8<sup>th</sup> line 40 chains to the East and west meander line through section 9 and set Post. Then west 3 chains & 86 links to river bank and set Post.

W. C. Sweet Co Surveyor

MISO9200500001