

CERTIFICATE OF SURVEY.

STATE OF WISCONSIN, }
ADAMS COUNTY. }

Wm. L. Smith Surveyor, in and for the County and State aforesaid, do hereby certify that I have surveyed and subdivided Section 10 Township 20 North of Range 6 East of 4 Principal Meridian, as represented by the courses and distances on the following plat, and annexed field-notes of survey:

- Established the center of the section at the point of intersection of *straight* quarter lines.
- Established all quarter-quarter corners upon the section boundary at proportional distances between known section and quarter section corners, according to the original field-notes of the Government survey.
- Established all lost corners at proportionate distances between known corners, according to original field-notes of the Government survey;

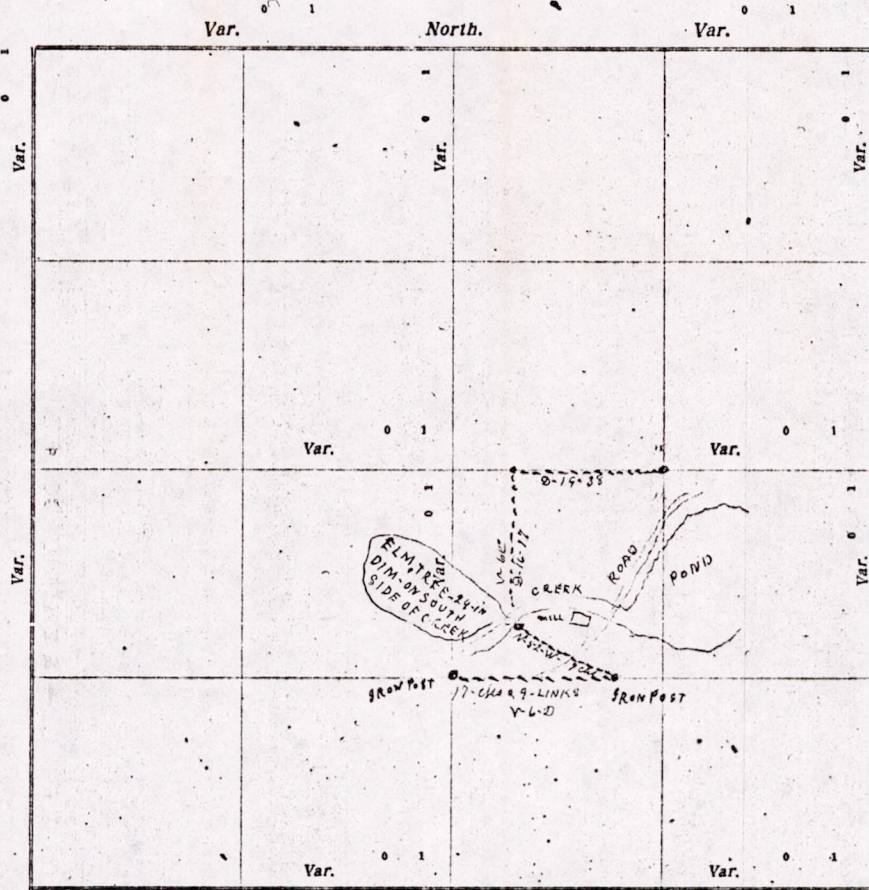

Plat of Section 10; Township 20 North, Range 6 East of 4th Principal Meridian. Scale, 80 chains to 6 inches. The figures in red ink are the lengths of the lines as stated in the field-notes of the Government survey.

Declination of the Magnetic Meridian from the True Meridian _____ East.

Surveyed and subdivided this 31st day of October A. D. 1914, in accordance with the State Laws and Instructions of the Commissioner of the General Land Office, and recorded on pages _____ of Register in the County Surveyor's office.

WITNESS my hand this 31st day of October A. D. 1914.

Wm. L. Smith Surveyor.

The above work was done at the request of J. E. Davis

MIS10200500001

DESCRIPTION of Section, Quarter Section and Quarter-quarter Section Corners of Section 1

Township _____ North, Range _____ East of _____ Principal Meridian.

N. B.—The variation of needle adopted in establishing corners is _____

No.	Government Corners	Bearing Trees	In. dia.	Courses they bear	Links Distant	Bearing Trees	In. dia.	Courses they bear	Links Distant
2	N. W. Sec. cor. Identified								
3	N. E. Sec. cor. Identified								
4	S. E. Sec. cor. Identified								
5	S. W. Sec. cor. Identified								
6	N. $\frac{1}{4}$ Sec. cor. Identified								
7	E. $\frac{1}{4}$ Sec. cor. Identified								
8	S. $\frac{1}{4}$ Sec. cor. Identified								
9	W. $\frac{1}{4}$ Sec. cor. Identified								
SUBDIVISION CORNERS.									
1	Center $\frac{1}{4}$ Sec. cor.								
2	North $\frac{1}{4}$ - $\frac{1}{4}$ s N. W. qr.								
3	East $\frac{1}{4}$ - $\frac{1}{4}$ s N. W. qr.								
4	South $\frac{1}{4}$ - $\frac{1}{4}$ s N. W. qr.								
5	West $\frac{1}{4}$ - $\frac{1}{4}$ s N. W. qr.								
6	Center $\frac{1}{4}$ - $\frac{1}{4}$ s N. W. qr.								
7	North $\frac{1}{4}$ - $\frac{1}{4}$ s N. E. qr.								
8	East $\frac{1}{4}$ - $\frac{1}{4}$ s N. E. qr.								
9	South $\frac{1}{4}$ - $\frac{1}{4}$ s N. E. qr.								
10	Center $\frac{1}{4}$ - $\frac{1}{4}$ s N. E. qr.								
11	East $\frac{1}{4}$ - $\frac{1}{4}$ s S. E. qr.								
12	South $\frac{1}{4}$ - $\frac{1}{4}$ s S. E. qr.								
13	West $\frac{1}{4}$ - $\frac{1}{4}$ s S. E. qr.								
14	Center $\frac{1}{4}$ - $\frac{1}{4}$ s S. E. qr.								
15	South $\frac{1}{4}$ - $\frac{1}{4}$ s S. W. qr.								
16	West $\frac{1}{4}$ - $\frac{1}{4}$ s S. W. qr.								
17	Center $\frac{1}{4}$ - $\frac{1}{4}$ s S. W. qr.								

NAMES OF SWORN ASSISTANTS.

CHAINMEN	FLAGMEN	AXMEN
G. E. Davis Gloyd Davis		

MINUTES.

Commencing at an Iron Post at the southwest corner of the NW 1/4 of Sec. 10-20-R-5-E, and ran East on the 8th line at a N. of 82 degrees, 17 chains & 9 links, to Iron Post set on Top of Bank, then N. 82 degrees, 17 chains to an Elm tree 24 inches through on the south bank of the creek, then from said Elm tree North at G-D-V. 16 chains & 77 links, to Post on the East and West quarter line. said post is 19 chains & 38 links west from the north East corner of said forty.

MLS10200500001

W. L. Smith county Surveyor