

MORTGAGE INSPECTION

NOTE: THIS INSPECTION IS NOT INTENDED TO BE A SURVEY OF THE PREMISES. THIS INSPECTION IS FOR THE CLIENTS INFORMATION AND IS NOT TO BE USED FOR NEW CONSTRUCTION OR OTHER PURPOSES. ALL LOT LINE DISTANCES SHOWN ARE TAKEN FROM THE DEED FURNISHED BY THE CLIENT.

CLIENT: ADAMS FRIENDSHIP TITLE CO.

OWNER: JOAN B. CURYLO

LENDER: NATIONAL CITY MORTGAGE

BUYER: N/A

LOCATION: LOT 400, KINGSWOOD ADD'N TO ROYAL CREST

TOWN OF ROME

SECTION 14 T 20 N R 5 E

CITY OF N/A

COUNTY ADAMS

VILLAGE OF N/A

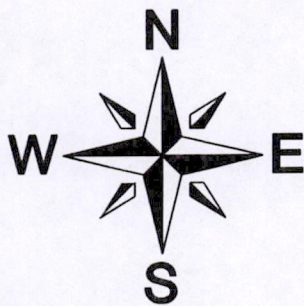

SCALE: 1" = 40'

O.L. 5

399

KINGSWOOD

232.30' +/-

WELL

FNDN. UNDER CONSTRUCTION

102.06' +/-

401

296' +/-

400

NOTE: SEPTIC SYSTEM NOT IN PLACE AT TIME OF THIS INSPECTION.

KINGSWOOD TRAIL
 (NOW LAKE ARROWHEAD)
 R. = 1000'
 CH. = 100.96' +/-

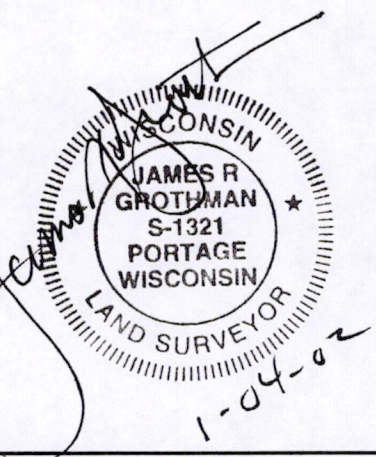

As prepared by:
GROTHMAN & ASSOCIATES, S.C.
 LAND SURVEYORS

SURVEYOR
JAMES R. GROTHMAN
 625 E. SLIFER ST.
 PORTAGE, WI 53901

LEGEND
 ● 3/4" REBAR FND.

DRAFTED BY: _____ PAGE 1 OF 1
 CHECKED BY: JRG FILE NO. _____

Copy

Phone (608) 742-7788
 Fax (608) 742-0434
 PO BOX 373 PORTAGE, WI 53901

Pos 14200541001

DESCRIPTION

Lot 400 in Kingswood Addition to Royal Crest, (now Lake Arrowhead). All being in the Town of Rome, County of Adams, State of Wisconsin.

SURVEYOR'S CERTIFICATE

I, **JAMES R. GROTHMAN**, Registered Land Surveyor in the State of Wisconsin, **DO HEREBY CERTIFY** that I have inspected the above described property and that I have mapped the property according to the official records and that I have mapped the locations of all visible structures, the dimensions of all principal buildings, roadways, apparent easements and visible encroachments, if any. This mortgage inspection has been prepared in accordance with the requirements of **Adams Friendship Title Company** and under the agreement between **GROTHMAN & ASSOCIATES, S.C.** and **Adams Friendship Title Company** which provides that this mortgage inspection complies with all of the requirements of Section AE 7.01 Wisconsin Administrative Code. Therefore all of the requirements of Section AE 7.01 have been complied with. The mortgage inspection is made for the exclusive use of **Adams Friendship Title Company** and its insurees and for the period of one year from date hereof and as to them I certify the accuracy of said mortgage inspection as shown.

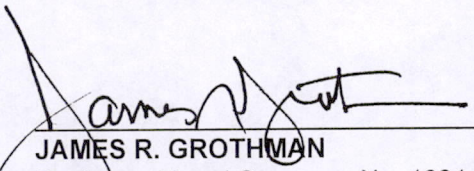

JAMES R. GROTHMAN
Registered Land Surveyor, No. 1321
Dated: January 4, 2002



POS14200541001