

A PARCEL OF LAND
 LOCATED IN THE
 NW $\frac{1}{4}$ -NW $\frac{1}{4}$ SEC. 14.
 T20N, R6E, TN. OF
 ROME, ADAMS CO., WIS.

MID-STATE ASSOCIATES
 206 BROADWAY
 BARABOO, WIS.

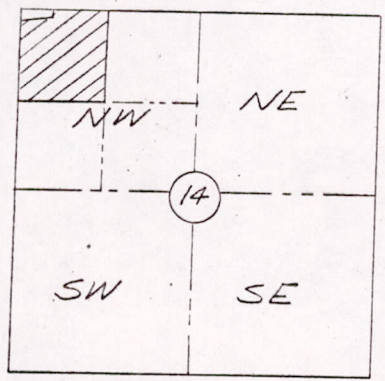

-LOCATION SKETCH-

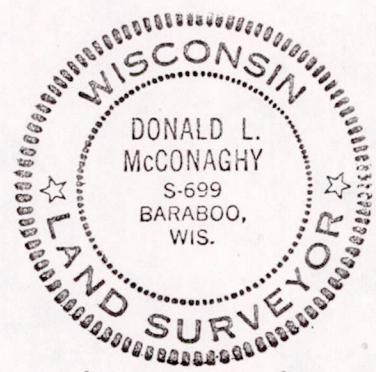

Donald L. McConaghy

DESCRIPTION OF LANDS
 TO BE PURCHASED BY
 N.E. ISAACSON & ASSOCIATES, INC.

The NW $\frac{1}{4}$ -NW $\frac{1}{4}$ of Section 14, T20N, R6E, Town of Rome, Adams County, Wisconsin, EXCEPTING The following described parcel:

Beginning at the northwest corner of Section 14; thence N 89°53' E, 537.26 feet along the north line of Section 14 to a North-South fence line; thence South, along said fence 83.31 feet; thence S 85°51' W, 539.02 feet along existing fence row to the west line of Section 14; thence N 0-10' E, 121.30 feet along said west line to the point of beginning.

Subject to existing right-of-way for 9th Avenue. This exception to the NW $\frac{1}{4}$ -NW $\frac{1}{4}$ contains 1.26 acres more or less.

Pos 14200621007