

BADGER - LAND SURVEYING INC.

2610 WEST GRAND AVE.
WISCONSIN RAPIDS, WI. 54495

© 2003, BADGER-LAND SURVEYING, INC.

PHONE: (715) 424 - 5900
FAX: (715) 424 - 5901
E-MAIL: blsurvey@wctc.net

IF THE SURVEYORS SEAL IS NOT RED IN COLOR, THIS MAP IS A COPY AND SHOULD BE ASSUMED TO CONTAIN UNAUTHORIZED ALTERATIONS. THE CERTIFICATION DOES NOT APPLY TO COPIES.

PREPARED FOR:

JAMES KNIGHT
840 MANCHESTER COURT
NEKOOSA, WI 54457

DRAWN BY: KW

JOB#: 71903

PLAT OF SURVEY

noise

BEING THE WEST LINE OF LOT 19 OF MANCHESTER ADDITION TO LAKE CAMELOT, LOCATED IN PART OF THE SE1/4 SECTION 14, TOWN 20 NORTH, RANGE 6 EAST, TOWN OF ROME, ADAMS COUNTY, WISCONSIN, ALSO BEING PART OF LOT 1 OF ADAMS COUNTY CERTIFIED SURVEY MAP NO. 2106.

LAKE CAMELOT

1" O.D. X 18" IRON PIPE SET (1.13#/FT)

SCALE: 1" = 40'

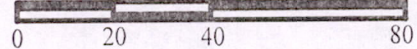

N 25° 59' 55" W
105.30'

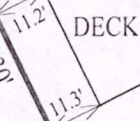

3/4" IRON ROD FOUND

LOT - 18

N 26° 00' 00" W
191.95'
(191.89')

LOT - 19

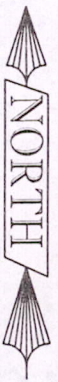

CERTIFICATION:

I hereby certify that I have surveyed the above described property and that the above map is a true representation thereof and shows the size and location of the property line.

CERTIFIED CORRECT THIS 29th DAY OF July, 2003

Wayne Basler 7-29-03

WAYNE BASLER R.L.S. 1167
Drafted By: KEVIN WHIPPLE

3/4" IRON ROD FOUND

33' 1.33' MANCHESTER COURT 33' 1.33'



Post 42006 41004