

BADGER - LAND SURVEYING, INC.

2610 WEST GRAND AVE. WISCONSIN RAPIDS, WI. 54495

(715) 424-5900 FAX (715) 424-5901 E-mail blsurvey@wctc.net

PREPARED FOR: **TODD MANTES**
S. 78 W.32157 MARK LANE
MUKWONAGO, WI 53149

JOB#: 72901

DRAWN BY: JC

© 2001. BASLER LAND SURVEYING

IF THE SURVEYORS SEAL IS NOT RED IN COLOR, THIS MAP IS A COPY AND SHOULD BE ASSUMED TO CONTAIN UNAUTHORIZED ALTERATIONS. THE CERTIFICATION DOES NOT APPLY TO COPIES.

PLAT OF SURVEY

BEING THE WEST LINE OF LOT-34 OF DOVER ADDITION TO LAKE CAMELOT, LOCATED IN SECTION 15, TOWN 20 NORTH, RANGE 6 EAST, TOWN OF ROME, ADAMS COUNTY, WISCONSIN.

www

SCALE: 1" = 60'

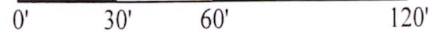

KINGS WAY

33

34

35

SEE DETAIL

N 25° 43' 35" W
230.63
(231.26)

⊗ 2" IRON PIPE FOUND
◇ LATH SET
() RECORDED AS

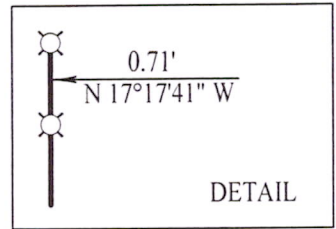

DETAIL

WATERS EDGE AS OF 72901.

LAKE CAMELOT



CERTIFICATION:

I HEREBY CERTIFY THAT I HAVE SURVEYED THE ABOVE DESCRIBED PROPERTY AND THAT THE ABOVE MAP IS A TRUE REPRESENTATION THEREOF AND SHOWS THE SIZE AND LOCATION OF PROPERTY, ITS EXTERIOR BOUNDARIES, THE LOCATION OF ALL VISIBLE STRUCTURES THEREON, BOUNDARY FENCES, APPARENT EASEMENTS, ROADWAYS AND VISIBLE ENCROACHMENTS, IF ANY. THIS SURVEY IS MADE FOR THE USE OF THE PRESENT OWNERS OF THE PROPERTY, AND THOSE WHO PURCHASE, MORTGAGE, OR GUARANTEE TITLE THERETO WITHIN ONE YEAR FROM THE DATE HEREOF.

CERTIFIED CORRECT THIS 6th DAY OF August, 2001.

Wayne Basler
WAYNE BASLER R. L. S. 1167
DRAFTED BY : JOSH CALAWAY

Pos 15200621004