

FIELD BOOK # FILE DRAWN BY GPR PROJECT # R04980000
 PAGES # FILE CHECKED BY EJS SHEET # 1 OF 1



PROFESSIONAL SERVICES
 TRANSPORTATION • MUNICIPAL
 DEVELOPMENT • ENVIRONMENTAL

CLIENT:

LOREN GOSTOMSKI
 1014 LONG BOW COURT
 NEKOOSA, WI 54457

PLAT OF SURVEY

LOT 1, ADAMS COUNTY CERTIFIED SURVEY MAP NO 602,
 PART OF THE SOUTHEAST QUARTER OF THE SOUTHEAST QUARTER
 SECTION 16, TOWNSHIP 20 NORTH, RANGE 6 EAST, TOWN OF ROME,
 ADAMS COUNTY, WISCONSIN.

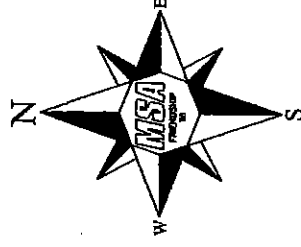

LAKE SHERWOOD

AREA
 27600± Sq. Feet
 0.63± Acres
 TO MEANDER LINE
 19678 Sq. Feet
 0.45 Acres

(N 86°18'00" E 125.00')
 MEANDER LINE
 (N 86°12'11" E 125.54')

LOT 1, CSM NO 602

LOT 2, CSM NO 602,

(S 08°22'30" E 176.13')
 S 08°33'20" E 211'±
 176.44'

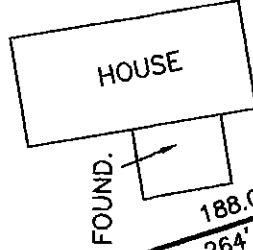

FOUND.
 188.08'

(N 18°06'15" W 264'±
 (N 17°47'41" W 187.58')

- LEGEND**
- - 2" IRON PIPE, FOUND
 - - 1" IRON ROD, FOUND
 - - PK NAIL, PLACED IN BIT.
 - (RECORD DIMENSION)

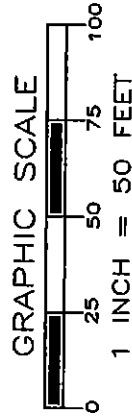

LOT 6, LONG BOW
 ADDITION TO LAKE SHERWOOD

(66.00')
 66.03'
 C1 S 83°03'22" W
 (S 83°09'00" W)
 33'
 33'

LONG BOW COURT

SURVEYOR'S SEAL

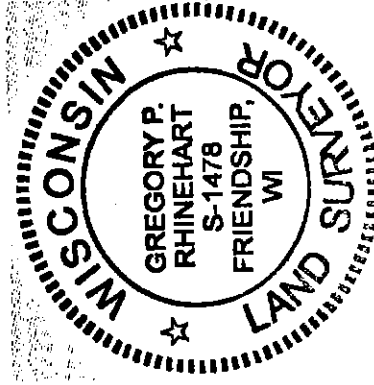

THE EAST LINE OF LOT 1, CSM NO 602
 WAS ASSIGNED A BEARING OF S08°33'20"E AS THE
 BASIS OF BEARINGS ON THIS MAP.

CURVE	ARC LENGTH	RADIUS	DELTA ANGLE	CHORD BEARING	CHORD LENGTH
C1	27.91'	316.00'	5°03'43"	S 80°27'58" W	27.91'
C2	161.99'	316.00'	29°22'18"	S 63°14'58" W	160.22'

Gregory P. Rhinehart
 MSA PROFESSIONAL SERVICES
 GREGORY P. RHINEHART, PROFESSIONAL LAND SURVEYOR, S-1478

DATE

9/19/2016

NOTE: IF THE SURVEYOR'S SEAL AT LEFT IS NOT RED IN COLOR, THE SURVEY
 IS A COPY AND SHOULD BE ASSUMED TO CONTAIN UNAUTHORIZED ALTERATIONS.
 THE CERTIFICATION CONTAINED ON THIS DOCUMENT SHALL NOT APPLY TO COPIES.

POS16200641015