

31 SECTION 15 TOWN 06 RANGE

ADAMS COUNTY

COUNTY CORNER NO: 122
ROMPORTOL ID: 41506310020

PUBLIC LAND SURVEY MONUMENT RECORD

TYPE OF MONUMENT: HARRISON
ADAMS COUNTY COORDINATES, NAD 83 (2007)

N. 132918.942

E. 528739.146

ELEVATION- DATUM

FIELD WORK DATE: 10/31/2017

BASIS FOR MONUMENT LOCATION

1976 - PLS 1191 RESEARCHED GOV'T AND COUNTY SURVEYOR'S RECORD. FOUND NOTHING ON RECORD AS CORNER BEING SET. FOUND SURVEY FROM 1874 BY WISE, IN VOL. 2, PG. 110. FOUND EVIDENCE OF THE FIRST BEARING TREE, A ROTTEN STUMP THAT FIT THE FENCE CORNER FOR BEARING AND DISTANCE. ALSO FOUND A 3/4" X 24" ROD AT THE FENCE CORNER FROM ELMEN OWENS SURVEY PROJECT # 6314. SET A HARRISON MONUMENT AT THE CORNER LOCATION AND TIED OUT.

2017 - PLS 2994 FOUND A HARRISON MONUMENT FLUSH WITH THE GROUND SURFACE AND 2 WITNESS TREES. THE MONUMENT AGREES WITH THE EXISTING WITNESS TREES. ACCEPTED THE HARRISON MONUMENT AS THE CORNER LOCATION. SET 4 NEW TIES AND MEASURED TO THE TIES AND WITNESS TREES.

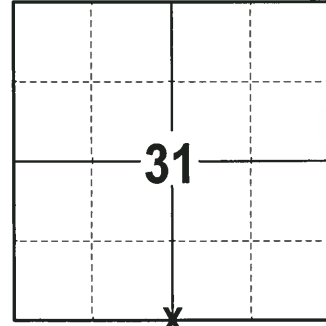

LOCATION
(INDICATE CORNER BY "X")

SEAL:

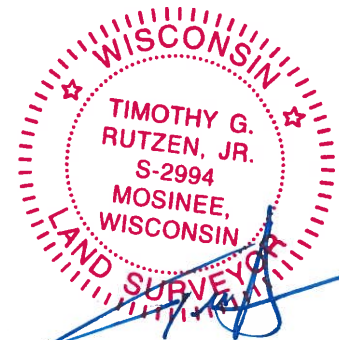

DATA SHOWN HERE ON THIS TIE SHEET IS CORRECT AND COMPLETE TO THE BEST OF MY KNOWLEDGE AND BELIEF.

PROFESSIONAL LAND SURVEYOR

DATE 11-15-17

- TIE SKETCH -

NOTE: THE CORNER FALLS 31'± NORTHEAST OF THE CENTERLINE OF THE TRAIL.

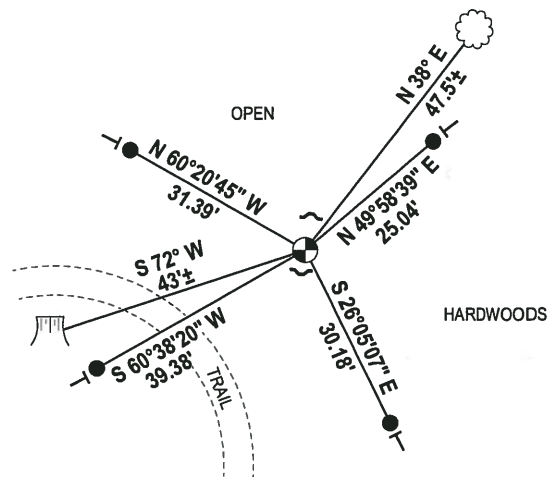
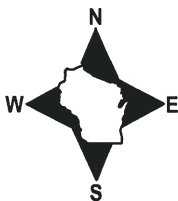

- 3/4" x 18" IRON REBAR SET, 1.50#/FT
- ⊙ HARRISON FOUND
- ~ STEEL FENCE POST
- └ VINYL "T" POST
- ▣ WITNESS TREE STUMP FOUND
- ☁ WITNESS TREE FOUND

ADAMS COUNTY

Survey Monument Record

TYPE OF MONUMENT: HARRISON
 STATE PLANE COORDINATES: N _____
 E _____
 ELEVATION — M.S.L. DATUM: _____
 THETA ANGLE: _____
 FIELD BOOK: 510 PAGE 42

CORNER NO. 986
 SECTION 6
 TOWN 14 N
 RANGE 6 E

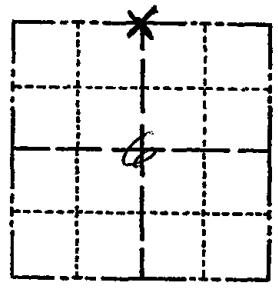

LOCATION
(Indicated by 'X')

BASIS FOR MONUMENT LOCATION

(Use reverse side if necessary)

Show info such as: History of corner, with reference to Vol. and pg. dates, surveyor; exact description of monument replaced; if location computed, by taped or EDM traverse; landowner remarks, etc.

SEAL:



Researched Gov't & COUNTY SURVEYOR'S RECORDS. Found NOTHING ON RECORD AS BEING SET. Found Survey made in 1874 by Wise in Vol. 2, Pg. 110 BIK Pine 16" N9°E 37 links
 " " 15" S34½°W 23 links
 Found evidence of first Bearings tree above mentioned from ROTTED STUMP that fit the fence corner for bearings & distance. Also found ¾x24" Rod at fence corner from Elmer Owens survey Proj #6314 SET HARRISON MONUMENT AT THIS LOCATION

CERTIFIED CORRECT:

Allen D. Rohde
 Registered Land Surveyor

DATE: 6-7-76

Tape Traverse

CORNER O.K. 12/22/81 D.W.-SK

TIE SKETCH CORNER OK 10-29-90 JG

(Show at least four ties) 2-GONE, 2-NEW TIES, MON. DK 3-7-01 JG-MH

