

03
SECTION

14
TOWN

06
RANGE

ADAMS COUNTY

COUNTY CORNER NO: 18
ROMPORTOL ID: 41406032000

PUBLIC LAND SURVEY MONUMENT RECORD

TYPE OF MONUMENT: HARRISON
ADAMS COUNTY COORDINATES, NAD 83 (2007)

N. 129419.840

E. 547057.117

ELEVATION- _____ DATUM _____

FIELD WORK DATE: 12/15/2020

BASIS FOR MONUMENT LOCATION

1975 - PLS 922 RECOVERED RAILROAD SPIKE, FOUND BY DAVE CLARK AND DEAN JESSE, USED BY THEM FOR 1/4 CORNER FOR VARIOUS SURVEYS IN 1970-1972, FIT TRAVERSE. TAPE TRAVERSE OF SECTION GOOD. CHECKED COUNTY SURVEY RECORDS AND NO OTHER WERE ON FILE.

2020 - PLS 2675 FOUND HARRISON 4"± BELOW THE ROAD SURFACE AND 1 WITNESS. THE MONUMENT AGREES WITH THE WITNESS. ACCEPTED THE HARRISON AS THE CORNER LOCATION. SET 4 NEW TIES AND MEASURED TO THE WITNESS.

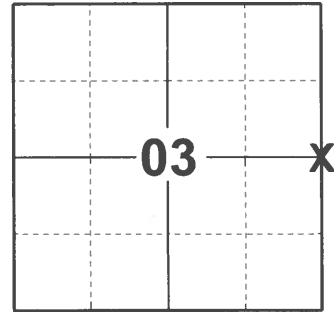

LOCATION
(INDICATE CORNER BY "X")

SEAL:

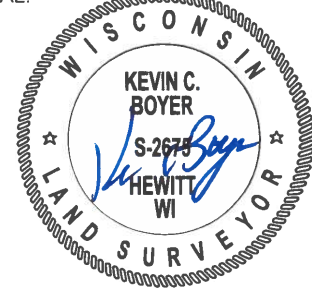

DATA SHOWN HERE ON THIS TIE SHEET IS CORRECT AND COMPLETE TO THE BEST OF MY KNOWLEDGE AND BELIEF.

PROFESSIONAL LAND SURVEYOR

DATE 1/18/2021

TIE SKETCH

NOTE: CORNER LANDS 5'± WEST OF CENTERLINE OF 9TH AVE AND 3'± SOUTH OF CENTERLINE OF GALE DR.

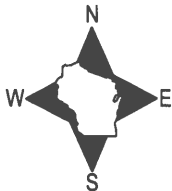

- SET 3/4" x 18" IRON REBAR, 1.50#/FT
- ⊕ FOUND HARRISON MONUMENT
- VINYL "T" POST
- ⊗ BOLT ON TOP OF TEL. PED.

