

ADAMS COUNTY

Survey Monument Record

TYPE OF MONUMENT: 1 1/2" x 50" IRON PIPE
STATE PLANE COORDINATES: N _____
E _____
ELEVATION — M.S.L. DATUM: _____
THETA ANGLE: _____
FIELD BOOK: 38 PAGE 32

CORNER NO. 21
SECTION 6
TOWN 14 N
RANGE 6 E

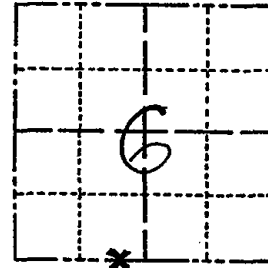

LOCATION
(Indicated by 'X')

SEAL:



BASIS FOR MONUMENT LOCATION

(Use reverse side if necessary)

Show info such as: History of corner, with reference to Vol. and pg. dates, surveyor; exact description of monument replaced; if location computed, by taped or EDM traverse; landowner remarks, etc.

Ran EDM/T2 traverse around Section 6 and to portions of adjacent sections to determine search areas for investigation.

Search revealed no trace of the original corner or any remonumentation. (no remonumentation of record in Adams County Courthouse)

Relocated corner at record distance from Southeast corner of Section 6 and on line between Southeast and South Quarter corner. Location fits occupation very well.

Set Harrison on 3-22-77.

CORNER O.K 12-21-81 DW-SK
" " 2-13-85 GR-SG
" " 3-25-91 GR-JG

CERTIFIED CORRECT:

Dale C Hagen
Registered Land Surveyor

DATE: 5-31-77

TIE SKETCH

ALL OK 3-07-01 JG-MH
ALL OK 11-14-06-JG

(Show at least four ties)

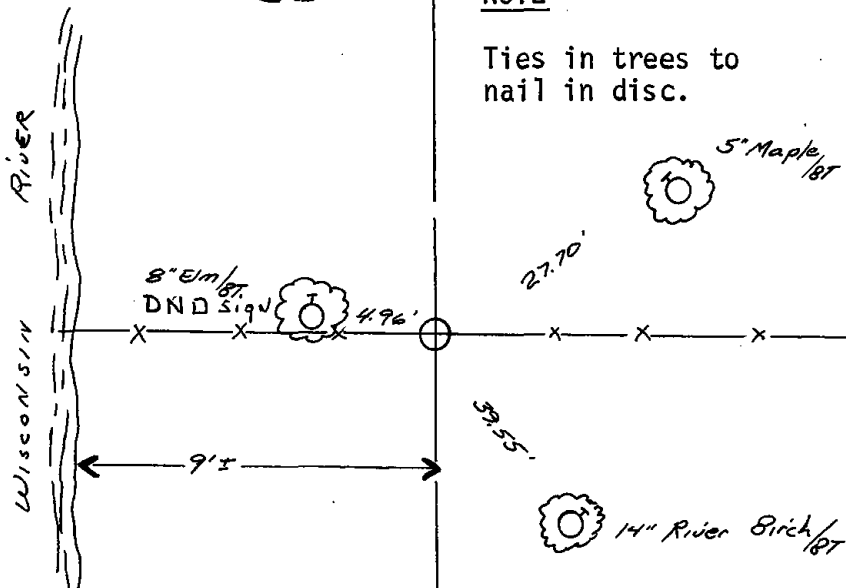

NOTE

Ties in trees to nail in disc.

