

23  
SECTION

14  
TOWN

06  
RANGE

# ADAMS COUNTY

COUNTY CORNER NO: 79

ROMPORTOL ID: 41406232000

## PUBLIC LAND SURVEY MONUMENT RECORD

TYPE OF MONUMENT: HARRISON (BROKEN-TOP)

ADAMS COUNTY COORDINATES, NAD 83 (2007)

N. 113800.295

E. 552242.491

ELEVATION- - - - DATUM - - - -

FIELD WORK DATE: 01/05/2021

### BASIS FOR MONUMENT LOCATION

1977 - PLS 1103 RAN EDM/T2 TRAVERSE BETWEEN NORTHWEST AND SOUTHWEST CORNERS OF SECTION 24 TO DETERMINE SEARCH AREAS FOR INVESTIGATION. COULD FIND NO EVIDENCE OF THE ORIGINAL CORNER, REMONUMENTATION OR ACCESSORY MONUMENTS. SET CORNER BY SINGLE PROPORTIONATE MEASURE ON LINE BETWEEN ADJACENT SECTION CORNERS. SET HARRISON MONUMENT.

2021 - PLS 2675 FOUND HARRISON (BROKEN-TOP) FLUSH WITH THE GROUND AND 1 WITNESS TREE. THE MONUMENT AGREES WITH THE WITNESS TREE. ACCEPTED THE HARRISON (BROKEN-TOP) AS THE CORNER LOCATION. SET 4 NEW TIES AND MEASURED TO THE EXISTING WITNESS TREE.

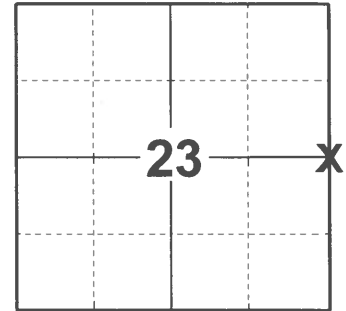

### LOCATION

(INDICATE CORNER BY "X")

SEAL:



DATA SHOWN HERE ON THIS TIE SHEET IS CORRECT AND COMPLETE TO THE BEST OF MY KNOWLEDGE AND BELIEF.

PROFESSIONAL LAND SURVEYOR

DATE 3/3/2021

### - TIE SKETCH

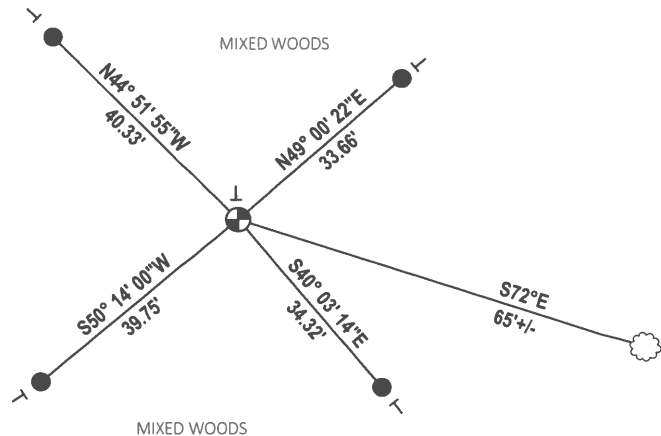
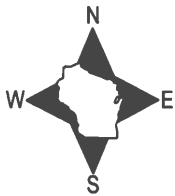

- SET 3/4" x 18" IRON REBAR, 1.50#/FT
- ⊕ FOUND HARRISON (BROKEN-TOP) MONUMENT
- ┆ VINYL "T" POST
- ☁ WITNESS TREE

# ADAMS COUNTY

## Survey Monument Record

TYPE OF MONUMENT: Harrison  
 STATE PLANE COORDINATES: N \_\_\_\_\_  
 E \_\_\_\_\_  
 ELEVATION — M.S.L. DATUM: \_\_\_\_\_  
 THETA ANGLE: \_\_\_\_\_  
 FIELD BOOK: 38 PAGE 35

CORNER NO. 79  
 SECTION 24  
 TOWN 14  
 RANGE 6

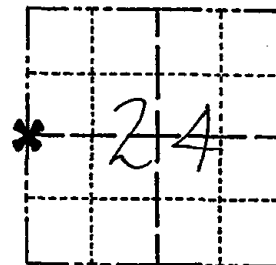

LOCATION  
(Indicated by 'X')

SEAL:

### BASIS FOR MONUMENT LOCATION

(Use reverse side if necessary)

Show info such as: History of corner, with reference to Vol. and pg, dates, surveyor; exact description of monument replaced; if location computed, by taped or EDM traverse; landowner remarks, etc.

Ran EDM/T2 traverse between Northwest and Southwest corners of Section 24 to determine search areas for investigation.

Could find no evidence of the original corner, remonumentation or any accessory monuments.

Set corner by siggle proportionate measure on line between adjacent section corners.

Set Harrison on 3-25-77.

CORNER O.K 12-17-81 SK-DW  
 6-86 SP-SS  
 Top BROKEN OFF 7-18-91 JG-CR  
 " " 3 NEW TIES 5-16-96 SS  
 " " 2 NW TIES 10-12-01 SS  
 O.K. " 11-13-06 STS

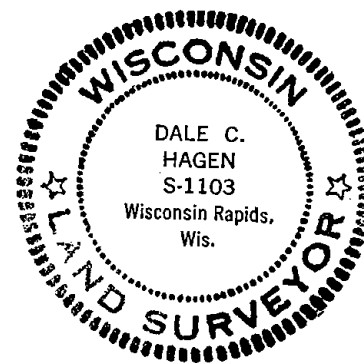

CERTIFIED CORRECT:

*Dale C. Hagen*  
 Registered Land Surveyor

DATE: 5-31-77

### TIE SKETCH

(Show at least four ties)

### NOTE

Ties in trees to nail in disc.

