

36 SECTION 14 TOWN 06 RANGE

ADAMS COUNTY

COUNTY CORNER NO: 120
ROMPORTOL ID: 41406362000

PUBLIC LAND SURVEY MONUMENT RECORD

TYPE OF MONUMENT: HARRISON (BROKEN-TOP)
ADAMS COUNTY COORDINATES, NAD 83 (2007)

N. 103542.802

E. 557478.272

ELEVATION- _____ DATUM _____

FIELD WORK DATE: 10/04/2017

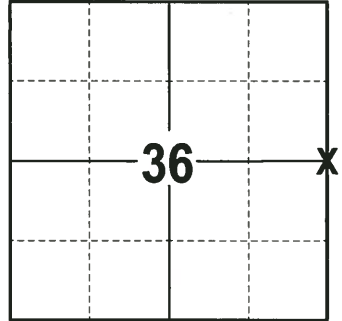

LOCATION
(INDICATE CORNER BY "X")

BASIS FOR MONUMENT LOCATION

1975 - PLS 922 RE-ESTABLISHED THE CORNER BY THE SINGLE PROPORTIONATE METHOD BETWEEN THE NE CORNER OF SECTION 25, 14-6 AND THE SE CORNER OF SECTION 36, 14-6 VIA E.D.M TRAVERSE. FOUND A POINTED STONE 18" LONG WITH A 6" BASE WITHIN A FEW FEET OF THE CORNER LOCATION. THE STONE HAD BEEN GRADED OUT WITHIN THE LAST 5 YEARS. CHECKED COUNTY SURVEY RECORDS AND THERE WAS NOT A STONE ON RECORD. M.C. SMITH NOTED IN 1921 THAT HE COULD NOT FIND ANY SIGNS OF THE ORIGINAL CORNER AND HE SET A POST, WHICH COULD NOT BE LOCATED. IT IS BELIEVED THAT THE DISTURBED STONE WAS AT THE CORNER SET BY SMITH. SET A 30" HARRISON AT THE CORNER LOCATION AND TIED OUT.

2017 - PLS 2994 FOUND A HARRISON MONUMENT WITH A BROKEN-TOP 6" BELOW THE SURFACE, 2 WITNESS TREES AND A POWER POLE WITNESS. THE MONUMENT AGREES WITH THE EXISTING WITNESS TREES AND POWER POLE WITNESS. ACCEPTED THE HARRISON MONUMENT WITH A BROKEN-TOP AS THE CORNER LOCATION. SET 4 NEW TIES AND RE-MEASURED TO THE TIES, WITNESS TREES AND POWER POLE WITNESS.

SEAL:



DATA SHOWN HERE ON THIS TIE SHEET IS CORRECT AND COMPLETE TO THE BEST OF MY KNOWLEDGE AND BELIEF.

PROFESSIONAL LAND SURVEYOR

DATE 11-15-17

- TIE SKETCH

NOTE: THE CORNER FALLS 12± NORTH OF THE CENTERLINE OF THE GOLF COURSE DRIVEWAY.

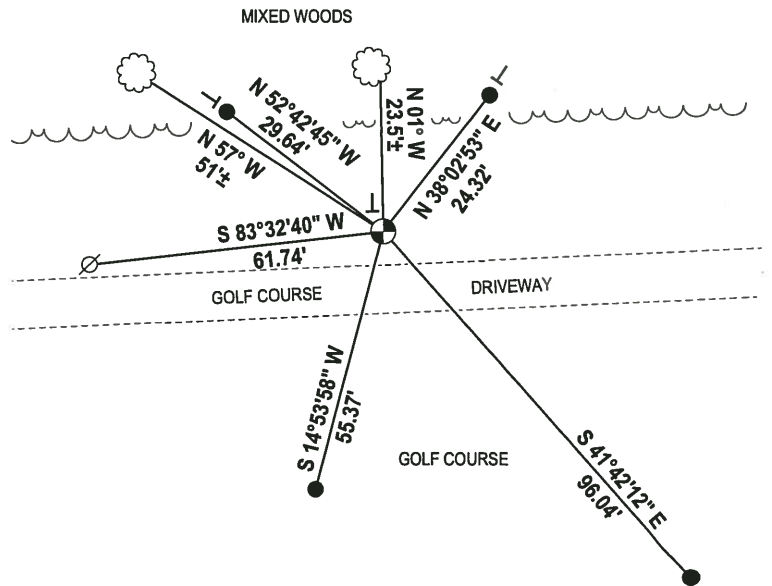
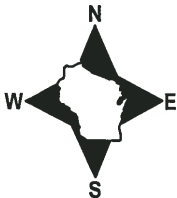

- 3/4" x 18" IRON REBAR SET, 1.50#/FT
- ⊕ HARRISON (BROKEN-TOP) FOUND
- ⊘ WITNESS POWER POLE
- ⊥ VINYL "T" POST
- ☁ WITNESS TREE FOUND

ADAMS COUNTY

CORNER NO. 889

Survey Monument Record

SECTION 36

TYPE OF MONUMENT: 30" HARRISON

TOWN 14 N

STATE PLANE COORDINATES: N _____

RANGE 6 E

E _____

ELEVATION — M.S.L. DATUM: _____

THETA ANGLE: _____

FIELD BOOK: _____ PAGE _____

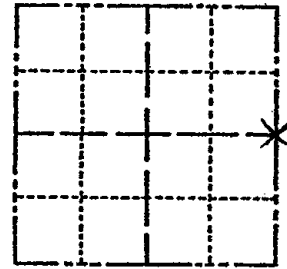

BASIS FOR MONUMENT LOCATION

(Use reverse side if necessary)

Show info such as: History of corner, with reference to Vol. and pg. dates, surveyor; exact description of monument replaced; if location computed, by taped or EDM traverse; landowner remarks, etc.

SEAL:

LOCATION
(Indicated by 'X')

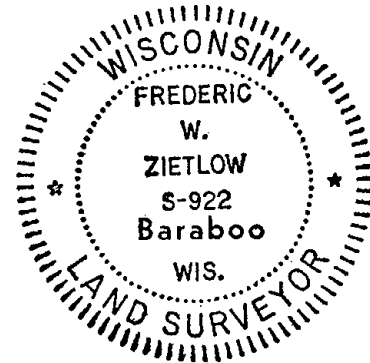

CERTIFIED CORRECT:

Frederic W. Zietlow

Registered Land Surveyor

DATE: NOVEMBER 20, 1975

THIS CORNER WAS RE-ESTABLISHED BY THE SINGLE PROPORTIONATE METHOD BETWEEN KNOWN CORNERS, BEING THE NE COR. OF SEC. 25, 14-6 AND THE SE COR. OF SEC. 36, 14-6 VIA EDM. TRAVERSE. WE FOUND A POINTED STONE 18" LONG WITH 6" BASE WITHIN A FEW FEET OF THE CORNER. THIS STONE HAD BEEN GRADED OUT WITHIN THE PAST 5 YEARS. CHECKED COUNTY SURVEY RECORDS AND NO STONE WAS OF RECORD. M.C. SMITH NOTED IN 1921 THAT HE COULD FIND NO SIGNS OF ORIGINAL CORNER & HE SET A POST, WHICH WE COULD NOT LOCATE. I BELIEVE THE STONE WHICH WAS DISTURBED WAS AT THE COR. SET BY SMITH.

CORNER O.K. 10-28-76 BR-DCH
CORNER O.K. 12-14-81 SK-DW

TIE SKETCH

COR O.K. 2-12-86 GR-93

" " 6-20-91 JG

(Show at least four ties) 1-GONE, 1-NEW, TOP BROKEN OFF A-25-96 JG-SS

OK 3-7-02-JG, 1-GONE, 1-NEW, 1-23-06-JG

OK, 1-17-11 MS-SS

