

33 SECTION 14 TOWN 06 RANGE

ADAMS COUNTY

COUNTY CORNER NO: 126B
 ROMPORTOL ID: 41406330020B

PUBLIC LAND SURVEY MONUMENT RECORD

TYPE OF MONUMENT: 3/4" IRON ROD (MEANDER CORNER)
 ADAMS COUNTY COORDINATES, NAD 83 (2007)

N. 100099.022

E. 540096.220

ELEVATION- DATUM

FIELD WORK DATE: 2/28/2017

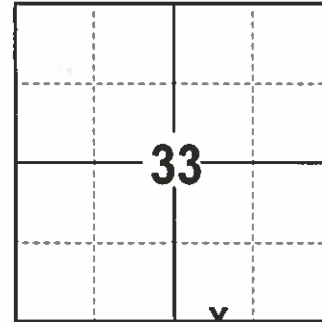

LOCATION
(INDICATE CORNER BY "X")

SEAL:



DATA SHOWN HERE ON THIS TIE SHEET IS CORRECT AND COMPLETE TO THE BEST OF MY KNOWLEDGE AND BELIEF.

PROFESSIONAL LAND SURVEYOR

DATE 3/15/17

BASIS FOR MONUMENT LOCATION

1979- PLS 1478 FOUND A 3/4" IRON REBAR DURING A RANDOM TRAVERSE OF THE SOUTH LINE OF SECTION 33, THE DISTANCE FROM THIS REBAR TO THE SE CORNER OF SECTION 33. VERY NEARLY MATCHES A DISTANCE SHOWN ON A 1932 MAP OF THE CITY OF WISCONSIN DELLS IN COLUMBIA COUNTY. A MONUMENT IS SHOWN ON THIS MAP, BUT NO INDICATION OF WHAT WAS SET WAS GIVEN. A 4" DIAMETER WOOD STAKE BLAZED ON WEST SIDE WAS FOUND 0.80' NE OF THE REBAR AND A VERY ROTTEN 2" SQUARE WOOD STAKE WAS FOUND IMMEDIATELY TO THE EAST OF THE BAR.

2006- FOUND A 3/4" REBAR IN GOOD CONDITION AND SET 3 TIES

2017 - PLS 2994 FOUND A 3/4" REBAR FLUSH WITH THE SURFACE, AND 3 EXISTING TIES. THE REBAR AGREES WITH THE TIES. ACCEPTED THE 3/4" REBAR, REMEASURED TO THE 3 EXISTING TIES AND SET 1 NEW TIE.

- TIE SKETCH

NOTE: THE CORNER FALLS 40'± EAST OF THE EAST BANK OF THE WISCONSIN RIVER.

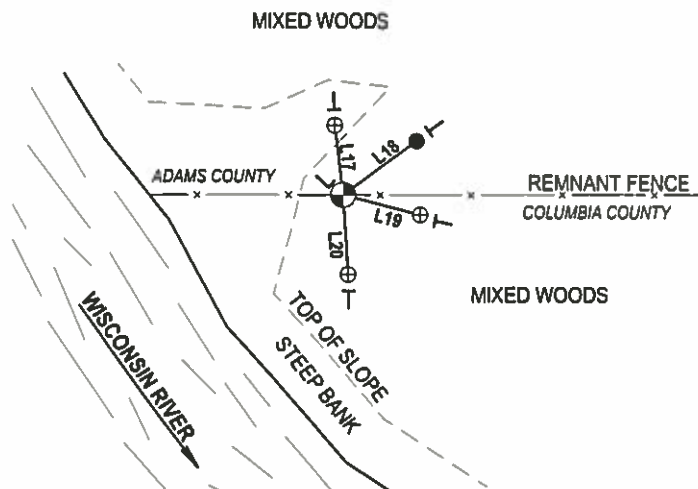
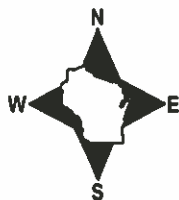

- 3/4" x 18" IRON REBAR SET, 1.50#/FT
- ⊕ 3/4" IRON ROD W/ALUMINUM CAP FOUND
- ⊙ 3/4" IRON ROD FOUND
- VINYL "T" POST
- ↪ FIBERGLASS "T" POST

LINE	BEARING	DISTANCE
L17	N 06°51'44" W	18.20'
L18	N 53°58'56" E	23.75'
L19	S 75°32'22" E	20.80'
L20	S 03°24'35" E	20.73'

Government Land Corner Certificate

ADAMS County

TYPE OF MONUMENT: 3/4" REBAR - FOUND

STATE PLANE COORDINATES: N _____
E _____

ELEVATION — M.S.L. DATUM: _____

THETA ANGLE: _____

FIELD BOOK: _____ PAGE _____

DRAWN BY: G. RHINEHART

CORNER NO. 126
SECTION 33
TOWN 14
RANGE 6

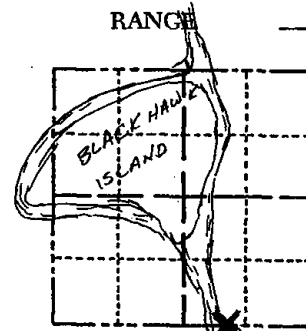

LOCATION
(Indicated by 'X')

SEAL:



DATA SHOWN HERE ON
CERTIFIED CORRECT:

Registered Land Surveyor

DATE: 12/12/79

BASIS FOR MONUMENT LOCATION

Show info such as: History of corner, with reference to Vol. and pg., dates, surveyor; exact description of monument replaced; if location computed, by taped or EDM traverse; landowner remarks, etc. (Use reverse side if necessary)

Found 3/4" Rebar during random traverse of south line of Section 33. The distance from this rebar to the SE corner of Section 33 very nearly matches a distance shown on a 1932 map* of the city of Wisconsin Dells in Columbia County. A monument is shown on this map, but no indication of what it is was given.

A 4" diameter wood stake, blazed on the west side was found 0.8' to the NE of the rebar and a very rotten 2" square wood stake was found immediately to the east of the bar.

* this map was prepared by H.C. Amundsen and viewed at Mid-state Associate offices in Baraboo, Wisconsin.

CORNER O.K. 12-14-81 SK-DW

TIE SKETCH

3 NEW TIES 11-27-86 - SG-SS
Roads OK 4-7-11 SS

Show at least four ties, also fence lines, roads, topo, size and type of witness trees and if off road - best way to arrive at corner.

PLACED SURVEY MARKER
SIGN ON S* NORWAY
2 1/2' SOUTH OF REBAR

