

PUBLIC LAND SURVEY MONUMENT RECORD

TYPE OF MONUMENT: HARRISON
ADAMS COUNTY COORDINATES, NAD 83 (2007)

N. 185789.164

E. 517814.469

ELEVATION- _____ DATUM _____

FIELD WORK DATE: 01/20/2021

BASIS FOR MONUMENT LOCATION

1977 - PLS 1103 RAN EDM/T2 TRAVERSE AROUND SECTION 14 TO DETERMINE SEARCH AREAS. INVESTIGATION YIELDED EVIDENCE OF THE POINT SECTIONS OF TWO WOODEN POSTS ADJACENT TO EACH OTHER, ALONG WITH THE REMAINS OF TWO BEARING TREES BY COUNTY SURVEYOR A.J. BARRETT (VOL.1, PAGE 1 OF ADAMS COUNTY SURVEYOR RECORDS) AND ONE ORIGINAL BEARING TREE

- ORIGINAL 7" TAMARACK S8-1/4°W 46 LINKS- MEASURES S8°W 30.2 FEET
- BARRETT 10" TAMARACK N20°E 41-1/2 LINKS- MEASURES N20°E 27.7 FEET
- 10" TAMARACK N78-1/4°W 49 LINKS- MEASURE S74-1/4°W 28 FT (?)

REMONUMENTED POSTS WITH HARRISON ON 12-3-1976

2021 - PLS 2675 FOUND A HARRISON MONUMENT 6"± BLEW THE SWAMP SURFACE AND 3 WITNESSES. THE MONUMENT AGREES WITH ALL WITNESSES. ACCEPTED THE HARRISON AS THE CORNER LOCATION. SET 4 NEW TIES AND MEASURED TO THE EXISTING WITNESSES.

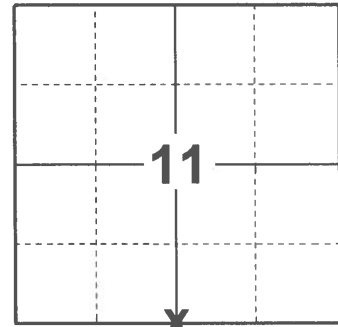

LOCATION

(INDICATE CORNER BY "X")

SEAL:



DATA SHOWN HERE ON THIS TIE SHEET IS CORRECT AND COMPLETE TO THE BEST OF MY KNOWLEDGE AND BELIEF.

PROFESSIONAL LAND SURVEYOR

DATE 2/23/2021

TIE SKETCH

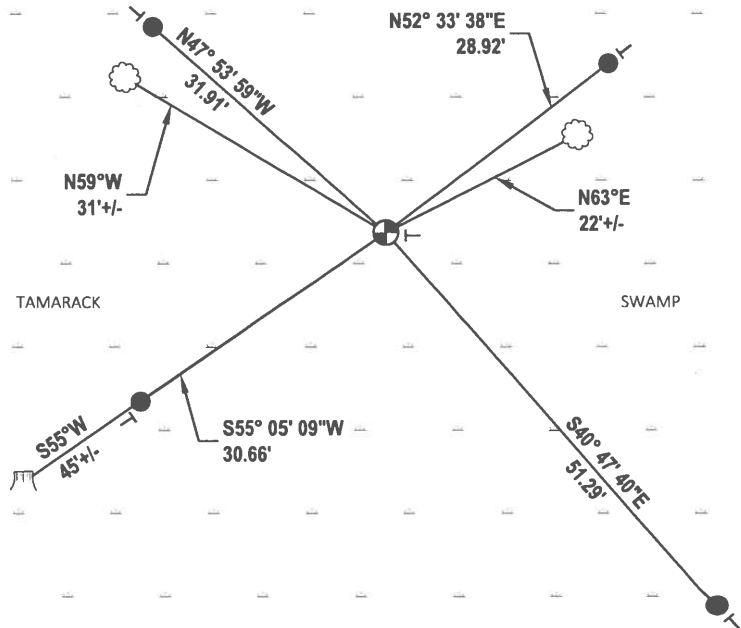
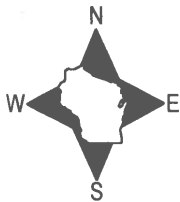

- SET 3/4" x 48" IRON REBAR, 1.50#/FT
- ⊕ FOUND HARRISON MONUMENT
- ┊ VINYL "T" POST
- ☁ WITNESS TREE
- ┌ WITNESS STUMP

ADAMS COUNTY

Survey Monument Record

TYPE OF MONUMENT: Harrison
 STATE PLANE COORDINATES: N 43°52'34.7"
 HAND HELD GPS E 089°52'04.9"
 ELEVATION — M.S.L. DATUM: _____
 THETA ANGLE: _____
 FIELD BOOK: 39 PAGE 45

CORNER NO. 50
 SECTION 14
 TOWN 16 N
 RANGE 5 E

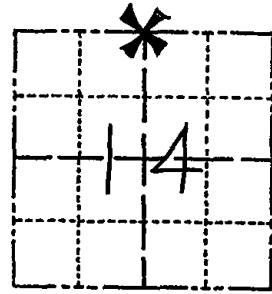

BASIS FOR MONUMENT LOCATION

(Use reverse side if necessary)

Show info such as: History of corner, with reference to Vol. and pg. dates, surveyor; exact description of monument replaced; if location computed, by taped or EDM traverse; landowner remarks, etc.

Ran EDM/T2 traverse around Section 14 to determine search areas.

Investigation yielded evidence of the point sections of two wooden posts adjacent to each other, along with the remains of two bearing trees by County Surveyor A.J. Barrett (Vol. 1, Page 1 of Adams County Surveyor Records) and one original bearing tree

- Orig* 7" Tam S 8¼° W 46 links - Measures S 8° W 30.2 ft.
- Barrett 10" Tam N 20° E 41½ links - Measures N 20° E 27.7 ft.
- 10" Tam N 78¼° W 49 links - Measures S 74¼° W 28 ft (?)

Remonumented posts with Harrison on 12-3-76.

MON & TIES OK 1/13/81 RN-SK
 " " 11-6-85 GR-SS
 ALL OK 1-9-90 GR-SS
 1-GONE, 1-NEW, 1-17-06, JG-SS
 2 NEW TIES 12-07-10 SS

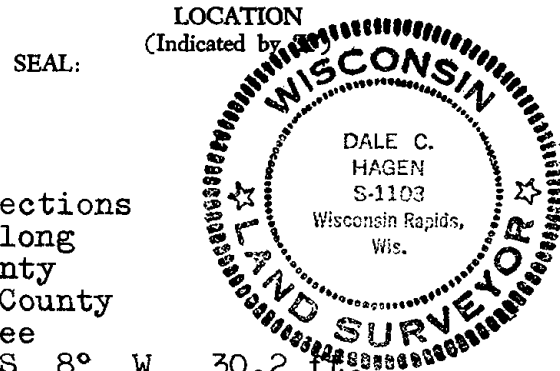

CERTIFIED CORRECT:
Dale C Hagen
 Registered Land Surveyor
 DATE: 1-24-77

TIE SKETCH

(Show at least four ties)
 NOTE
 Ties in trees to nail in disc.

