

# Government Land Corner Certificate

ADAMS County  
 TYPE OF MONUMENT: HARRISON  
 STATE PLANE COORDINATES: N \_\_\_\_\_  
 E \_\_\_\_\_  
 ELEVATION — M.S.L. DATUM: \_\_\_\_\_  
 THETA ANGLE: \_\_\_\_\_  
 FIELD BOOK: A-F 1 PAGE 20  
 DRAWN BY: S. SORENSEN

CORNER NO. 37  
 SECTION 10  
 TOWN 16  
 RANGE 6

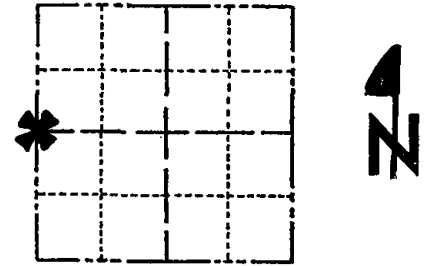

LOCATION  
(Indicated by 'X')

## BASIS FOR MONUMENT LOCATION

Show info such as: History of corner, with reference to Vol. and pg., dates, surveyor; exact description of monument replaced; if location computed, by taped or EDM traverse; landowner remarks, etc. (Use reverse side if necessary)

During an EDM-Transit traverse of Section 10-16-6 a 27"X12"X6" pointed sandstone was found lying on top of the ground near a new fence corner post. Excavation by hand revealed the stain from said stone at the intersection of two very old fences. Further investigation revealed a hollow, but living, 28" White Oak that matches the bearing and distance of the original White oak bearing tree by Surveyor James in October 1951. Set Standard Harrison Monument at location of stain and left stone lying adjacent to and south of the Harrison.

SEAL:



DATA SHOWN HERE ON  
CERTIFIED CORRECT:

*Gregory P. Reinhart*  
Registered Land Surveyor

DATE: 6/9/80

## TIE SKETCH

Show at least four ties, also fence lines, roads, topo, size and type of witness trees' and if off road - best way to arrive at corner.

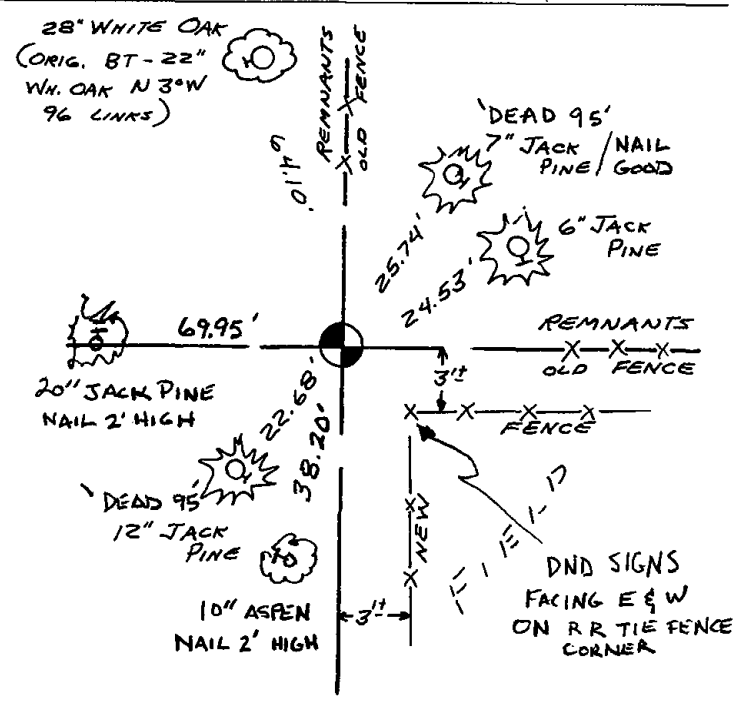

## MAINTENANCE RECORD

Date	Init.	Remarks
10-31-85	MB-SS	OK.
1-8-90	GR-KZ	OK
2-2-95	JG	2-NEW
12-07-00	JG	ALL OK
3-1-05	JG	ALL OK
1-20-10	SS	TIES OK

