

PUBLIC LAND SURVEY MONUMENT RECORD

TYPE OF MONUMENT: BERNTSEN SNM1 SURVEY NAIL
 ADAMS COUNTY COORDINATES, NAD 83 (2007)

N. 172616.995

E. 531261.911

ELEVATION- _____ DATUM _____

FIELD WORK DATE: 12/08/2020

BASIS FOR MONUMENT LOCATION

2013 - PLS 1452 FOUND A "PK" NAIL.

2020 - PLS 2675 FOUND BERNTSEN SURVEY NAIL IN THE ROAD SURFACE AND 4 TIES. THE MONUMENT AGREES WITH ALL 4 TIES. ACCEPTED THE BERNTSEN SURVEY NAIL AS THE CORNER LOCATION AND MEASURED TO ALL 4 EXISTING TIES.

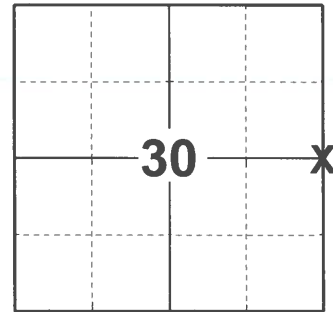

LOCATION
 (INDICATE CORNER BY "X")

SEAL:

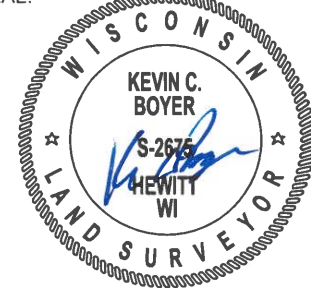

DATA SHOWN HERE ON THIS TIE SHEET IS CORRECT AND COMPLETE TO THE BEST OF MY KNOWLEDGE AND BELIEF.

PROFESSIONAL LAND SURVEYOR

DATE 11/18/2022

TIE SKETCH

NOTE: THE CORNER LANDS 4.5± EAST OF CENTERLINE OF STH "13".

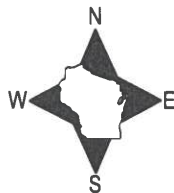

- FOUND BERNTSEN MONUMENT A2BR30
- ⊕ FOUND BERNTSEN SURVEY NAIL FOUND
- └ VINYL "T" POST

