

## PUBLIC LAND SURVEY MONUMENT RECORD

TYPE OF MONUMENT: HARRISON  
ADAMS COUNTY COORDINATES, NAD 83 (2007)

N. 215893.032

E. 499427.505

ELEVATION-      DATUM     

FIELD WORK DATE: 01/16/2019

### BASIS FOR MONUMENT LOCATION

1975 - PLS 1103 RETRACED SURVEY BY F.W. ZIETLOW IN THE NW1/4 OF THE NW1/4 OF SECTION 8. SET CORNER AT LOCATION AS INDICATED ON CSM FOR ABOVE NOTED SURVEY, RECORDED NOVEMBER 4, 1970 VOL. 1 PAGE 94 OF CERTIFIED SURVEYS.

2019 - PLS 2675 FOUND HARRISON MONUMENT 4" BELOW THE ROAD SURFACE AND 1 TIE. THE MONUMENT AGREES WITH THE EXISTING TIE. ACCEPTED THE HARRISON AS THE CORNER. SET 4 NEW TIES AND MEASURED TO THE EXISTING TIE.

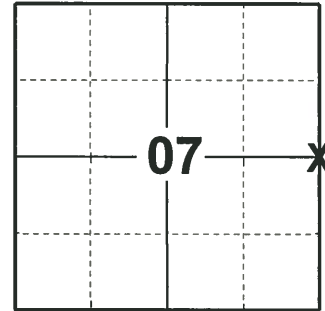

### LOCATION

(INDICATE CORNER BY "X")

SEAL:

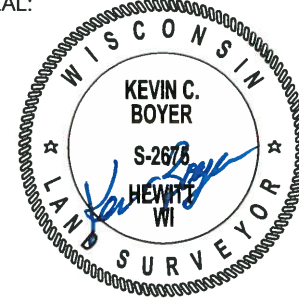

DATA SHOWN HERE ON THIS TIE SHEET IS CORRECT AND COMPLETE TO THE BEST OF MY KNOWLEDGE AND BELIEF.

PROFESSIONAL LAND SURVEYOR

DATE 3/12/19

### TIE SKETCH

NOTE: THE CORNER LANDS 0.50± EAST OF CENTER LINE OF CTH "Z"

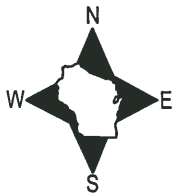

- SET 3/4" x 18" IRON REBAR, 1.50#/FT
- FOUND 3/4" IRON ROD
- ⊕ FOUND HARRISON MONUMENT
- ~ STEEL FENCE POST
- VINYL "T" POST
- ⊠ RIGHT OF WAY GUARD POST

