

PUBLIC LAND SURVEY MONUMENT RECORD

TYPE OF MONUMENT: 1-1/4" O.D. IRON PIPE
 ADAMS COUNTY COORDINATES, NAD 83 (2007)

N. 207998.244

E. 496062.140

ELEVATION- DATUM

FIELD WORK DATE: 02/19/2019

BASIS FOR MONUMENT LOCATION

1981 - PLS-1444 CORNER WAS SET ON THE SOUTH RIGHT-OF-WAY LINE OF KENTDORF AVE. WHICH H.C. AMUNDSON INDICATES IS THE SECTION LINE IN HIS PLAT OF DELLWOOD.

2019 - PLS-2675 FOUND 1-1/4" O.D. IRON PIPE FLUSH WITH THE GROUND AND 2 TIES. THE MONUMENT AGREES WITH BOTH TIES. ACCEPTED THE 1-1/4" O.D. IRON PIPE AS THE CORNER. SET 3 NEW TIES AND MEASURED TO THE EXISTING TIES.

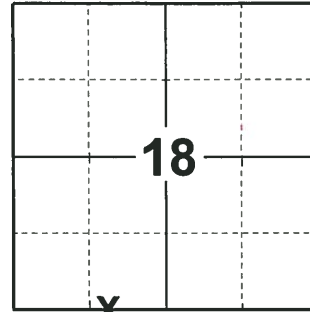

LOCATION
 (INDICATE CORNER BY "X")

SEAL:

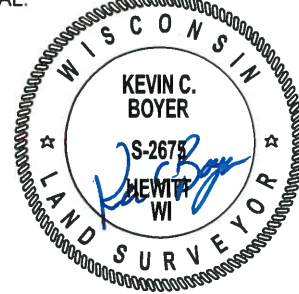

DATA SHOWN HERE ON THIS TIE SHEET IS CORRECT AND COMPLETE TO THE BEST OF MY KNOWLEDGE AND BELIEF.

PROFESSIONAL LAND SURVEYOR

DATE 3/12/19

TIE SKETCH

NOTE: THE CORNER LANDS 190± WEST OF THE INTERSECTION OF MARKET ST. AND KENDTORFF AVE.



- SET 3/4" x 18" IRON REBAR, 1.50#/FT
- FOUND 1-1/4" O.D. IRON PIPE
- ⊕ FOUND 1-1/4" O.D. IRON PIPE
- ⦿ RAILROAD SPIKE (41705180020)

