

12 SECTION 17 TOWN 07 RANGE

ADAMS COUNTY

COUNTY CORNER NO: 53
 ROMPORTOL ID: 41707120000

PUBLIC LAND SURVEY MONUMENT RECORD

TYPE OF MONUMENT: HARRISON
 ADAMS COUNTY COORDINATES, NAD 83 (2007)

N. 213754.386

E. 588951.420

ELEVATION- DATUM

FIELD WORK DATE: 1/16/2017

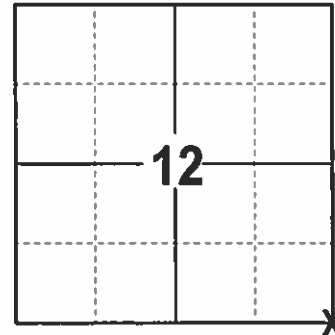

LOCATION
 (INDICATE CORNER BY "X")

BASIS FOR MONUMENT LOCATION

1981 - PLS 878 FOUND A STUMP FROM ORIGINAL BEARING TREE WHICH WAS AN 8 INCH BLACK OAK AT N 61 W, 39 LINKS, FOUND AN ORIGINAL WHITE OAK BEARING TREE STILL ALIVE AT N 70 E, 109 LINKS, FOUND A STUMP FROM AN ORIGINAL WHITE OAK BEARING TREE AT S 62 E, 74 LINKS AND FOUND A STUMP OF AN ORIGINAL WHITE OAK BEARING TREE AT S 14 W, 36 LINKS. ESTABLISHED THE CORNER LOCATION FROM THE ORIGINAL BEARING TREES AND SET A HARRISON.

2017 - PLS 2994 FOUND EXISTING HARRISON LEVEL WITH THE SURFACE AND 1 EXISTING WITNESS. THE HARRISON AGREES WITH EXISTING WITNESS. ACCEPTED HARRISON AND SET 4 NEW TIES.

SEAL:



DATA SHOWN HERE ON THIS TIE SHEET IS CORRECT AND COMPLETE TO THE BEST OF MY KNOWLEDGE AND BELIEF.

PROFESSIONAL LAND SURVEYOR

DATE 3/7/17

- TIE SKETCH -

NOTE: THE CORNER FALLS 7.5' NORTH OF THE TRAIL

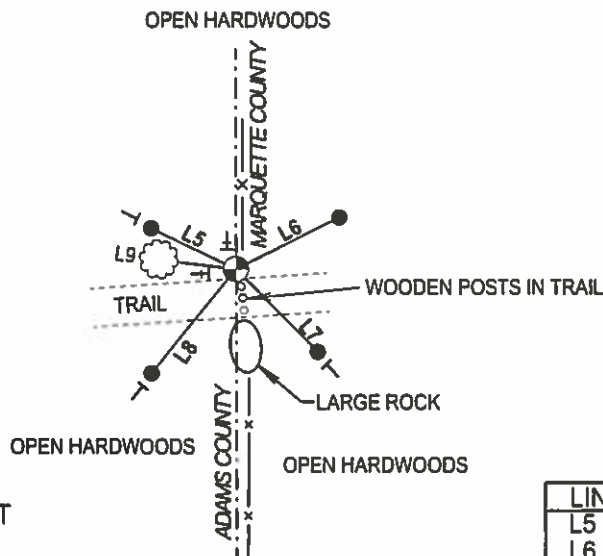
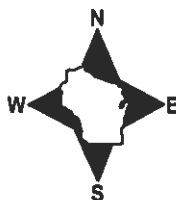

- 3/4" x 18" IRON REBAR SET, 1.50#/FT
- ⊕ FOUND HARRISON
- VINYL "T" POST
- STEEL "T" POST
- ⊙ FOUND WITNESS TREE

LINE	BEARING	DISTANCE
L5	N 64°22'30" W	24.42'
L6	N 63°39'59" E	30.21'
L7	S 44°49'53" E	30.27'
L8	S 39°08'08" W	34.89'
L9	N 83°06' W	20.5±

Government Land Corner Certificate

ADAMS County
 TYPE OF MONUMENT: Harrison
 STATE PLANE COORDINATES: N 43°57'08.6"
 HAND HEED NAV WR 089°35'51.3"
 ELEVATION — M.S.L. DATUM: _____
 THETA ANGLE: _____
 FIELD BOOK: 54 PAGE 698
 DRAWN BY: STEVEN KIEDROWSKI

CORNER NO. 53
 SECTION 13
 TOWN 17
 RANGE 7

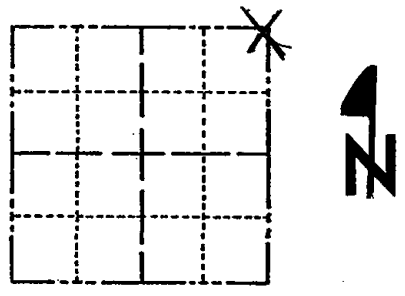

LOCATION
(Indicated by 'X')

BASIS FOR MONUMENT LOCATION

Show info such as: History of corner, with reference to Vol. and pg., dates, surveyor; exact description of monument replaced; if location computed, by taped or EDM traverse; landowner remarks, etc. (Use reverse side if necessary)

Found stump from original bearing tree.
 (Black oak, 8", N 61 W; 39 lks.)
 Also found original white oak bearing tree still alive. (N 70 E, 109 lks.)
 Also found stump from original white oak bearing tree. (S 62 E, 74 lks.)
 Also found stump from original white oak bearing tree. (S 14 W, 36 lks.)
 corner reestablished from original bearing trees.

SEAL:



DATA SHOWN HERE ON CERTIFIED CORRECT:

Anthony B. Kiedrowski
 Registered Land Surveyor

DATE: 1/29/81

TIE SKETCH

Show at least four ties, also fence lines, roads, topo, size and type of witness trees' and if off road - best way to arrive at corner.

3-20-87 Fd. 1" I.P.
 PAINTED YELLOW
 1' S NORTH OF MON.

