

33  
SECTION      18  
TOWN      05  
RANGE

# ADAMS COUNTY

COUNTY CORNER NO: 127  
ROMPORTOL ID: 41805330000

## PUBLIC LAND SURVEY MONUMENT RECORD

TYPE OF MONUMENT: HARRISON  
ADAMS COUNTY COORDINATES, NAD 83 (2007)

N. 224107.272

E. 509902.571

ELEVATION-      DATUM     

FIELD WORK DATE: 12/19/2017

### BASIS FOR MONUMENT LOCATION

1975 - PLS 922 ACCEPTED THE FENCE CORNER AS THE BEST EVIDENCE OF THE CORNER LOCATION. SET A HARRISON MONUMENT AND TIED OUT.

2017 - PLS 2994 FOUND A HARRISON MONUMENT 4" ABOVE THE GROUND SURFACE. ALL OF THE WITNESS TREES WERE LOGGED. ACCEPTED THE HARRISON MONUMENT AS THE BEST EVIDENCE OF THE CORNER LOCATION. SET 4 NEW TIES AND MEASURED TO THE TIES.

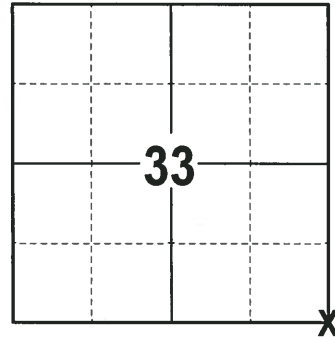

**LOCATION**  
(INDICATE CORNER BY "X")

SEAL:



DATA SHOWN HERE ON THIS TIE SHEET IS CORRECT AND COMPLETE TO THE BEST OF MY KNOWLEDGE AND BELIEF.

PROFESSIONAL LAND SURVEYOR

DATE 1-4-18

### - TIE SKETCH

NOTE: THE CORNER FALLS 10'± NORTH OF THE CENTERLINE OF THE TRAIL.

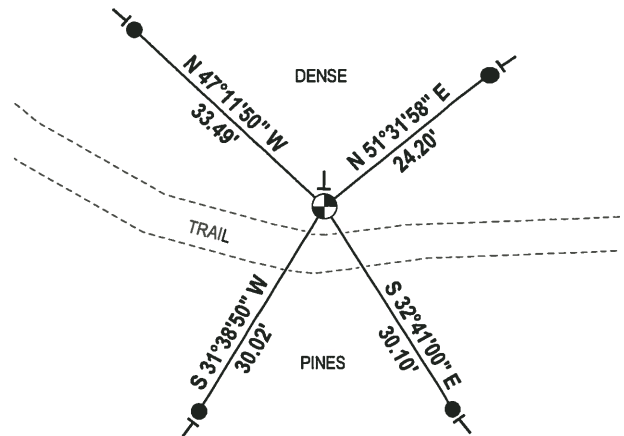
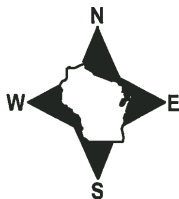

- 3/4" x 18" IRON REBAR SET, 1.50#/FT
- ⊙ HARRISON FOUND
- VINYL "T" POST

# ADAMS COUNTY

## Survey Monument Record

TYPE OF MONUMENT: HARRISON MONUMENT

STATE PLANE COORDINATES: N \_\_\_\_\_  
E \_\_\_\_\_

ELEVATION — M.S.L. DATUM: \_\_\_\_\_

THETA ANGLE: \_\_\_\_\_

FIELD BOOK: \_\_\_\_\_ PAGE \_\_\_\_\_

CORNER NO. 609 <sup>(127)</sup>  
SECTION 34  
TOWN 18  
RANGE 5

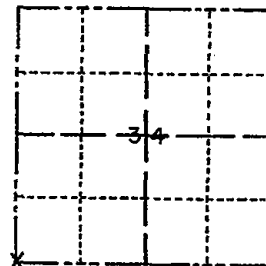

LOCATION  
(Indicated by 'X')

SEAL:

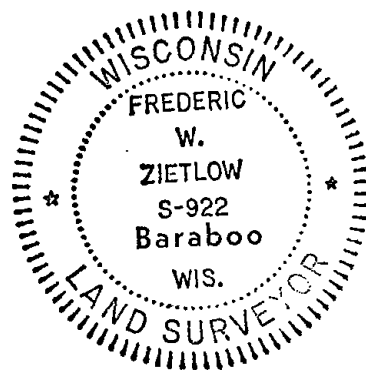

### BASIS FOR MONUMENT LOCATION

(Use reverse side if necessary)

Show info such as: History of corner, with reference to Vol. and pg, dates, surveyor; exact description of monument replaced; if location computed, by taped or EDM traverse; landowner remarks, etc.

Accepted fence corner as best available evidence - used transit tape traverse.

CERTIFIED CORRECT:

*Frederic W. Zietlow*

Registered Land Surveyor

DATE: JAN 29, 1975

CORNER OR. 10-21-75 DAI-S.S.  
" FALL 1978 GPR  
" 4-7-83 GR-SS  
1 NEW TIE 8-20-08 SFS

### TIE SKETCH 2 NEW TIES 2-2-93 JG-SS

(Show at least four ties) SK 2-17-98 JG-SS  
1- GONE, 1-NEW, 3-25-03 JG-SS

