

18 SECTION 18 TOWN 06 RANGE

ADAMS COUNTY

COUNTY CORNER NO: 55
 ROMPORTOL ID: 41806182000

PUBLIC LAND SURVEY MONUMENT RECORD

TYPE OF MONUMENT: HARRISON (BROKEN-TOP)
 ADAMS COUNTY COORDINATES, NAD 83 (2007)

N. 242624.922

E. 530937.311

ELEVATION- _____ DATUM _____

FIELD WORK DATE: 06/13/2019

BASIS FOR MONUMENT LOCATION

1973 - PLS 878 SET HARRISON MONUMENT AND TIED OUT. SET ON A STRAIGHT LINE AND EQUIDISTANT BETWEEN SECTION CORNERS.

2019 - PLS 2675 FOUND A HARRISON MONUMENT WITH A BROKEN-TOP 8" BELOW THE GROUND SURFACE AND 3 TIES. THE MONUMENT AGREES WITH THE EXISTING TIES. ACCEPTED THE HARRISON MONUMENT WITH A BROKEN-TOP AS THE CORNER LOCATION. SET 1 NEW TIE AND MEASURED TO THE TIES.

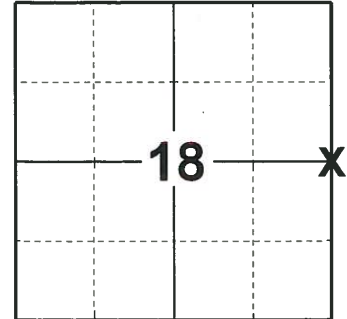

LOCATION

(INDICATE CORNER BY "X")

SEAL:

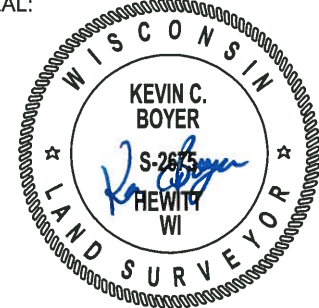

DATA SHOWN HERE ON THIS TIE SHEET IS CORRECT AND COMPLETE TO THE BEST OF MY KNOWLEDGE AND BELIEF.

PROFESSIONAL LAND SURVEYOR

DATE 8/2/19

TIE SKETCH

NOTE: THE CORNER FALLS 19± NORTH OF THE CENTERLINE OF THE EAST-WEST TRAIL.

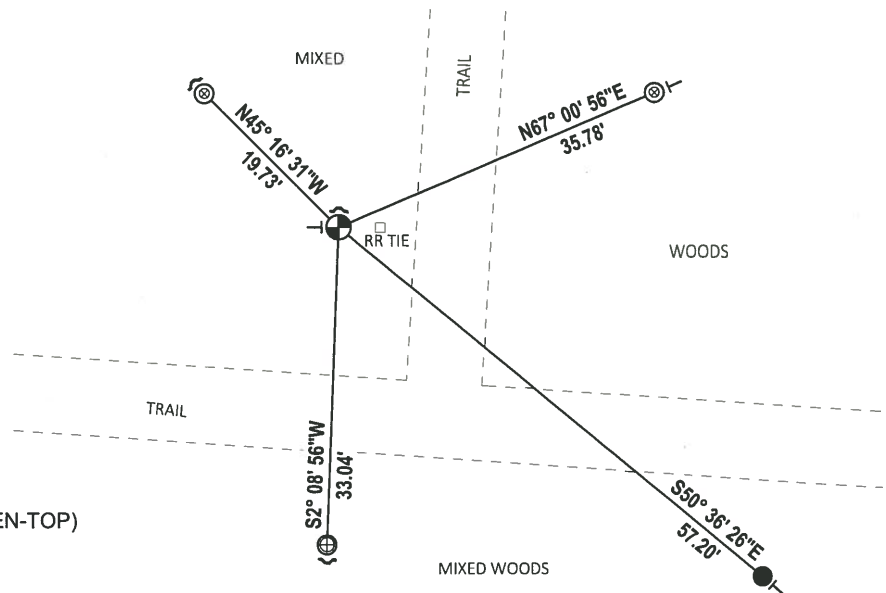
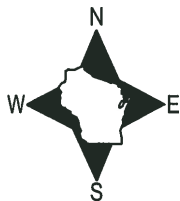

- SET 3/4" x 18" IRON REBAR, 1.50#/FT
- ⊕ FOUND 1" O.D. IRON PIPE
- ⊗ FOUND 1-1/2" O.D. IRON PIPE
- ⊕ FOUND HARRISON MONUMENT (BROKEN-TOP)
- ┘ STEEL FENCE POST
- └ VINYL "T" POST

