

25 SECTION 18 TOWN 05 RANGE

ADAMS COUNTY

COUNTY CORNER NO: 100

ROMPORTOL ID: 41805252000

PUBLIC LAND SURVEY MONUMENT RECORD

TYPE OF MONUMENT: HARRISON
 ADAMS COUNTY COORDINATES, NAD 83 (2007)

N. 232065.882

E. 525740.939

ELEVATION- DATUM

FIELD WORK DATE: 12/21/2017

BASIS FOR MONUMENT LOCATION

1974 - PLS 878 COMPUTED LOCATION ON A STRAIGHT LINE BETWEEN SECTION CORNERS AND ON THE SOUTH LINE OF RAINBOW TROUT PARK SUB. EXTENDED TO THAT LINE. NO OTHER EVIDENCE OF THE CORNER WAS FOUND. SET A HARRISON MONUMENTS AT THE CALCULATED LOCATION AND TIED OUT.

2017 - PLS 2994 FOUND A HARRISON MONUMENT 2" ABOVE THE GROUND SURFACE AND 1 WITNESS TREE. THE MONUMENT AGREES WITH THE EXISTING WITNESS TREE. ACCEPTED THE HARRISON MONUMENT AS THE CORNER LOCATION. SET 4 NEW TIES AND MEASURED TO THE TIES AND WITNESS TREE.



LOCATION
 (INDICATE CORNER BY "X")

SEAL:



DATA SHOWN HERE ON THIS TIE SHEET IS CORRECT AND COMPLETE TO THE BEST OF MY KNOWLEDGE AND BELIEF.

PROFESSIONAL LAND SURVEYOR

DATE 1-4-18

- TIE SKETCH

NOTE: THE CORNER FALLS 33± SOUTH OF THE FIELD EDGE.

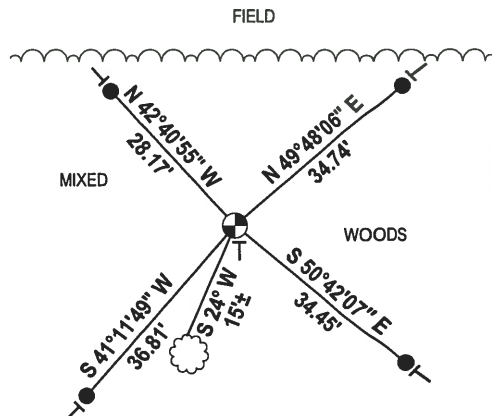
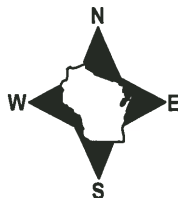

- 3/4" x 18" IRON REBAR SET, 1.50#/FT
- ⊙ HARRISON FOUND
- VINYL "T" POST
- ☁ WITNESS TREE FOUND

ADAMS COUNTY

Survey Monument Record

TYPE OF MONUMENT: Harrison Standard

STATE PLANE COORDINATES: N _____

E _____

ELEVATION — M.S.L. DATUM: _____

THETA ANGLE: _____

FIELD BOOK: _____ PAGE _____

CORNER NO. 400 ⁹⁴

SECTION 30

TOWN 18

RANGE 6

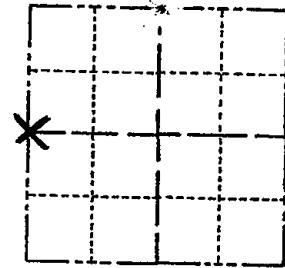

LOCATION
(Indicated by 'X')

SEAL:



BASIS FOR MONUMENT LOCATION

(Use reverse side if necessary)

Show info such as: History of corner, with reference to Vol. and pg, dates, surveyor; exact description of monument replaced; if location computed, by taped or EDM traverse; landowner remarks, etc.

Set on a computed straight line ~~point~~ between section corners and on the south line of Rainbow Trout Park Sub. extended to that line.
No other evidence of corner at all.

OK 1-25-79 GR-SS
3-14-83 GR-SS OK
2-25-88 " " "
7-28-92 JG-B5 OK
4-27-98 3-NEW TIES SSS

CERTIFIED CORRECT:

Anthony B. Kiedrowski
Registered Land Surveyor

DATE: 6/6/74

TIE SKETCH

(Show at least four ties)

