

12 SECTION 18 TOWN 07 RANGE

ADAMS COUNTY

COUNTY CORNER NO: 40

ROMPORTOL ID: 41807122000

PUBLIC LAND SURVEY MONUMENT RECORD

TYPE OF MONUMENT: HARRISON
 ADAMS COUNTY COORDINATES, NAD 83 (2007)

N. 248465.603

E. 588683.311

ELEVATION- DATUM

FIELD WORK DATE: 1/9/2017

BASIS FOR MONUMENT LOCATION

1973 - PLS 878 EXCAVATED AND FOUND STONE THEN MONUMENTED WITH A HARRISON.

2017 - PLS 2994 FOUND HARRISON 10 INCHES BELOW THE ROAD SURFACE, 1 EXISTING TIE AND 1 WITNESS TREE. THE HARRISON AGREES WITH THE EXISTING TIE AND WITNESS TREE. ACCEPTED HARRISON AND SET 3 NEW TIES.

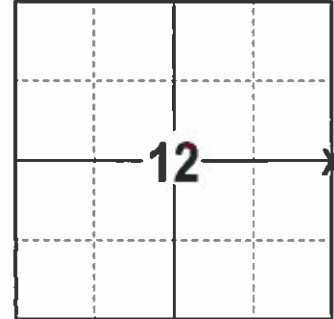

LOCATION
(INDICATE CORNER BY "X")

SEAL:

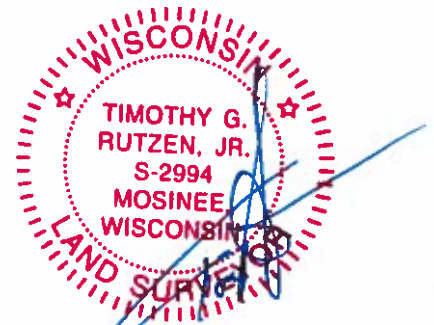

DATA SHOWN HERE ON THIS TIE SHEET IS CORRECT AND COMPLETE TO THE BEST OF MY KNOWLEDGE AND BELIEF.

PROFESSIONAL LAND SURVEYOR

DATE 2/9/17

- TIE SKETCH

NOTE: THE CORNER FALLS 2± WEST OF THE CENTERLINE OF 1ST AVE.

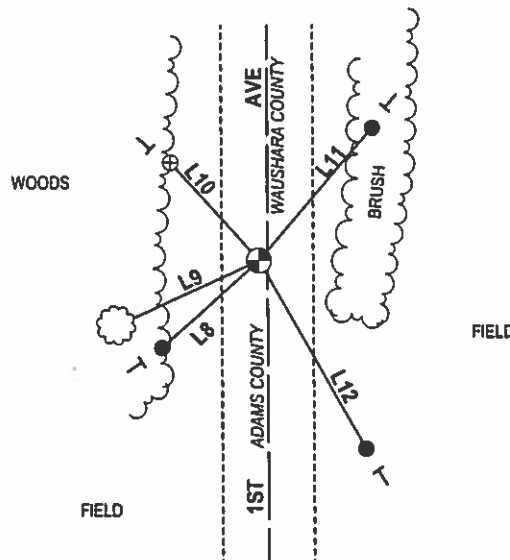
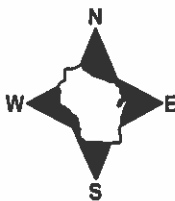

- 3/4" x 18" IRON REBAR SET, 1.50#/FT
- ⊕ 2" OD IRON PIPE WITH CAP FOUND
- ⊙ HARRISON FOUND
- ├ VINYL "T" POST
- ☼ WITNESS TREE FOUND

LINE	BEARING	DISTANCE
L8	S 47°57'54" W	34.01'
L9	S 65°23' W	41.0±'
L10	N 42°13'52" W	34.34'
L11	N 40°39'11" E	45.50'
L12	S 29°57'09" E	56.32'

ADAMS COUNTY

CORNER NO. 262

Survey Monument Record

SECTION 12

TYPE OF MONUMENT: Harrison std.

TOWN 18

STATE PLANE COORDINATES: N _____

RANGE 7

E _____

ELEVATION — M.S.L. DATUM: _____

THETA ANGLE: _____

FIELD BOOK: 108 PAGE 37

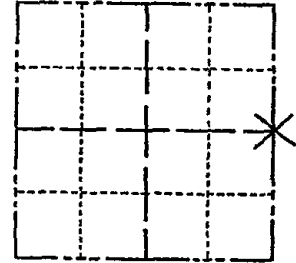

LOCATION
(Indicated by 'X')

SEAL:

BASIS FOR MONUMENT LOCATION

(Use reverse side if necessary)

Show info such as: History of corner, with reference to Vol. and pg, dates, surveyor; exact description of monument replaced; if location computed, by taped or EDM traverse; landowner remarks, etc.



Excavated with backhoe. Found stone; see picture attached. Monumented stone. Traverse of entire section indicates stone correct in location.

- CORNER O.K. 3-28-77 GR-55
 - " " 5-17-82 PK-55
 - " " 3-9-87 CR-55
 - " " 11-26-91 KZ-55
 - " " 1-21-02 JG
- (CHECK WAHSHARA TIE SHEET ALSO)
- OK " " 4-1-07-JG

CERTIFIED CORRECT:

Anthony B. Kiedrowski
Registered Land Surveyor

DATE: April 73

TIE SKETCH

(Show at least four ties)

