

08
SECTION

18
TOWN

07
RANGE

ADAMS COUNTY

COUNTY CORNER NO: 45
ROMPORTOL ID: 41807080000

PUBLIC LAND SURVEY MONUMENT RECORD

TYPE OF MONUMENT: 1-1/2" O.D. IRON PIPE
ADAMS COUNTY COORDINATES, NAD 83 (2007)

N. 245604.340

E. 567471.840

ELEVATION- DATUM

FIELD WORK DATE: 01/08/2020

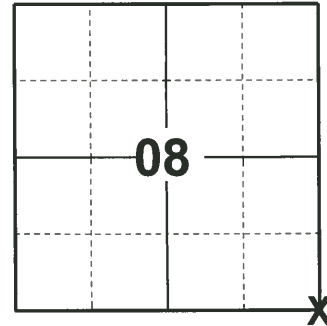

LOCATION
(INDICATE CORNER BY "X")

SEAL:

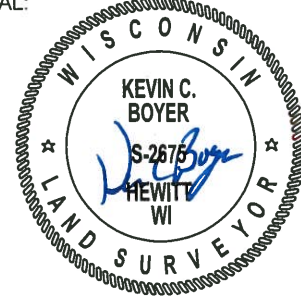

DATA SHOWN HERE ON THIS TIE SHEET IS CORRECT AND COMPLETE TO THE BEST OF MY KNOWLEDGE AND BELIEF.

PROFESSIONAL LAND SURVEYOR

DATE 3/9/2020

1977 - PLS 1245 RAN EDM TRAVERSE AROUND SECTION 16 AND TIED IN ALL EXISTING EVIDENCE. SET HARRISON MONUMENT AT RECORD DISTANCE FROM EAST AND SOUTH.

1978 - PLS 1184 USING EDM TRAVERSE BEGINNING AT THE SE AND SW CORNERS OF SECTION 16, SET BY KIEDROWSKI, AND FOLLOWING THE ORIGINAL SECTION MEASUREMENTS, AS RECORDED IN VOL. 8, PG 18, AND VOL. 3, PG. 6 OF 1901 AND 1925 SURVEY NOTES PLS 1184 LOCATED THE WEST 1/4 POST OF SECTION 17 AND SET A MONUMENT AT THE BASE OF POST. THEN CALCULATED THE LOCATION OF AND SET THE NW CORNER OF SECTION 16.

1983 - PLS 1551 AREA WAS SEARCHED FOR OLD POST, OCCUPATION AND BEARING TREES, NOTING WAS FOUND. PLS 1551 DISAGREED WITH THE MONUMENT SET BY GREEN IN 1978 BECAUSE OF THE LARGE DISCREPANCY IN ORIGINAL MEASUREMENTS FROM THE N1/4 OF SECTION 16, AND THE 1/4 CORNER TO SECTIONS 8 & 9, BOTH OF WHICH WERE RE-ESTABLISHED FROM ORIGINAL BEARING TREE EVIDENCE AND FIT ORIGINAL SURVEY MEASUREMENTS VERY CLOSELY. THE POSITION USED FOR THIS CORNER IS BASED ON PRORATION FROM THE S1/4 OF SECTION 7 AND THE N1/4 OF SECTION 16 FOR E-W POSITION. THE DISTANCE FROM THE NE CORNER OF SECTION 8 WAS DOUBLED THROUGH THE E1/4 OF 8 FOR N-S LOCATION. THIS RESULTS IN A BEND IN THE EAST LINE OF SECTION 8 OF LESS THAN 0°03' AND IS WITHIN 5.2' OF THE ORIGINAL N-S MEASUREMENTS IN SECTION 8. THIS SECTION DIMENSIONS CAN BE FOUND ON SUMMARY SHEETS FILED IN JUNE, 1983.

2020 - PLS 2675 FOUND 1-1/2" O.D. IRON PIPE 18"± ABOVE THE GROUND AND 2 WITNESS TREES. NO EVIDENCE OF THE HARRISON SET BY GREEN WAS RECOVERED. THE MONUMENT AGREES WITH BOTH FOUND WITNESS TREES. ACCEPTED THE 1-1/2" O.D. IRON PIPE AS THE CORNER LOCATION. SET 4 NEW TIES AND MEASURED TO THE EXISTING WITNESS TREES.

TIE SKETCH

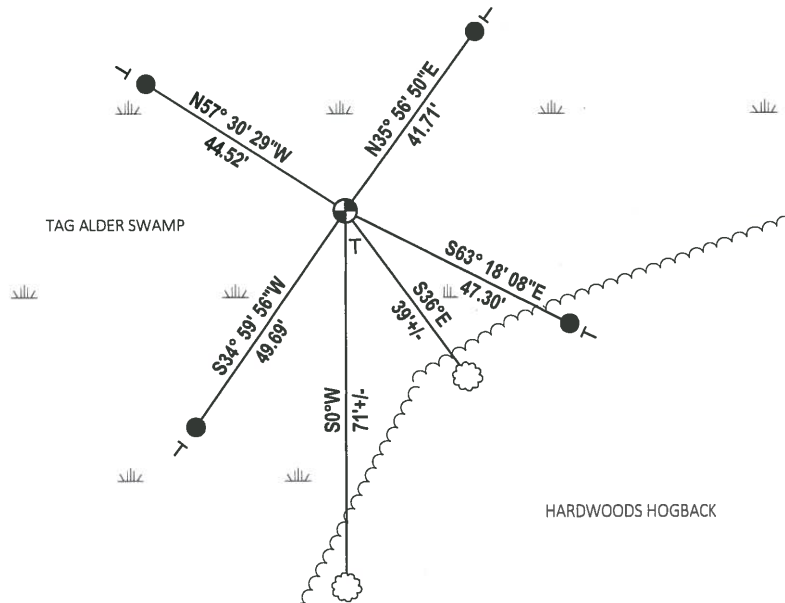
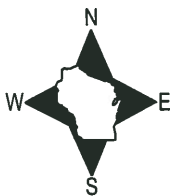

- SET 3/4" x 18" IRON REBAR, 1.50#/FT
- ⊕ FOUND 1-1/2" O.D. IRON PIPE
- ┊ VINYL "T" POST
- ⊗ WITNESS TREE

U.S. PUBLIC LAND SURVEY MONUMENT RECORD

ADAMS COUNTY

TYPE OF MONUMENT: nail / 1 1/2" IP
 STATE PLANE COORDINATES: N _____
 E _____
 ELEVATION — M.S.L. DATUM: _____
 THETA ANGLE: _____
 FIELD BOOK: 1 PAGE 7
 DRAWN BY: D. Riesop

CORNER NO. 45
 SECTION 16
 TOWN 18N
 RANGE 7E

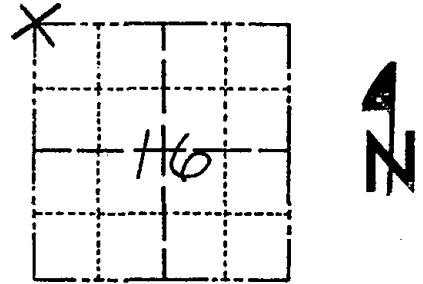

LOCATION
 (Indicated by 'X')

BASIS FOR MONUMENT LOCATION

Show info such as: History of corner, with reference to Vol. and pg., dates, surveyor; exact description of monument replaced; if location computed, by taped or EDM traverse; landowner remarks, etc. (Use reverse side if necessary) (in conformance with Section A-E 502 of the Wisconsin Administrative Code)

Area was searched for old post, occupation and brg. trees, nothing was found.

I disagreed with the monument set by Green in 1978 because of the large discrepancy in original measurements from the N 1/4 of Sec. 16, and the 1/4 corner to Sections 8&9, both of which were reestablished from original bearing tree evidence and fit original survey measurements very closely.

The position I used for this corner is based on proration from the S 1/4 of Sec. 7 and the N 1/4 of Sec. 16 for E-W position. The distance from the NE cor. of Sec. 8 was doubled through the E 1/4 of 8 for N-S location. This results in a bend in the E. line of Sec. 8 of less than 0°03' and is within 5.2' of the original N-S measurements in Sec. 8.

These section dimensions can be found on summary sheets filed in June, 1983.

SEAL:

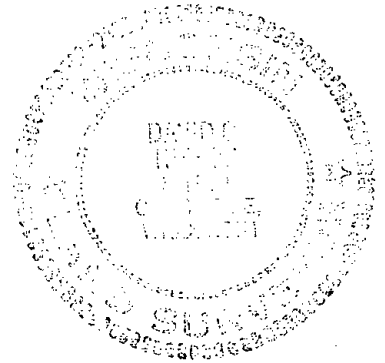

DATA SHOWN HERE ON
 CERTIFIED CORRECT:

David C. Riesop
 Registered Land Surveyor

DATE: 12/28/83

TIE SKETCH

Show at least four ties, also fence lines, roads, topo. size and type of witness trees and if off road - best way to arrive at corner.

SCALE 8" = 40'

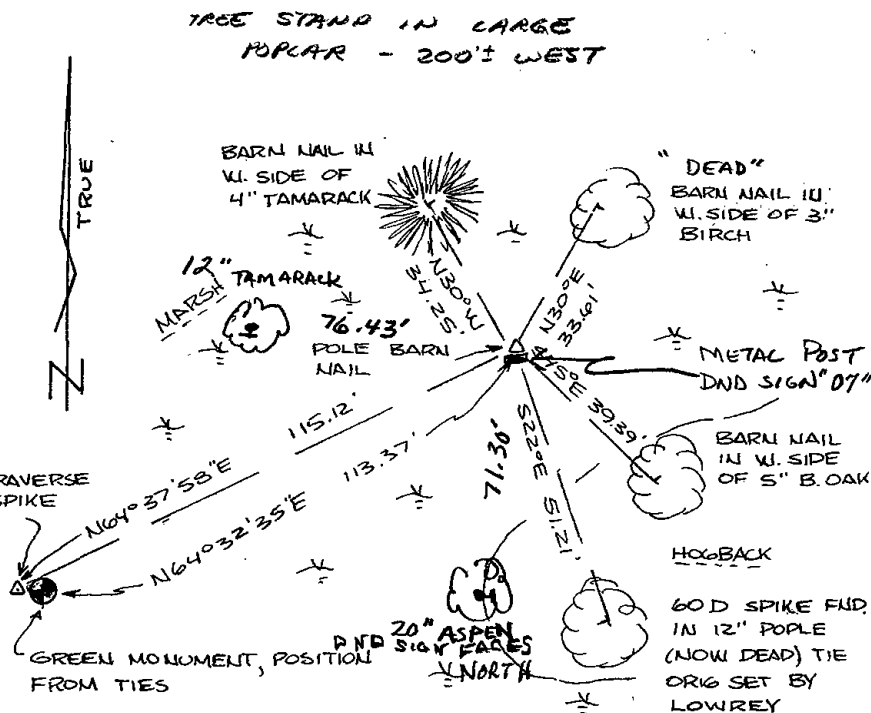

MAINTENANCE RECORD

Date	Init.	Remarks
11-4-87	SS	1 1/2" IP CORNER
10-10-92	JL BS	OK
1-24-02	JG JS	2-NEW, CORNER OK
10-9-07	JG	OK

TRAVERSE SPIKE

GREEN MONUMENT, POSITION FROM TIES

PND 20" ASPEN SIGN FACES NORTH

HOGBACK

60D SPIKE FND IN 12" POPLAR (NOW DEAD) TIE ORIG SET BY LOWREY

1. The first part of the document discusses the importance of maintaining accurate records of all transactions and activities. It emphasizes that this is essential for ensuring transparency and accountability in the organization's operations.

2. The second part of the document outlines the various methods and tools used to collect and analyze data. It highlights the need for consistent data collection procedures and the use of advanced analytical techniques to derive meaningful insights from the data.

3. The third part of the document focuses on the role of technology in data management and analysis. It discusses how modern software solutions can streamline data collection, storage, and analysis processes, thereby improving efficiency and accuracy.

4. The fourth part of the document addresses the challenges associated with data management, such as data quality, security, and privacy. It provides strategies to mitigate these risks and ensure that the organization's data remains reliable and secure.

5. The fifth part of the document concludes by summarizing the key findings and recommendations. It stresses the importance of ongoing monitoring and evaluation to ensure that the data management processes remain effective and aligned with the organization's goals.

Government Land Corner Certificate

ADAMS County
 Harrison Std.
 TYPE OF MONUMENT: _____
 STATE PLANE COORDINATES: N _____
 E _____
 ELEVATION — M.S.L. DATUM: _____
 THETA ANGLE: _____
 FIELD BOOK: _____ PAGE _____
 DRAWN BY: _____

CORNER NO. 45
 SECTION 16
 TOWN T. 18 N.
 RANGE R. 7 E.

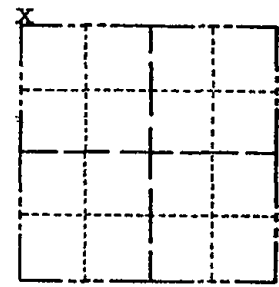

LOCATION
 (Indicated by 'X')

BASIS FOR MONUMENT LOCATION

Show info such as: History of corner, with reference to Vol. and pg., dates, surveyor; exact description of monument replaced; if location computed, by taped or EDM traverse; landowner remarks, etc. (Use reverse side if necessary)

Using an E.D.M. traverse beginning at the SE and SW corners of Section 16, set by Kiedrowski, and following the original section measurements, as recorded in Vol. 8, Page 18 and Vol. 3, Page 6 of 1901 and 1925 survey notes we located the West $\frac{1}{4}$ post of Section 17 and set a monument at the base of post. We then calculated the location of and set the NW corner of Section 16.

SEAL:

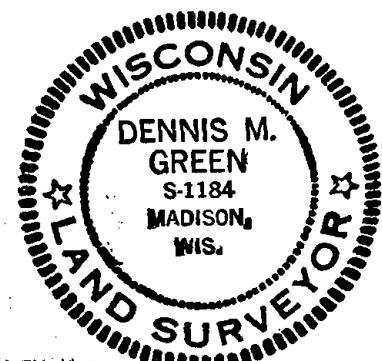

DATA SHOWN HERE ON
 CERTIFIED CORRECT:

Dennis M. Green
 Registered Land Surveyor

DATE: Sept 15, 1978

TIE SKETCH

Show at least four ties, also fence lines, roads, topo, size and type of witness trees' and if off road - best way to arrive at corner.

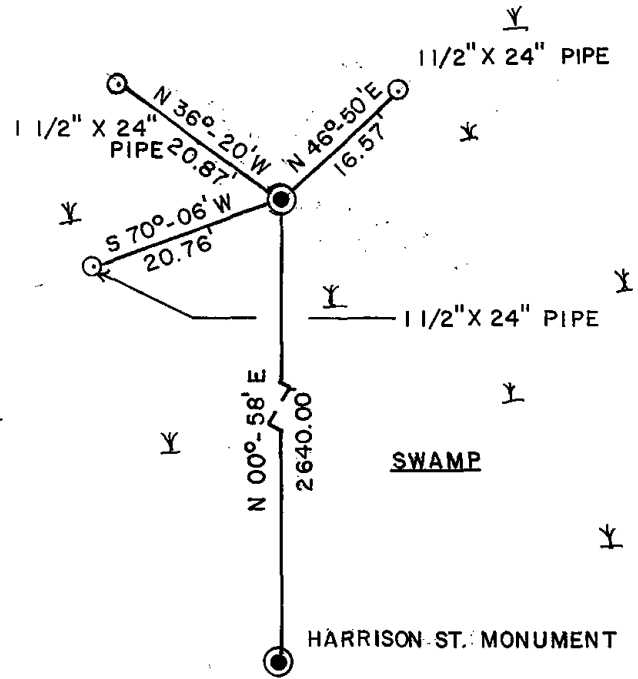

MAINTENANCE RECORD

Date	Init.	Remarks

ADAMS COUNTY

Survey Monument Record

TYPE OF MONUMENT: HARRISON MON.

STATE PLANE COORDINATES: N _____

E _____

ELEVATION — M.S.L. DATUM: _____

THETA ANGLE: _____

FIELD BOOK: _____ PAGE _____

CORNER NO. 45

SECTION 16

TOWN 18

RANGE 7

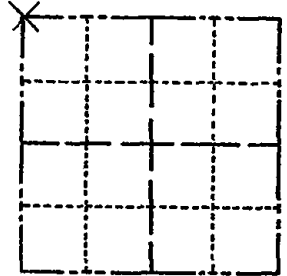

LOCATION
(Indicated by 'X')

SEAL:



BASIS FOR MONUMENT LOCATION

(Use reverse side if necessary)

Show info such as: History of corner, with reference to Vol. and pg, dates, surveyor; exact description of monument replaced; if location computed, by taped or EDM traverse; landowner remarks, etc.

Ran EDM traverse around Section 16 and tied in all existing evidence.

Set Northwest corner at record distance from East and South.

CERTIFIED CORRECT:

James E. Lowrey
Registered Land Surveyor

DATE: July 15, 1977

TIE SKETCH

(Show at least four ties)

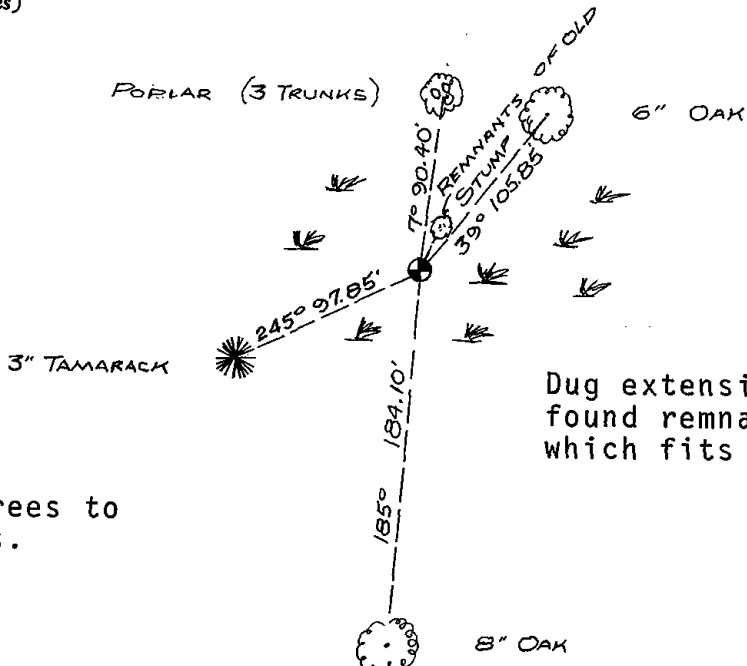

Dug extensive hole and found remnants of old stump which fits original tie.

Note:
Ties in Trees to #60 spikes.

