

33
SECTION

20
TOWN

05
RANGE

ADAMS COUNTY

COUNTY CORNER NO: 126

ROMPORTOL ID: 42005330020

PUBLIC LAND SURVEY MONUMENT RECORD

TYPE OF MONUMENT: HARRISON (BROKEN-TOP)
ADAMS COUNTY COORDINATES, NAD 83 (2007)

N. 287509.111

E. 507086.736

ELEVATION- _____ DATUM _____

FIELD WORK DATE: 02/08/2018

BASIS FOR MONUMENT LOCATION

1980 - PLS 1478 STATES HE SET CORNER FROM THE ROTTED STUMP OF A BLACK OAK BEARING TREE BY M.C. SMITH AS RECORDED IN THE ADAMS COUNTY SURVEYOR RECORDS V. 2, P. 48. THIS FIT EXTREMELY WELL WITH THE STONE FOUND BY A.B. KIEDROWSKI AT THE NE CORNER OF SECTION 4. IT ALSO FIT WELL WITH THE 2" IRON PIPE AT THE NW CORNER OF THE NE1/4 OF THE NW1/4 REFERENCED BY ADAMS COUNTY CERTIFIED SURVEY MAP BY EDMOND NOVAK RLS 561. NO EXCAVATION WAS MADE AT THIS POINT AS THE CORNER FALLS IN THE BOTTOM OF THE NORTH DITCH OF BADGER AVENUE. THIS CORNER DOES NOT FALL ON THE EAST LINE OF PETENWELL HIGHLANDS IN THE NE1/4 OF THE NW1/4. THERE IS NO MENTION OF ANY CORNER USED AT THE N1/4 CORNER FOR THIS PLAT. SET HARRISON AT CALCULATED LOCATION AND TIED OUT.

2018 - PLS 2994 FOUND A HARRISON MONUMENT WITH A BROKEN-TOP 30" BELOW THE ROAD SURFACE, 1 TIE AND 1 PROPERTY IRON. THE MONUMENT AGREES WITH THE EXISTING TIE. ACCEPTED THE HARRISON MONUMENT WITH A BROKEN-TOP AS THE CORNER LOCATION. SET 2 NEW TIES AND MEASURED TO THE TIES AND PROPERTY IRON.

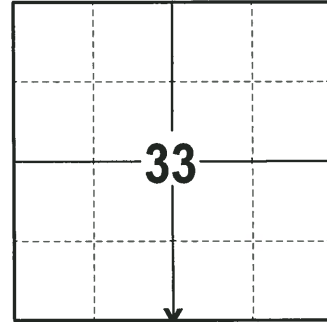

LOCATION
(INDICATE CORNER BY "X")

SEAL:

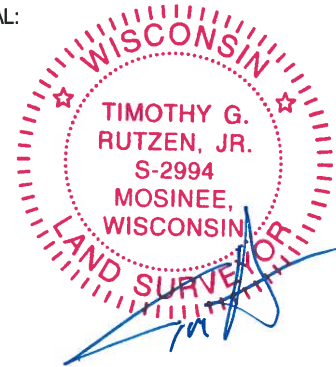

DATA SHOWN HERE ON THIS TIE SHEET IS CORRECT AND COMPLETE TO THE BEST OF MY KNOWLEDGE AND BELIEF.

PROFESSIONAL LAND SURVEYOR

DATE 3-1-18

- TIE SKETCH

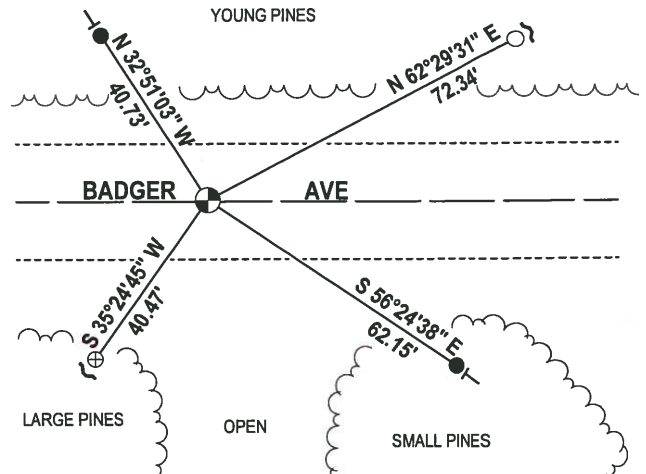
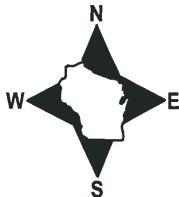

- 3/4" x 18" IRON REBAR SET, 1.50#/FT
- 3/4" IRON ROD FOUND
- ⊕ 2-3/8" O.D. IRON PIPE FOUND
- ⊙ HARRISON (BROKEN-TOP) FOUND
- ↗ STEEL FENCE POST
- ↖ VINYL "T" POST

Government Land Corner Certificate

Adams County

CORNER NO. 6
 SECTION 4
 TOWN 19
 RANGE 5

TYPE OF MONUMENT: Harrison
 STATE PLANE COORDINATES: N _____
 E _____
 ELEVATION — M.S.L. DATUM: _____
 THETA ANGLE: _____
 FIELD BOOK: 78 PAGE 130
 DRAWN BY: G. Rhinehart

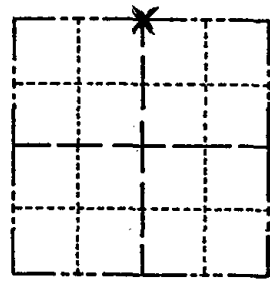

BASIS FOR MONUMENT LOCATION

Show info such as: History of corner, with reference to Vol. and pg., dates, surveyor; exact description of monument replaced; if location computed, by taped or EDM traverse; landowner remarks, etc. (Use reverse side if necessary)

Set corner from the rotted stump of a black oak bearing SEAL: tree by M. C. Smith, as recorded in Adams County Surveyor Records V. 2, p. 48. This fit extremely well with the stone found by A. B. Kiedrowski at the NE corner of Section 4. It also fit well with the 2" iron pipe at the NW corner of the NE $\frac{1}{4}$ of the NW $\frac{1}{4}$ referenced by Adams County Certified Survey Map by Edmond Novak RLS 561. No excavation was made at this point as the corner falls in the bottom of the north ditch of Badger Avenue. This corner does not fall on the east line of Petenwell Highlands in the NE $\frac{1}{4}$ of the NW $\frac{1}{4}$. There is no mention of any corner used at the N $\frac{1}{2}$ corner for this plat.

LOCATION
(Indicated by 'X')



DATA SHOWN HERE ON
CERTIFIED CORRECT:

Gregory P. Rhinehart
Registered Land Surveyor

DATE: April 4, 1980

Ok 4-12-84 DK-SS

12-28-88 SS

OK 1 MARCH 94 CR-JG

OK, 2-8-99-JG-SS

2-GONE, 2-NEW, 1-15-04, JG-JS

TIE SKETCH

Show at least four ties, also fence lines, roads, topo, size and type of witness trees and if off road - best way to arrive at corner.

