

ADAMS COUNTY

Survey Monument Record

TYPE OF MONUMENT: Harrison

STATE PLANE COORDINATES: N _____

E _____

ELEVATION — M.S.L. DATUM: _____

THETA ANGLE: _____

FIELD BOOK: FILE PAGE _____

CORNER NO. 956

SECTION 7

TOWN 19

RANGE 6

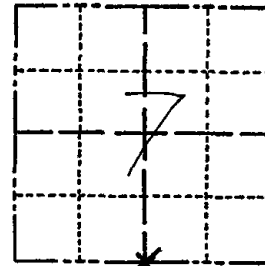

LOCATION
(Indicated by 'X')

SEAL:



BASIS FOR MONUMENT LOCATION

(Use reverse side if necessary)

Show info such as: History of corner, with reference to Vol. and pg, dates, surveyor; exact description of monument replaced; if location computed, by taped or EDM traverse; landowner remarks, etc.

Ran EDM/transit traverse around Section 7 and the adjacent sections to determine the search area for investigation.

Excavation with backhoe yielded no evidence of the original corner or any remonumentation. Could find no record of the 1" iron pipe on the South side of Bighorn Avenue, being on Quarter line.

Set corner on line between the adjacent section corners and proportional to the original notes.

- OK 11-27-78 RN-DA
- 3-11-83 GR-SS OK
- 2-1-88 GR-SS OK
- 1-GONE, 1-NEW TIE 1-4-93 JG-BS
- 2-GONE, 2-NEW, MON. OK 2-11-98-JG

CERTIFIED CORRECT:

Dale C. Hagen

Registered Land Surveyor

DATE: January 27, 1976

TIE SKETCH

1-GONE, 4-LEFT, 12-30-02-JG

(Show at least four ties)

NOTE:

Ties in trees to nail in disc.

SEE REVERSE FOR ADDITIONAL

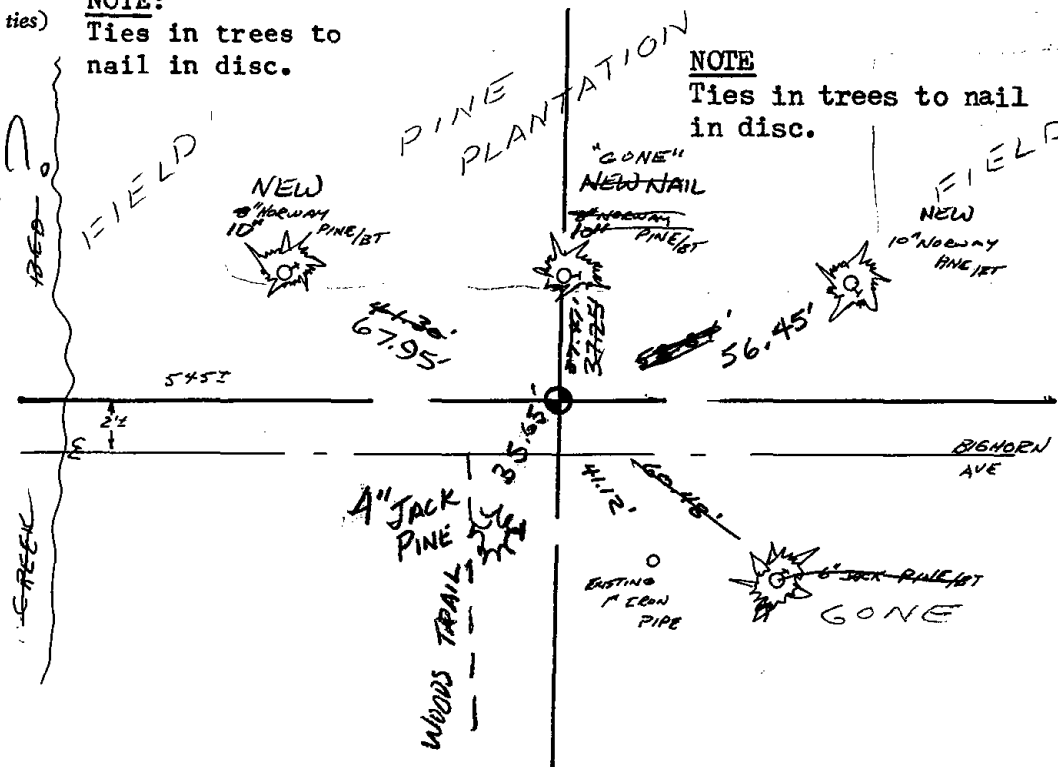

NOTE

Ties in trees to nail in disc.



8-13-08 KS-SS

TRAIL
ISS WEST

'08
3/4" x 19" ROD/STEEL
POST

36.32

TWIN 6"
BIK OAK '08

43.85



40.5'

3" IRON PIPE
GATE POST
36 TALL
MEASURED AT
TOP OF OUTSIDE
SOUTHWEST EDGE

41.12

FO EXIST. 1" IRON
PIPE

11111
111
1111