

21
SECTION

20
TOWN

06
RANGE

ADAMS COUNTY

COUNTY CORNER NO: 86

ROMPORTOL ID: 42006210020

PUBLIC LAND SURVEY MONUMENT RECORD

TYPE OF MONUMENT: HARRISON
ADAMS COUNTY COORDINATES, NAD 83 (2007)

N. 298206.528

E. 538506.815

ELEVATION- - - - - DATUM - - - - -

FIELD WORK DATE: 05/17/2018

BASIS FOR MONUMENT LOCATION

1974 - PLS 1103 RAN E.D.M. TRAVERSE OF SECTION 28. EXCAVATION WITH A BACKHOE AT THE CORNER YIELDED NO EVIDENCE AS TO THE ORIGINAL LOCATION OF THE CORNER. MONUMENTED WITH A HARRISON BASED ON THE ORIGINAL NOTES AND TIED OUT.

2018 - PLS 2994 FOUND A HARRISON MONUMENT FLUSH WITH THE GROUND SURFACE. FOUND NO EVIDENCE OF ANY OF THE WITNESSES. ACCEPTED THE HARRISON MONUMENT AS THE BEST EVIDENCE OF THE CORNER LOCATION. SET 4 NEW TIES AND MEASURED TO THE TIES.

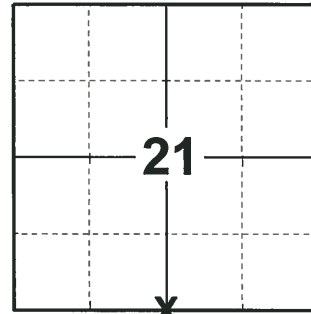

LOCATION

(INDICATE CORNER BY "X")

SEAL:

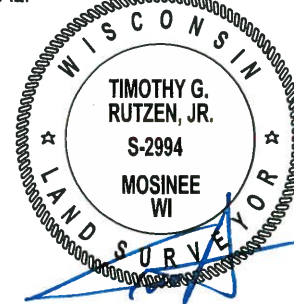

DATA SHOWN HERE ON THIS TIE SHEET IS CORRECT AND COMPLETE TO THE BEST OF MY KNOWLEDGE AND BELIEF.

PROFESSIONAL LAND SURVEYOR

DATE 7-18-18

TIE SKETCH

NOTE: THE CORNER FALLS 9± EAST OF THE CENTERLINE OF THE NORTH-SOUTH TRAIL AND 17± NORTH OF THE CENTERLINE OF THE NORTHEAST TRAIL.

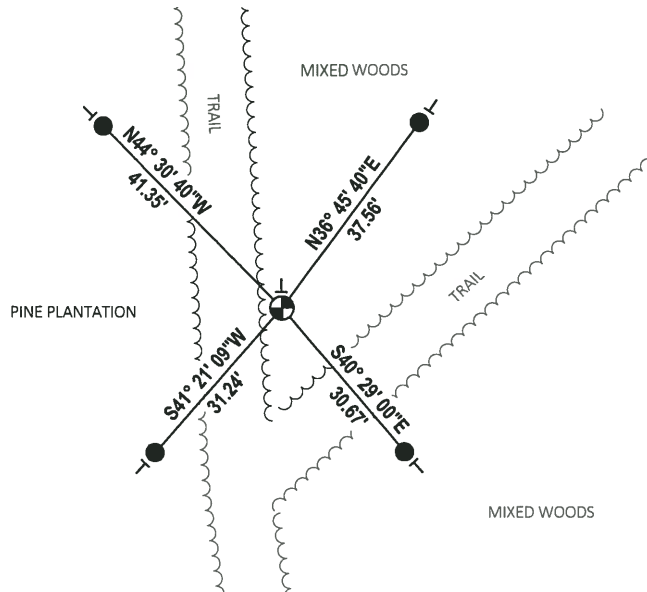
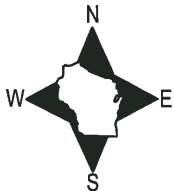

- SET 3/4" x 18" IRON REBAR, 1.50#/FT
- ⊕ FOUND HARRISON MONUMENT
- VINYL "T" POST

ADAMS COUNTY

Survey Monument Record

TYPE OF MONUMENT: Standard Harrison

STATE PLANE COORDINATES: N _____
E _____

ELEVATION — M.S.L. DATUM: _____

THETA ANGLE: _____

FIELD BOOK: 111 PAGE 12

CORNER NO. 380

SECTION 28

TOWN 20

RANGE 6 E

86

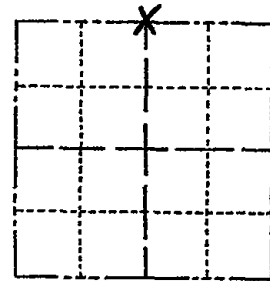

LOCATION
(Indicated by 'X')

SEAL:

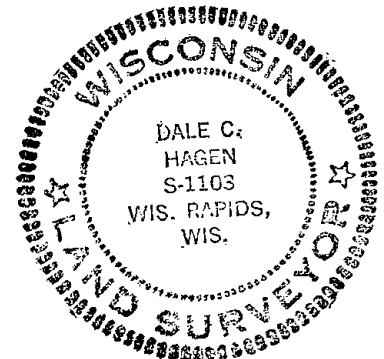

BASIS FOR MONUMENT LOCATION

(Use reverse side if necessary)

Show info such as: History of corner, with reference to Vol. and pg, dates, surveyor; exact description of monument replaced; if location computed, by taped or EDM traverse; landowner remarks, etc.

Ran EDM Traverse of Section 28. Excavation with backhoe at North quarter corner yielded no evidence as to original location of corner. Remonumented using original notes.

Z NEW TIES - 5-8-89 CORNER HAS BRICKS AROUND IT & STEEL POST

OK 3-8-94

OK, 3-4-99 - JG-SS

OK, 3-17-04 - JG OK 2-20-09 55

OK 7-13-79 RW-RW

1 gone 1 new 7-17-84 DK-MK

CERTIFIED CORRECT:

Dale C. Hagen
Registered Land Surveyor

DATE: May 2, 1974

TIE SKETCH

(Show at least four ties)

All ties to nail and disc.

